

City line reach & clean



**PHILIPS**



ENGLISH 4

繁體中文 14

한국어 24

## Important

- ▶ Only use Philips s-bag™ double-layer paper dustbags (FC8021) or Philips Sydney+ double-layer paper dustbags (type HR6999).
- ▶ Check if the dustbag has been placed correctly.
- ▶ Never use the vacuum cleaner to suck up water or any other liquid. Never pick up ashes until they are cold.
- ▶ When the vacuum cleaner is used to suck up fine dust, the pores of the dustbag may become clogged, causing the passage of air through the dustbag to become obstructed. As a result, the dustbag-full indicator will indicate that the dustbag needs to be replaced, even though the dustbag is not full at all.
- ▶ Never use the appliance without the Motor Protection Filter. This could damage the motor and shorten the life of the appliance.
- ▶ The infrared remote control on the handgrip contains electronic components (specific types only).

To avoid defects, never clean this part with water.

## Connecting accessories

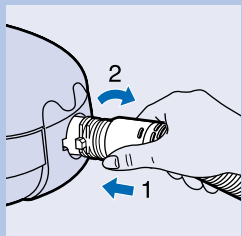

- ▶ To connect the hose to the appliance, push it into the appliance and turn it clockwise.

To disconnect the hose from the appliance, turn it anticlockwise and pull it out of the appliance.

## Button coupling or Active coupling (specific types only)

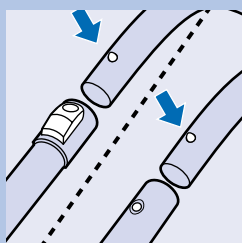

- 1 Connect the tube to the handgrip by pressing the spring-loaded lock button on the handgrip and inserting the handgrip into the tube. Fit the spring-loaded lock button into the opening in the tube ("click").

- ▶ To disconnect the tube from the handgrip, press the spring-loaded lock button and pull the handgrip out of the tube.
- ▶ Use the same method to connect and disconnect the other accessories.

## Telescopic tube

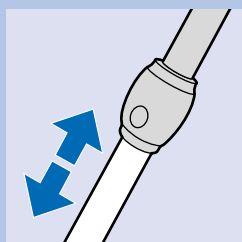

- ▶ Adjust the tube to the length you find most comfortable during vacuum cleaning.

## Reach & Clean nozzle

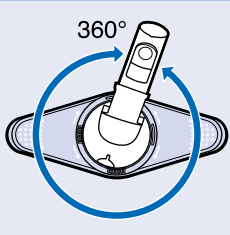

- The Reach & Clean nozzle can be used on either carpets or hard floors. The nozzle can be put in 4 different positions, allowing you to also vacuum clean hard-to-reach places in an easy way. The nozzle can be turned 360 degrees clockwise as well as anti-clockwise.

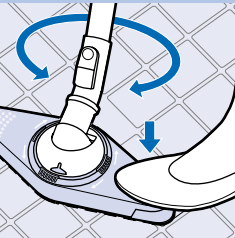

- To adjust the nozzle to the type of floor and the area to be cleaned, put your foot on the indicated positions and then turn the tube until the nozzle is in the required position.

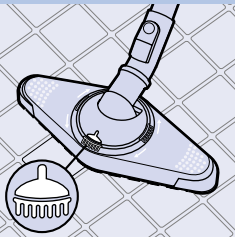

- With the nozzle positioned breadthwise and the brush strip folded out, you can clean large hard floor areas. Turn the nozzle until the brush strip pops out of the nozzle housing and the nozzle is positioned breadthwise.

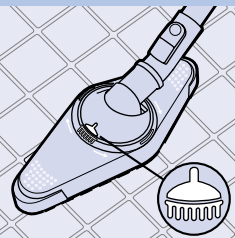

- With the nozzle positioned lengthwise and the brush strip folded out, you can vacuum clean small hard floor areas. Turn the nozzle 90 degrees clockwise until it is positioned lengthwise with the brush strip still folded out of the nozzle housing.

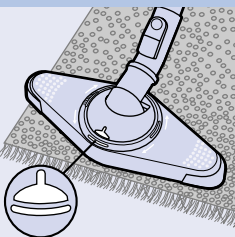

- With the nozzle positioned breadthwise and the brush strip folded in, you can vacuum clean large soft floor areas. Turn the nozzle 90 degrees clockwise again to position the nozzle breadthwise and to make the brush strip disappear into the nozzle housing.

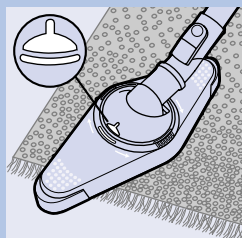

- 4 With the nozzle positioned lengthwise and the brush strip folded in, you can vacuum clean small soft floor areas. Turn the nozzle 90 degrees clockwise again until it is positioned lengthwise with the brush strip still folded in.

### Crevice nozzle, brush nozzle and small nozzle

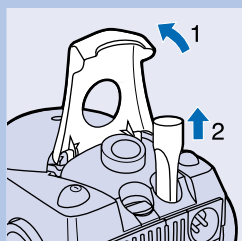

The crevice nozzle can be used either for cleaning narrow corners or hard-to-reach places.

- 1 Lift the handle on the vacuum cleaner to gain access to the accessory storage compartment.
- 2 Connect the crevice nozzle to the tube or directly to the handgrip.
- 3 The brush nozzle can be used for cleaning computers, bookshelves etc.

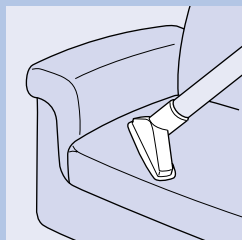
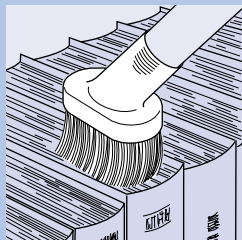

- 4 The small nozzle can be used for vacuum cleaning small areas, e.g. the seats of chairs and sofas.

### Vacuum cleaning

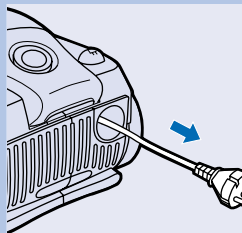

- 1 Pull the cord out of the appliance and put the mains plug in the wall socket.

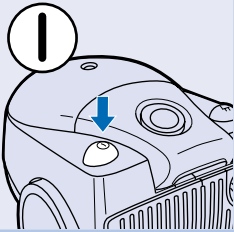

- 2** Switch the appliance on by pushing the on/off button on top of the appliance with your foot.

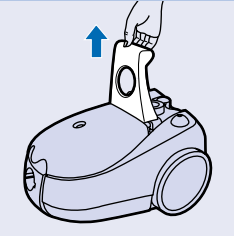

- 3** To carry the appliance, put the handle in upright position and lift the appliance by the handle.

### Adjusting suction power

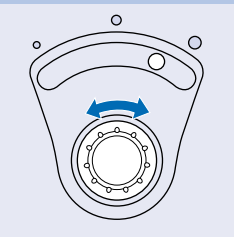

You can adjust the suction power during vacuum cleaning:

- 1** Adjust the suction power by means of the electronic suction power control (specific types only).

### Infrared remote control (specific types only)

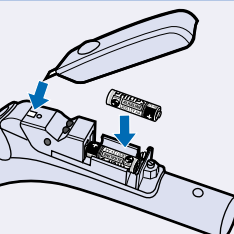

- 1** Place the batteries in the battery compartment.

Make sure the - and + poles are pointing in the right direction.

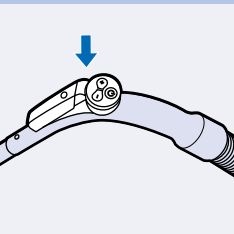

- 2** With the infrared remote control you can set the suction power to one of 5 different suction power settings. When you switch the appliance on, it will always start running at the highest suction power setting.

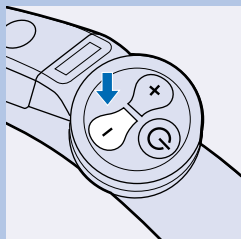

- 3** By pushing the - button, you will reduce the suction power by one setting.

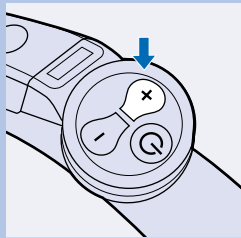

- 4** By pushing the + button, you will increase the suction power by one setting.

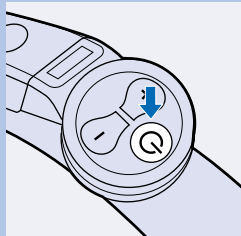

- 5** Push the standby button to temporarily switch the vacuum cleaner off, for instance when you have to move some furniture.
- 6** To continue vacuum cleaning, simply press the - button or the + button. The appliance will start operating at the previously selected suction power setting again.

## Storage

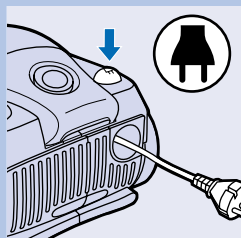

- 1** Switch the appliance off.
- 2** Remove the mains plug from the wall socket.
- 3** Rewind the mains cord by pressing the cord rewind button.

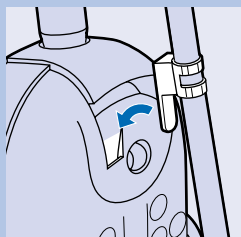

- 4** Put the appliance in upright position and attach the lower tube to the appliance by means of the clip.
- The height of the clip can be adjusted by sliding it along the tube.

## Replacing the dustbag

- Replace the dustbag as soon as the "dustbag-full indicator" changes colour (when the nozzle is not placed on the floor).

**1** Switch the appliance off.

**2** Open the cover.

**3** Push the dustbag holder backwards.

**4** Remove the full dustbag from the holder by pulling the cardboard tag.

When you do this, the dustbag will be automatically sealed.

**5** Slide the cardboard front of the new dustbag into the two grooves of the dustbag holder. Press it down as far as possible.

**6** Pull the dustbag holder forwards (you will hear a click).  
You cannot close the cover if no dustbag has been inserted.

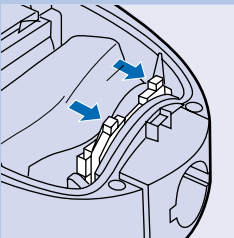
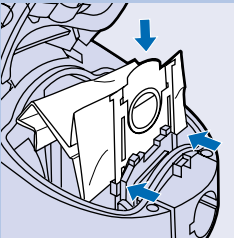
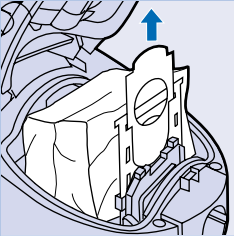
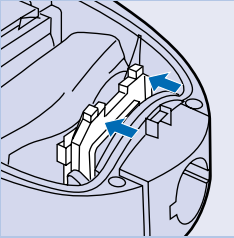
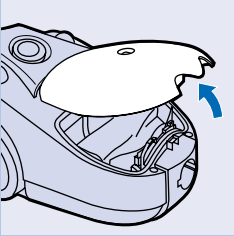

## Replacing filters

### Motor Protection Filter

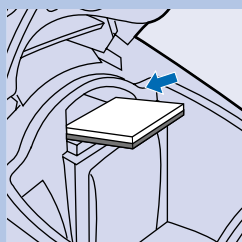

- 1** Replace the Motor Protection Filter when you insert the first of a new set of dustbags or once a year.
- 2** Insert the filter into the appliance with the white side facing upwards.

### AFS Micro Filter

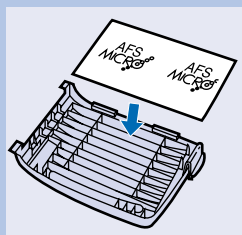

The AFS Micro Filter in this appliance will remove a large part of the smallest particles from the exhaust air by means of its electrostatically charged fibres.

- 1** Replace the AFS Micro Filter when you insert the first of a new set of dustbags or once a year.
- 2** Place the sides and the bottom edge of the new filter properly behind the ridges of the holder.
- 3** Make sure the filter has been properly inserted into the holder before you close the filter holder.

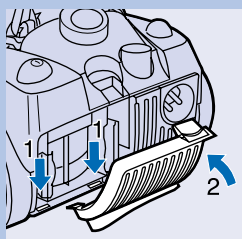

### HEPA Filter (specific types only)

Some appliances are equipped with an HEPA Filter. This filter not only removes household dust, but also harmful microscopic vermin.

- 1** Replace the HEPA Filter at least once a year.
- 2** Open the filter grille.

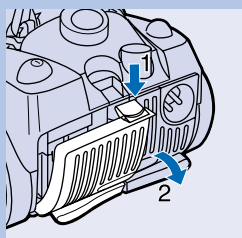

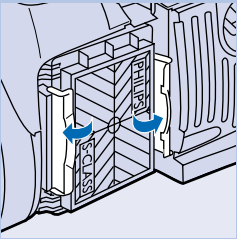

- 3** Push both catches sideward and remove the filter.

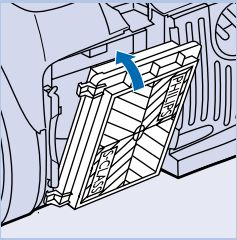

- 4** Place the new filter with its white side pointing towards the appliance. Make sure that the Philips logo on the filter is visible and in the upper right-hand corner.

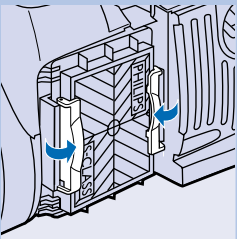

- 5** Secure the filter by pushing the catches home and close the filter grille.

## Ordering dustbags and filters

Philips s-bag™ paper dustbags are available under type number FC8021 (service number 4822 480 10113).

The recommended dustbags fit a variety of Philips vacuum cleaners. For compact vacuum cleaners like the City Line or the Impact, this means that the dustbags will not be filled to their maximum capacity, as the capacity of the dust compartment is smaller than that of the dustbag. However, this does not prevent your vacuum cleaner from functioning optimally.

Two AFS Micro Filters and one Motor Protection Filter are available under type number FC8032 (service number 4822 015 70056).

HEPA Filters are available under type number HR6992 (service number 4822 480 10084).

If you have any difficulties obtaining dustbags, filters or other accessories for this appliance, please contact the Philips Helpdesk.

See the worldwide guarantee leaflet for telephone numbers of the Philips Helpdesk.

## Environment

To make recycling possible, the plastics used for this appliance have been coded.

The cardboard packaging has been made of recycled material and is fully recyclable.

Remove the batteries when you discard the appliance. Do not throw the batteries away with the normal household waste, but hand them in at an official collection point. You can also take the batteries to a Philips service centre, which will dispose of them in an environmentally safe way.

## Replacing the mains cord

If the mains cord of this appliance is damaged, it must always be replaced by Philips or a service centre authorised by Philips, as special tools and/or parts are required.

## Solving problems

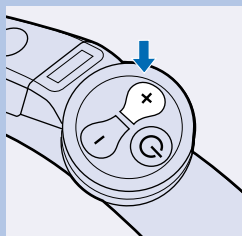

► The suction power is insufficient:

- 1** Adjust the suction power by pushing the + button of the remote control (specific types only).
- 2** Set the electronic suction power to a higher setting (specific types only).
- 3** Check if the dustbag needs to be replaced.
- 4** Check if the filters need to be replaced.
- 5** Check if the nozzle, tube or hose is blocked up.
- 6** To remove the obstruction, disconnect the blocked-up item and connect it (as far as possible) in reverse position. Switch the vacuum cleaner on to make the airflow suck the obstructing material out of the blocked-up item.

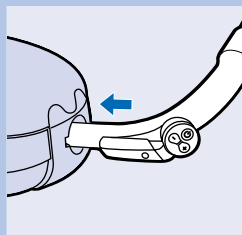
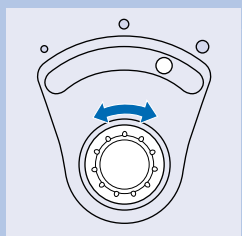

► The infrared remote control does not function:

- 7** It is possible that the batteries are not making proper contact.

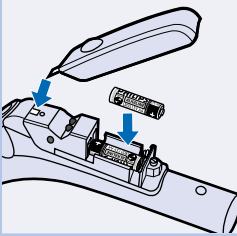

**8** Remove the lid of the battery compartment and push the batteries back into place.

**9** The batteries are empty.

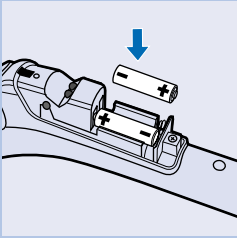

**10** Replace the batteries (make sure the - and the + poles of the new batteries are pointing in the right direction). Use LR03 batteries, preferably alkaline batteries.

## 注意

- ▶ 只能使用飛利浦 s-bag™；雙層紙製集塵袋(FC8021)、或飛利浦 Sydney+ 雙層紙製集塵袋(型號 HR6999)。
- ▶ 檢查集塵袋是否已經正確裝妥。
- ▶ 請勿使用吸塵器來吸水或任何其他液體。請勿吸入尚未冷卻的灰燼。
- ▶ 若使用吸塵器來吸取極細的灰塵，集塵袋的通道氣孔可能會阻塞。這將會使"集塵袋已滿"指示器顯示集塵袋已滿、需要更換，即使集塵袋並沒有裝滿。
- ▶ 請勿在未裝設馬達保護濾網的情況下使用吸塵器。這將會使馬達受損，並縮短吸塵器的使用壽命。
- ▶ 握把上的紅外線遙控裝置內含有電子元件(僅限於特定機型)。為避免損壞，請不要用水清洗該部位。

## 連接配件

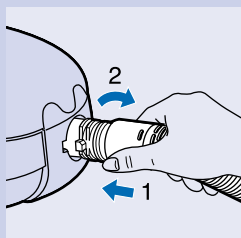

- ▶ 要將軟管裝到吸塵器上時，請將管端插入吸塵器的孔中，並順時針方向轉動。
- ▶ 要將軟管從吸塵器上拆下時，請將管端逆時針方向轉動，並拉出軟管。

## 按鈕連結和啟動連結 (僅限於特定機型)

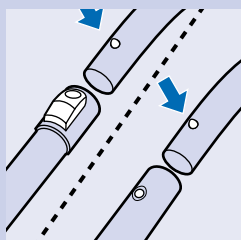

- 1 按下握把上的彈簧式鎖定鈕，並將握把插入硬管中，即可將硬管連接到握把上。將彈簧式鎖定鈕卡入硬管上的開孔中(聽到喀噠一聲)。
- ▶ 要將硬管與握把分離時，請按下彈簧式鎖定鈕並將握把從硬管中拉出。
  - ▶ 請利用相同的方法來連接及拆開其他配件。

## 伸縮式吸管

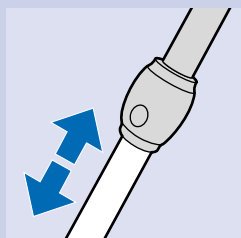

- ▶ 將硬管調整到您在工作中感覺到最舒適的長度。

## 多用途吸頭

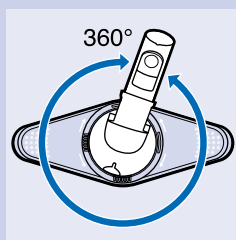

- 多用途吸頭可以用在地毯或硬式地板上。吸頭可以調整成4個不同的角度，讓您可以以任何方式來清潔難以清理的地方。吸頭可以順時針方向轉動360度，也可以逆時針方向轉動360度。

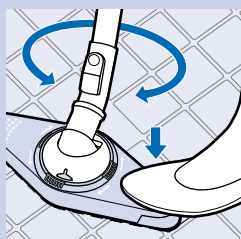

- 要根據地板的類型及要清潔的部位來調整吸頭時，請用腳踩住圖示的位置，然後轉動硬管直到吸頭呈現您所需的角度為止。

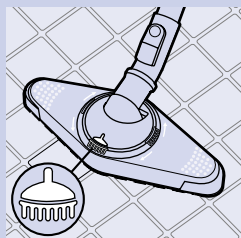

- 1 將吸頭橫向平放並使刷條外翻，您可以清潔大面積的硬式地板。請轉動吸頭直到刷條從吸頭外殼伸出，且吸頭呈橫向平放的位置。

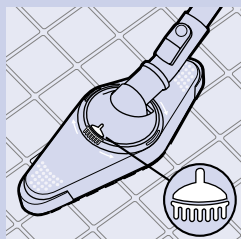

- 2 將吸頭直放並使刷條外翻，您可以清潔小面積的硬式地板。請將吸頭順時針方向轉動90度，直到吸頭呈直放角度，且刷條外翻為止。

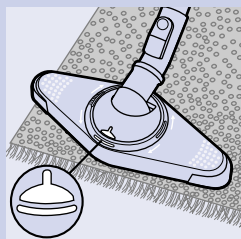

- 3 將吸頭平放並使刷條內翻，您可以清潔大面積的軟式地板。請將吸頭再次順時針方向轉動90度，使吸頭呈平放角度，並使刷條沒入吸頭外殼中。

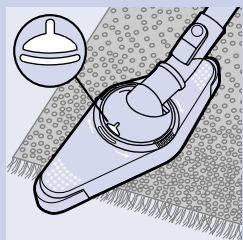

- 4** 將吸頭直放並使刷條內翻，您可以清潔小面積的軟式地板。請將吸頭再次順時針方向轉動90度，使吸頭呈直放角度，且刷條仍保持內翻。

### 縫隙吸頭、毛刷吸頭、及小型吸頭

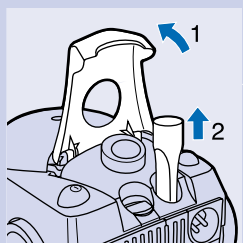

縫隙吸頭可以用來清潔狹窄角落或難以清理的位置。

- 1** 提起吸塵器上的握把，便可見內鍵式附件收藏格。
- 2** 將縫隙吸頭連接到吸管上或直接連接到握把上。



- 3** 毛刷吸頭可以用來清潔電腦、書架...等等。

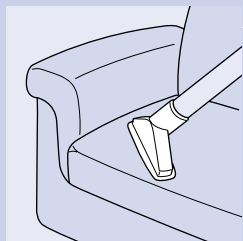

- 4** 小型吸頭可以用來進行小面積的清潔，例如椅墊及沙發。

### 使用吸塵器

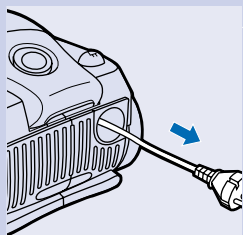

- 1** 將電線從吸塵器中拉出，並將插頭插入電源插座中。

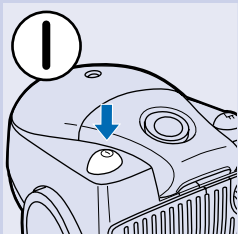

- 2** 用腳壓下吸塵器頂部的ON/OFF按鈕來開啓電源。

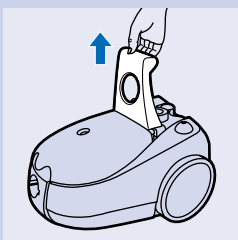

- 3** 要提起吸塵器時，請將把手放在直立位置，並利用把手提起吸塵器。

## 調整吸力

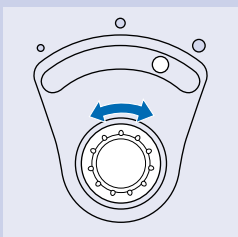

在進行清潔時，您可以調整吸塵器的吸力。

- 1** 請利用電子吸力控制開關來調整吸塵器的吸力(僅限於特定機型)。

## 紅外線控制(僅限於特定機型)

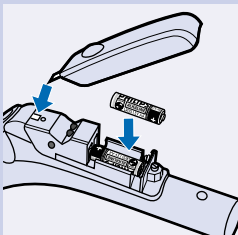

- 1** 將電池置入電池盒內。

請確認電池的-和+極性沒有裝反。

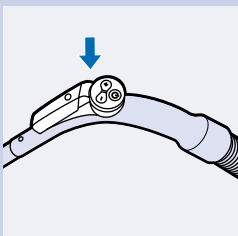

- 2** 利用紅外線遙控裝置，您可以將吸塵器的吸力調整到5個不同的設定。每次在您開啓吸塵器的電源時，它都會以最大吸力的設定開始運轉。

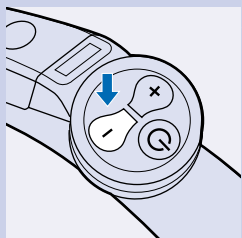

**3** 按下-按鈕，您可以每次降低一格吸力。

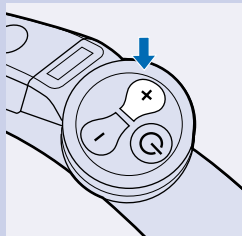

**4** 按下+按鈕，您可以每次升高一格吸力。

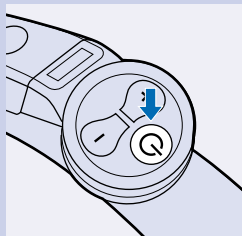

**5** 按下待機(Standby) 鈕可以暫時關閉吸塵器，例如在您必須搬動某些家具時。

**6** 要繼續進行清潔時，只需要按下-或+鈕即可。吸塵器會再度以以前的吸力設定開始作用。

## 收存

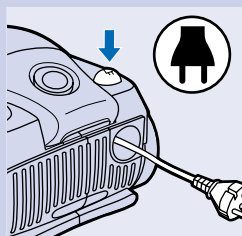

**1** 將吸塵器的電源關閉。

**2** 將電源插頭從插座中拔出。

**3** 按下電源線回捲鈕將電源線回捲到吸塵器中。

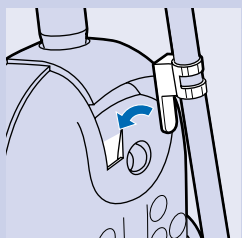

**4** 將吸塵器直立起來並利用夾子將下側吸管裝在吸塵器上。

夾子的高度可以沿著吸管滑動來進行調整。

## 更換集塵袋

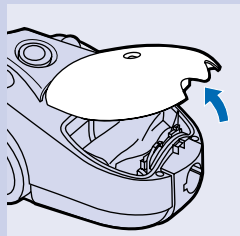

在"集塵袋已滿"指示器的顏色改變時(吸頭沒有貼緊地板的情況下)，請立即更換集塵袋。

**1** 將吸塵器的電源關閉。

**2** 打開上蓋。

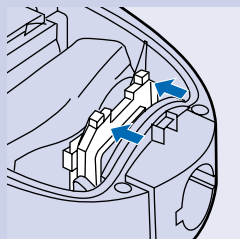

**3** 將集塵袋固定架向後推。

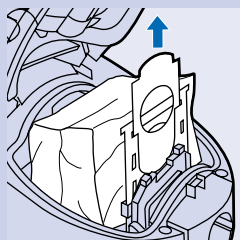

**4** 拉起紙板片將裝滿灰塵的集塵袋拉出。  
在您拆下集塵袋時，集塵袋會自動封閉。

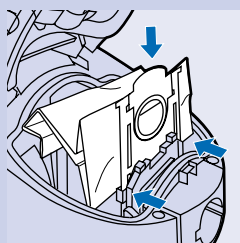

**5** 將新的集塵袋的紙板片套入集塵袋固定架上的狹槽中。

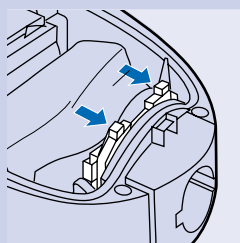

**6** 將固定架向前推(您會聽見喀噠一聲)。  
如果沒有裝入集塵袋，您將無法關閉上蓋。

## 更換濾網

## 馬達保護濾網

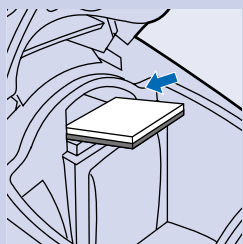

- 1** 請在您更換新一套集塵袋中的第一個集塵袋時更換馬達保護濾網，或者每年更換一次。
- 2** 將濾網白色的一面朝上。

## AFS 微塵過濾網

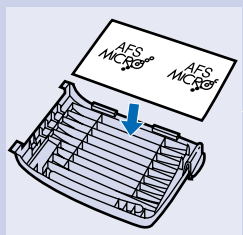

吸塵器中的AFS 微塵過濾網，可以利用它的靜電纖維，將排在空氣中大部分的小微粒濾除掉。

- 1** 請在您更換新一套集塵袋中的第一個集塵袋時更換AFS 微塵過濾網，或者每年更換一次。
- 2** 請將新濾網的兩側置於固定架的正後方。
- 3** 在您關閉濾網的固定器之前，請確定濾網已經正確裝入固定架中。

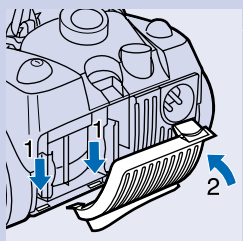

## HEPA濾芯(僅限於特定機型)。

某些吸塵器機型配備有HEPA濾芯。這個濾芯不只可以過濾家中的灰塵，也可以過濾有害的微小害蟲。

- 1** HEPA濾芯至少應每年更換一次。
- 2** 打開濾芯格架。

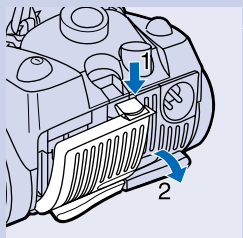

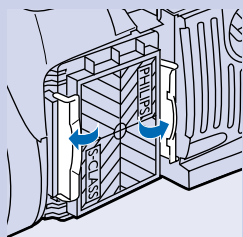

- 3** 將兩側的把手向兩側撐開並取出濾芯。

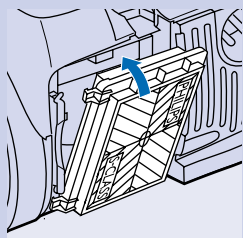

- 4** 將新的濾芯白色的一面朝向吸塵器前方裝入，請確定可以在右上角位置看見濾芯上的飛利浦商標。

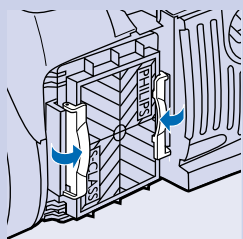

- 5** 將濾芯兩側的把手壓回原位予以固定，並關閉濾芯格架。

### 訂購集塵袋及濾網(芯)

飛利浦s-bag™：FC8021機型有雙層紙製集塵袋可供選用(零件號碼為4822 480 10113)。

建議的集塵袋適用於各種飛利浦吸塵器。在小型吸塵器方面(如City Line或Impact)，這種集塵袋無法發揮最大的容量功效，因為它的集塵室的容積比集塵袋小。但這並不妨礙吸塵器發揮正常的功能。

FC8032機型有2種AFS 微塵濾網及1種馬達保護濾網可供選用(零件號碼4822 015 70056)。

HR6992機型有HEPA濾芯可供使用(零件號碼4822 480 10084)。

如果您在購買集塵袋、濾網、或其他配件有任何困難，請洽詢飛利浦服務處。

飛利浦服務處的電話號碼請參閱"全球保證書"。

## 環保

爲了方便回收，本吸塵器所使用的塑膠都已經加以編碼。

包裝紙箱也由再生材料製成，可以完全回收。

當您要拋棄本吸塵器時，請先拆下電池。不要將電池與一般家庭廢棄物一起丟棄，請將它送到合法的回收點。您也可以將它交給飛利浦服務中心，他們會以不會破壞環境的方法進行處理。

## 更換電源線

如果本吸塵器的電源線損壞，必須由飛利浦或者飛利浦授權的服務中心進行更換，因爲這需要特殊的工具及/或零件。

## 故障排除

### ● 吸力不足

- 1** 按下遙控裝置的+按鈕來調整吸力(僅限於特定機型)。
- 2** 將電子吸力控制開關設定在最大吸力的位置(僅限於特定機型)。
- 3** 檢查是否需要更換集塵袋。
- 4** 檢查是否需要更換濾網。
- 5** 檢查吸頭、硬管、或軟管是否有阻塞。
- 6** 要清除阻塞物，請將阻塞的部份拆下，並將它以相反方向連接(盡可能離的遠一些)。開啓吸塵器讓氣流將阻塞物從阻塞的部位吸出。
- 紅外線遙控裝置沒有作用。
- 7** 可能是電池沒有正確接觸。

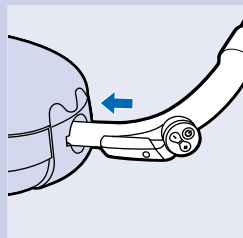
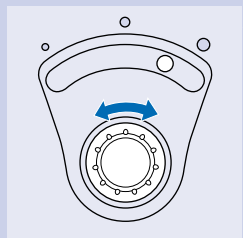
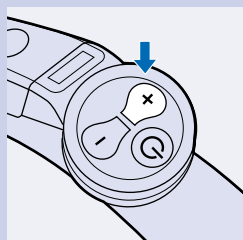

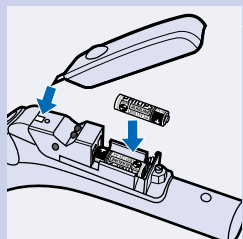

**8** 拆下電池室蓋板並將電池壓回正確位置。

**9** 電池沒電。

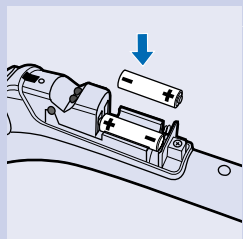

**10** 更換電池(請確定新電池得+/-極朝向正確的方向)。請使用LR03電池，最好是鹼性電池。

## 중요사항

- ▶ 본 제품에는 반드시 필립스 s-bag™ 2중 먼지봉투(모델명 FC8021)나 필립스 시드니+ 2중 먼지봉투(모델명 HR6999 Sydney+)만 사용하십시오.
- ▶ 먼지봉투가 올바르게 조립되어 있는지 확인하십시오.
- ▶ 진공청소기로 물이나 기타 액체를 흡입하지 마십시오. 타다 남은 재는 식은 후에 흡입하십시오.
- ▶ 진공청소기로 미세먼지(분말종류)를 흡입하면 먼지봉투의 기공들이 막혀서 흡입된 공기가 청소기 밖으로 빠져나가지 못하는 경우가 발생하게 됩니다. 이런 경우 먼지봉투가 규정 용량까지 가득 차지 않아도 먼지봉투 교환표시기가 표시되는 경우가 있습니다. 이 때는 먼지봉투를 교환하십시오.
- ▶ 모터보호필터 없이는 절대로 본 제품을 사용하지 마십시오. 모터보호필터가 없는 상태에서 제품을 사용할 경우 모터에 손상을 줄 수 있을 뿐만 아니라 청소기의 수명이 단축될 수도 있습니다.
- ▶ 손잡이에 있는 적외선리모콘에는 전자부품이 포함되어 있습니다.(특정 모델만 적용)  
적외선리모콘 부분은 전자부품이 손상될 수 있으므로 절대로 물로 세척하지 마십시오.

## 악세서리 연결방법

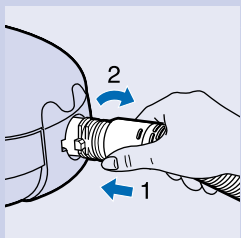

- ▶ 호스의 연결 : 호스를 제품에 눌러 삽입하신 다음 시계 방향으로 돌려서 고정하십시오.
- ▶ 호스의 분리 : 호스를 시계 반대방향으로 돌리신 다음 제품에서 호스를 당기시면 분리됩니다.

## 연결장치 및 작동 방법(특정 모델만 적용)

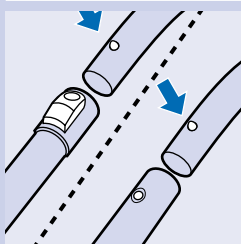

- 1 ▶ 연장관과 손잡이의 연결 : 손잡이에 있는 잠금핀을 누른 상태로 손잡이를 연장관 안으로 밀어 넣으십시오. 손잡이에 있는 잠금핀이 연장관에 있는 구멍에 맞춰져서 "찰칵"소리가 나도록 돌려서 맞추십시오.
- ▶ 연장관에서 손잡이를 분리하실 때는 손잡이에 있는 잠금핀을 누르고, 연장관에서 손잡이를 당기십시오.
- ▶ 다른 악세서를 부착하시거나 분리하실 때에도 이와같은 방법으로 하시면 됩니다.

## 길이조절 가능 연장관 (텔레스코픽 튜브)

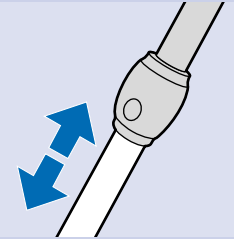

- ▶ 청소할 때 가장 편안한 길이로 연장관을 조절하십시오.

## 콤비노즐

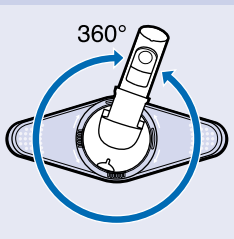

- ▶ 콤비노즐은 카펫나 마루바닥을 청소할 때 사용할 수 있습니다. 콤비노즐의 위치가 4가지로 변형되며, 일반 청소기가 닿을 수 없는 곳까지도 손쉽게 청소할 수 있습니다. 콤비노즐은 시계방향 혹은 시계반대방향으로 360도 회전이 됩니다.

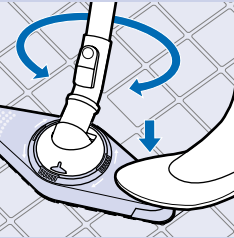

- ▶ 카펫나 마루바닥에 적합하도록 콤비노즐을 조정할 때는 표시된 곳을 발로 누르신 다음 콤비노즐이 원하는 위치로 바뀔 때까지 연장관을 돌리십시오.

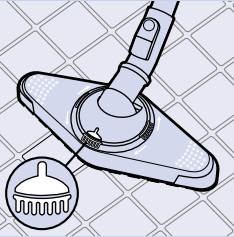

- 1 넓은 마루바닥 청소를 하실 때는 콤비노즐을 “가로” 위치에 놓고, 브러시가 노즐 밖으로 나올 때까지 노즐을 돌린 후 청소를 하시면 편리합니다.

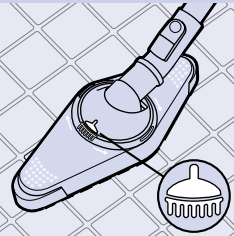

- 2 작고 협소한 마루바닥의 공간을 청소하실 때는 노즐에서 브러시가 나온 상태로 노즐을 90도 시계방향으로 “세로”에 놓일 때까지 돌리신 후 청소를 하시면 편리합니다.

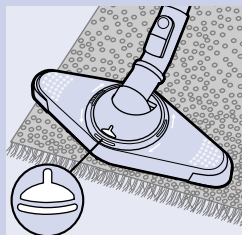

- 3** 카페트와 같이 바닥이 부드러운 곳을 청소하실 때는 노즐 위치를 “가로”에 놓고, 브러쉬가 콤비노즐 안으로 들어간 상태로 청소하시면 편리합니다. 콤비노즐을 가로로 변형시키고 브러쉬를 안으로 넣으려면 다시한번 콤비노즐을 시계방향으로 90도 돌리십시오.

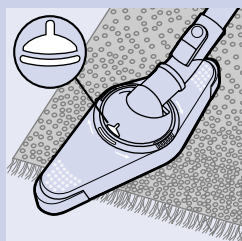

- 4** 카페트와 같이 바닥이 부드러운 곳의 좁고 협소한 곳을 청소하실 때는 노즐 위치를 “세로”에 놓고, 브러쉬가 콤비노즐 안으로 들어간 상태로 청소하시면 편리합니다. 콤비노즐을 세로로 변형시키고 브러쉬를 안으로 넣으려면 다시한번 콤비노즐을 시계방향으로 90도 돌리십시오.

#### 틈새노즐, 솔노즐 및 작은노즐

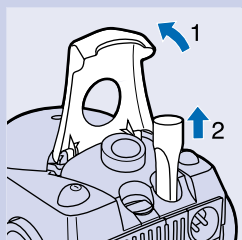

틈새노즐은 공간이 좁은 구석이나, 잘 닿지 않는 곳을 청소할 때 사용하십시오.

- 1** 청소기 몸체의 손잡이를 들어 올려 악세서리 보관함을 열으십시오.
- 2** 틈새노즐을 연장관 또는 손잡이에 직접 연결하십시오.

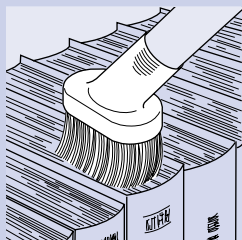

- 3** 솔노즐은 컴퓨터와 책꽂이 등을 청소할 때 편리합니다.

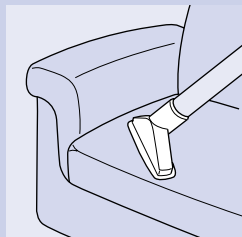

- 4** 작은노즐은 의자나 소파와 같은 협소한 공간을 청소할 때 사용하십시오.

## 사용방법

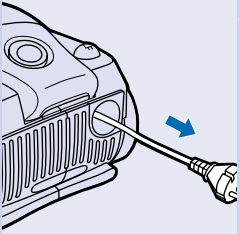

- 1 청소기에서 전원코드를 잡아 당긴 후 벽 콘센트에 전원 플러그를 연결하십시오.

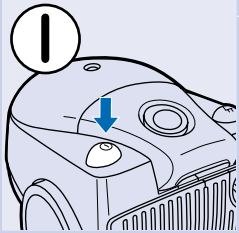

- 2 청소기 몸체 위에 있는 전원스위치를 발로 눌러서 켜십시오.

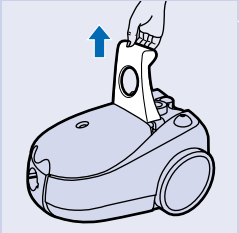

- 3 청소기를 이동할 때는 손잡이를 위로 세운 후 손잡이를 잡고 제품을 이동하십시오.

## 흡입력 조절

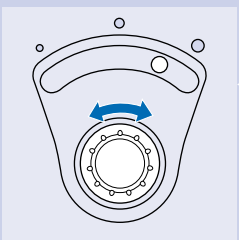

청소중에도 흡입력을 조절할 수 있습니다.

- 1 전자식 흡입력 조절기로 흡입력을 조절할 수 있습니다.(특정 모델만 적용)

## 적외선리모콘(특정 모델만 적용)

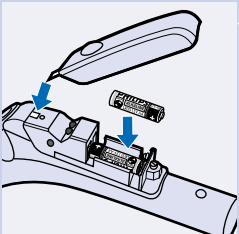

- 1 건전지함에 건전지를 넣으십시오.

건전지의 극성(+, -)이 맞는지 확인하십시오.

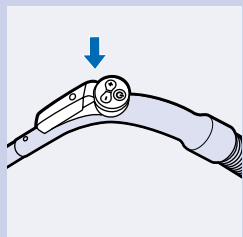

- 2** 리모콘으로는 흡입력을 5단계로 조정할 수 있습니다. 전원스위치를 켜면, 항상 최고(5단계) 위치에서 작동하도록 조정되어 있습니다.

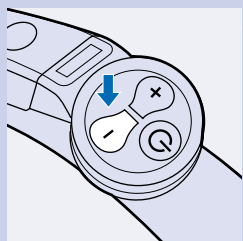

- 3** "-" 버튼을 누르시면 흡입력을 한단계 감소시킬 수 있습니다.

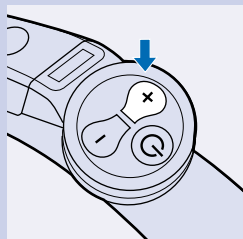

- 4** "+" 버튼을 누르시면 흡입력을 한단계 증가시킬 수 있습니다.

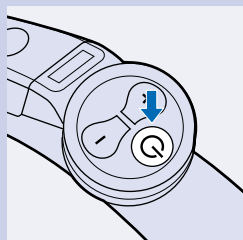

- 5** 청소중에 가구를 옮기실 경우에는 "Stand by"(대기)버튼을 누르십시오. 청소기가 일시적으로 멈추게 됩니다.
- 6** 청소를 계속 진행하시려면 "-" 혹은 "+" 버튼을 누르고, 청소기는 대기상태 이전 흡입력으로 다시 작동합니다.

## 보관

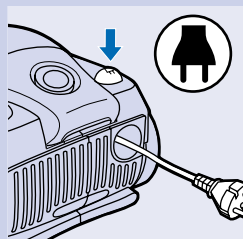

- 1** 전원스위치를 끄십시오.
- 2** 전원플러그를 벽 콘센트에서 뽑으십시오.
- 3** 코드감기 버튼을 눌러 전원코드를 감아주십시오.

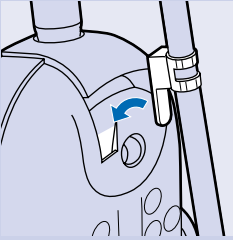

- 4** 청소기를 똑바로 세운 뒤, 아래쪽 튜브에 있는 걸고리를 청소기에 걸어서 보관하십시오.
- ▶ 튜브에 부착된 걸고리를 밀어서 높낮이를 자유롭게 조절할 수 있습니다.

### 먼지봉투 교환

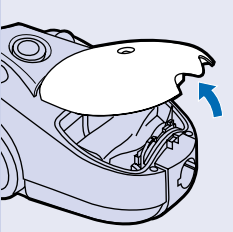

- ▶ 노즐이 바닥에 놓여있지 않은 상태에서 "먼지봉투 교환표시기"의 색깔이 바뀌면 즉시 먼지봉투를 교환하십시오.

- 1** 전원스위치를 끄십시오.
- 2** 뚜껑을 열으십시오.

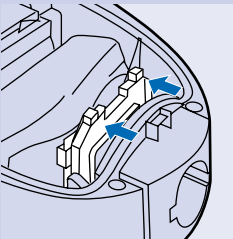

- 3** 먼지봉투 홀더를 뒤로 젖히십시오.

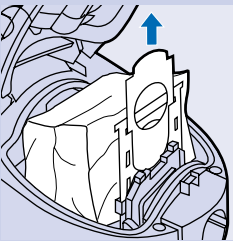

- 4** 두꺼운 판지의 손잡이를 잡아 당겨서 먼지봉투를 홀더로부터 꺼내십시오.  
이 때, 먼지봉투는 자동으로 닫힙니다.

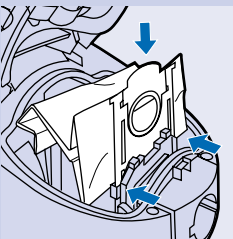

- 5** 새 먼지봉투를 잡고 먼지봉투 홀더의 양 홈 사이에 최대한 깊숙히 밀어 넣으십시오.

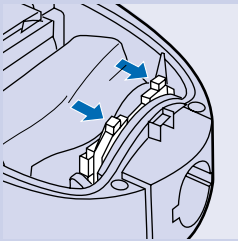

- 6** 클릭 소리가 날 때까지 먼지봉투 홀더를 앞으로 당기십시오.  
먼지봉투가 들어있지 않은 상태에서는 뚜껑이 닫히지 않습니다.

필터 교환

모터보호필터

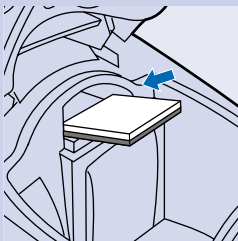

- 1** 새 먼지봉투 세트를 처음 사용하실 때나 혹은 일년에 한번씩 모터보호필터를 교환하십시오.
- 2** 필터의 흰색 면이 위로 향하도록 넣으십시오.

AFS 마이크로 필터(공기정화필터)

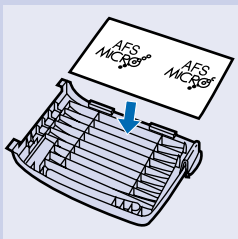

정전기 처리된 AFS 마이크로 필터는 공기 배출구에서 나오는 대부분의 미세입자를 걸러내 줍니다.

- 1** 새 먼지봉투 세트를 처음 사용하거나 혹은 일 년에 한번씩 AFS 마이크로 필터를 교환해 주십시오.
- 2** 새 필터의 옆면과 아래쪽 가장자리 홀더의 돌출부를 잘 맞춰 끼워주십시오.
- 3** 필터홀더를 닫기 전에 필터가 홀더에 제대로 끼워 졌는지 확인하십시오.

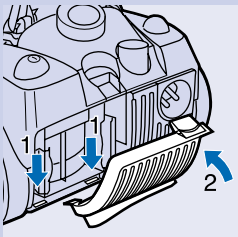

HEPA필터(특정 모델만 적용)

일부 제품은 HEPA필터가 장착되어 있습니다. 이 필터는 일반적인 집안 먼지 뿐만 아니라 인체에 해로운 미세한 해충들까지도 제거해 줍니다.

- 1** 적어도 1년에 한번은 HEPA 필터를 교환해 주십시오.

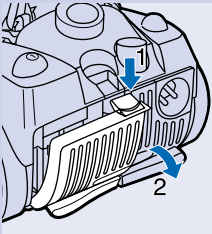

**2** 필터 뚜껑을 열으십시오.

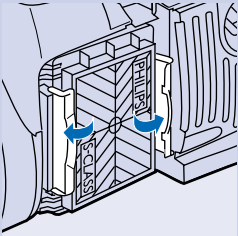

**3** 양 옆에 달린 손잡이를 밑으로 밀어내신 다음 필터를 꺼내십시오.

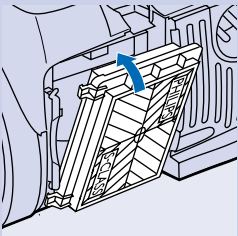

**4** 필터의 흰색 부분이 제품을 향하도록 새 필터를 넣으십시오. 필터에 새겨진 필립스 로고가 오른쪽 윗부분에 있는지 확인하십시오.

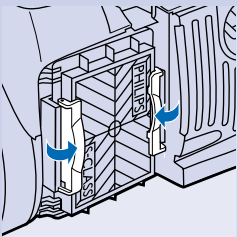

**5** 필터뚜껑을 눌러서 안전하게 닫으십시오.

### 먼지봉투 및 필터 주문

필립스 s-bag™; 종이 먼지봉투는 모델번호 FC8021을 사용하십시오. (서비스번호 4822 480 10113)

제품에 명시된 먼지봉투는 필립스 진공 청소기에 맞도록 제작되었습니다. 씨티 라인이나 임팩트와 같은 소형청소기의 경우, 먼지봉투가 먼지봉투를 넣는 공간보다 크기 때문에 최대 용량까지 차지 않으나 청소기의 작동에는 문제가 없습니다.

모델번호 FC8032에는 두개의 AFS마이크로필터와 한개의 모터 보호필터가 들어있습니다. (서비스번호 4822 015 70056)

HEPA 필터는 모델번호 HR6992를 사용하십시오. (서비스번호 4822 480 10084)

먼지봉투, 필터 혹은 약세사리의 구입문의는 필립스 고객센터  
실로 연락주십시오.

전국 필립스 서비스센터 안내는 제품 보증서를 참조하십시오.

환 경

재활용을 위하여, 본 제품에 사용된 플라스틱에는 재활용 분  
류코드가 표시되어 있습니다.

두꺼운 종이 재질의 포장상자는 재활용품으로 만들어 졌으며,  
다시 재활용이 가능합니다.

제품을 폐기하기 전에 건전지를 분리하십시오. 건전지는 일반  
가정용 쓰레기와 분리하여 지정된 장소에 버리십시오. 또는  
건전지를 필립스 서비스 센터로 가져오십시오.

전원코드의 교체

본 제품의 전원코드가 손상되었을 경우, 특수한 공구나 부품  
이 필요하므로 반드시 필립스 혹은 지정된 서비스 센터로 문  
의하여 교체하십시오.

문제 해결방법

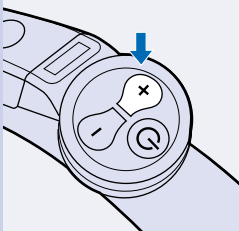

▶ 흡입력이 부족할 때 :

**1** 리모콘의 "+"버튼을 눌러서 흡입력을 올리십시오. (특정  
모델만 적용)

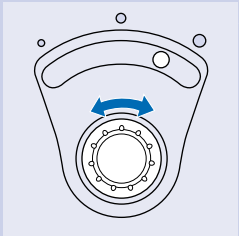

**2** 전자흡입력조절기로 흡입력을 높게 설정하십시오. (특정  
모델만 적용)

**3** 먼지봉투 교체시기가 되었는지 확인하십시오.

**4** 필터 교체시기가 되었는지 확인하십시오.

**5** 노즐, 연장관 혹은 호스가 막혔는지 확인하십시오.

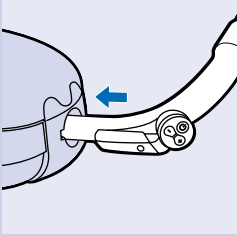

- 6** 막혀있는 부분을 분리하여, 호스나 연장관을 반대방향으로 청소기에 결합한 후 청소기를 작동시켜서 이물질을 제거하십시오.

▶ 적외선 리모콘이 작동하지 않을 경우 :

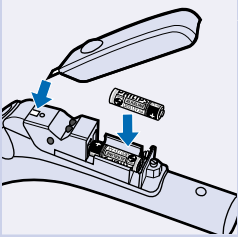

- 8** 건전지 덮개를 열고, 건전지를 꺼낸 후 다시 끼우십시오.

- 9** 건전지 수명이 다 되었을 수 있습니다.

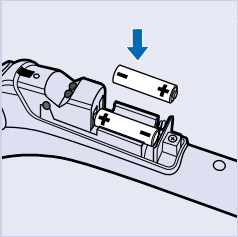

- 10** 새로운 건전지로 교체해 주십시오.(+, - 극성이 맞게 삽입되었는지 확인 하십시오)



