



02

English

*Moltio*

## USER MANUAL

Type HD8768 - HD8885

Read carefully before using the machine.



EN

02



Register your product and get support at  
[www.saeco.com/welcome](http://www.saeco.com/welcome)

# IMPORTANT SAFEGUARDS

When using electrical appliances, basic safety precautions should always be followed, including the following:

1. Read all instructions.
2. Do not touch hot surfaces. Use handles or knobs.
3. To protect against fire, electric shock and injury to persons do not immerse cord, plugs, or appliance in water or other liquid.
4. Close supervision is necessary when the appliance is used by or near children.
5. Unplug from outlet when not in use and before cleaning. Allow to cool before putting on or taking off parts, and before cleaning the appliance.
6. Do not operate any appliance with a damaged cord or plug or after the appliance malfunctions, or has been damaged in any manner. Return appliance to the nearest authorized service facility for examination, repair or adjustment.
7. The use of accessory attachments not recommended by the appliance manufacturer may result in fire, electric shock or injury to persons.
8. Do not use outdoors.
9. Do not let cord hang over edge of table or counter, or touch hot surfaces.
10. Do not place on or near a hot gas or electric burner, or in a heated oven.
11. Always attach plug to appliance first, then plug cord into wall outlet. To disconnect, turn any control to "off", then remove plug from wall outlet.
12. Do not use appliance for other than intended use.
13. Save these instructions.

## SAVE THESE INSTRUCTIONS

# CAUTION

This appliance is for household use only. Any servicing, other than cleaning and user maintenance, should be performed by an authorized service center. Do not immerse machine in water. To reduce the risk of fire or electric shock, do not disassemble the machine. There are no parts inside the machine serviceable by the user. Repair should be done by authorized service personnel only.

1. Check voltage to be sure that the voltage indicated on the nameplate corresponds with your voltage.
2. Never use warm or hot water to fill the water tank. Use cold water only.
3. Keep your hands and the cord away from hot parts of the appliance during operation.
4. Never clean with scrubbing powders or harsh cleaners. Simply use a soft cloth dampened with water.
5. For optimal taste of your coffee, use purified or bottled water. Periodic descaling is still recommended every 2-3 months.
6. Do not use caramelized or flavored coffee beans.

## INSTRUCTIONS FOR THE POWER SUPPLY CORD

- A. A short power-supply cord (or detachable power-supply cord) is to be provided to reduce risks resulting from becoming entangled in or tripping over a longer cord.
- B. Longer detachable power-supply cords or extension cords are available and may be used if care is exercised in their use.
- C. If a long detachable power-supply cord or extension cord is used,
  1. The marked electrical rating of the detachable power-supply cord or extension cord should be at least as great as the electrical rating of the appliance
  2. If the appliance is of the grounded type, the extension cord should be a grounding-type 3-wire cord, and
  3. The longer cord should be arranged so that it will not drape over the counter top or table top where it can be pulled on by children or tripped over.

*Congratulations on your purchase of a Saeco Moltio Automatic Milk Frother fully automatic coffee machine!*  
*To fully benefit from the support that Saeco offers, please register your product at [www.saeco.com/welcome](http://www.saeco.com/welcome).*  
*The machine is made for preparing espresso coffee using whole coffee beans, as well as for frothing milk and dispensing hot water. In this user manual you will find all the information you need to install, use, clean and descale your machine.*

## **CONTENTS**

<b>IMPORTANT.....</b>	<b>4</b>
Safety Instructions.....	4
Warnings.....	4
Cautions .....	6
Electromagnetic fields.....	7
Disposal .....	7
<b>INSTALLATION .....</b>	<b>8</b>
Product Overview .....	8
General Description .....	9
<b>PREPARING FOR USE.....</b>	<b>10</b>
Machine Packaging.....	10
Machine Installation .....	10
<b>USING THE MACHINE FOR THE FIRST TIME .....</b>	<b>14</b>
Circuit Priming.....	14
Automatic Rinse/Self-Cleaning Cycle .....	15
Manual Rinse Cycle .....	15
Measuring and Programming Water Hardness .....	18
"INTENZA+" Water Filter Installation.....	19
Replacing the "INTENZA+" Water Filter.....	21
<b>CHANGING COFFEE BEANS .....</b>	<b>22</b>
Removing the Coffee Bean Hopper .....	22
Inserting the Coffee Bean Hopper .....	23
Selecting Coffee Beans .....	25
Coffee Emptying Cycle .....	26

<b>ADJUSTMENTS .....</b>	<b>27</b>
Saeco Adapting System .....	27
Adjusting the Ceramic Coffee Grinder .....	27
Adjusting the Aroma (Coffee Strength) .....	28
Adjusting the Coffee Dispensing Spout .....	29
Adjusting the Coffee Length .....	30
<b>BREWING ESPRESSO AND COFFEE .....</b>	<b>31</b>
Brewing Espresso and Coffee Using Coffee Beans .....	31
Brewing Espresso and Coffee Using Pre-Ground Coffee .....	32
<b>FROTHING MILK AND PREPARING A CAPPUCCINO .....</b>	<b>33</b>
Frothing Milk .....	33
Brewing a Cappuccino .....	36
<b>DISPENSING HOT WATER .....</b>	<b>37</b>
<b>CLEANING AND MAINTENANCE .....</b>	<b>39</b>
Daily Cleaning of the Machine .....	39
Daily Cleaning of the Water Tank .....	40
Daily Cleaning of the Automatic Milk Frother .....	41
Weekly Cleaning of the Machine .....	42
Weekly Cleaning of the Brew Group .....	42
Weekly Cleaning of the Coffee Bean Hopper, Tray and Coffee Compartment .....	46
Monthly Lubrication of the Brew Group .....	47
Monthly Cleaning of the Automatic Milk Frother .....	49
Monthly Cleaning of the Brew Group with "Coffee Oil Remover" .....	55
<b>DESCALING .....</b>	<b>58</b>
<b>ACCIDENTAL INTERRUPTION OF THE DESCALING CYCLE .....</b>	<b>64</b>
<b>PROGRAMMING .....</b>	<b>65</b>
The following settings can be adjusted .....	65
How to Program the Machine .....	67
<b>MEANING OF THE DISPLAY ICONS .....</b>	<b>69</b>
<b>TROUBLESHOOTING .....</b>	<b>73</b>
<b>ENERGY SAVING .....</b>	<b>76</b>
Stand-by .....	76
<b>TECHNICAL SPECIFICATIONS .....</b>	<b>77</b>
<b>WARRANTY AND SERVICE .....</b>	<b>77</b>
Warranty .....	77
Service .....	77
<b>ORDERING MAINTENANCE PRODUCTS .....</b>	<b>78</b>
<b>MACHINE ACCESSORIES .....</b>	<b>79</b>

## IMPORTANT

### Safety Instructions

This machine is equipped with safety devices. Nevertheless, read and follow the safety instructions carefully and only use the machine properly as described in these instructions to avoid accidental injury or damage due to improper use of the machine. Keep this user manual for future reference.



The term **WARNING** and this icon warn against possible severe injuries, danger to life and/or damage to the machine.



The term **CAUTION** and this icon warn against slight injuries and/or damage to the machine.

### Warnings

- Connect the machine to a wall socket with a voltage matching the technical specifications of the machine.
- Connect the machine to an earthed wall socket.
- Do not let the power cord hang over the edge of a table or counter, or touch hot surfaces.
- Never immerse the machine, the mains plug or power cord in water: Danger of electrical shock!
- Do not pour liquids on the power cord connector.
- Never direct the hot water jet towards body parts: Danger of scalding!
- Do not touch hot surfaces. Use handles and knobs.
- After switching off the machine by pressing the power button on the back of the machine, remove the mains plug from the wall socket:
  - if a malfunction occurs;

- If the machine will not be used for a long time;
  - before cleaning the machine.
- Pull on the mains plug, not on the power cord.
- Do not touch the mains plug with wet hands.
- Do not use the machine if the mains plug, the power cord or the machine itself is damaged.
- Do not make any modifications to the machine or its power cord. Only have repairs carried out by a service centre authorised by Philips to avoid any hazard.
- The machine should not be used by children younger than 8 years old.
- The machine can be used by children of 8 years and upwards if they have previously been instructed on the correct use of the machine and made aware of the associated dangers or if they are supervised by an adult.
- Cleaning and maintenance should not be carried out by children unless they are more than 8 years old and supervised by an adult.
- Keep the machine and its power cord out of reach of children under 8 years old.
- The machine may be used by persons with reduced physical, sensory or mental capabilities or lacking sufficient experience and/or skills if they have previously been instructed on the correct use of the machine and made aware of the associated dangers or if they are supervised by an adult.
- Children should be supervised to ensure that they do not play with the machine.
- Never insert fingers or other objects into the coffee grinder.

## Cautions

---

- The machine is for household use only. It is not intended for use in environments such as canteens, staff kitchens of shops, offices, factories or other work environments.
- Always put the machine on a flat and stable surface.
- Do not place the machine on hot surfaces, directly next to a hot oven, heater units or similar sources of heat.
- Only put roasted coffee beans into the coffee bean hopper. If ground coffee, instant coffee, raw coffee or any other substance is put in the coffee bean hopper, it may damage the machine.
- Let the machine cool down before inserting or removing any parts. The heating surfaces may retain residual heat after use.
- Never use warm or hot water to fill the water tank. Use only cold non-sparkling drinking water.
- Never clean with scrubbing powders or harsh cleaners. Simply use a soft cloth dampened with water.
- Descale your machine regularly. Not doing this will make your appliance stop working properly. In this case, repair is not covered under your warranty!
- Do not keep the machine at temperature below 0 °C. Residue water in the heating system may freeze and cause damage.
- Do not leave water in the water tank if the machine is not used over a long period of time. The water can get contaminated. Use fresh water every time you use the machine.



---

## Electromagnetic fields

This appliance complies with all the applicable standards and regulations relating to the exposure to electromagnetic fields.

---

## Disposal



This symbol on a product indicates that the product is covered by EU Directive 2012/19/EU. Please inform yourself about the local separate collection system for electrical and electronic products. Follow local regulations and do not dispose of the product as household waste. Appropriate disposal of old products helps prevent negative consequences for the environment and human health.

## INSTALLATION

### Product Overview

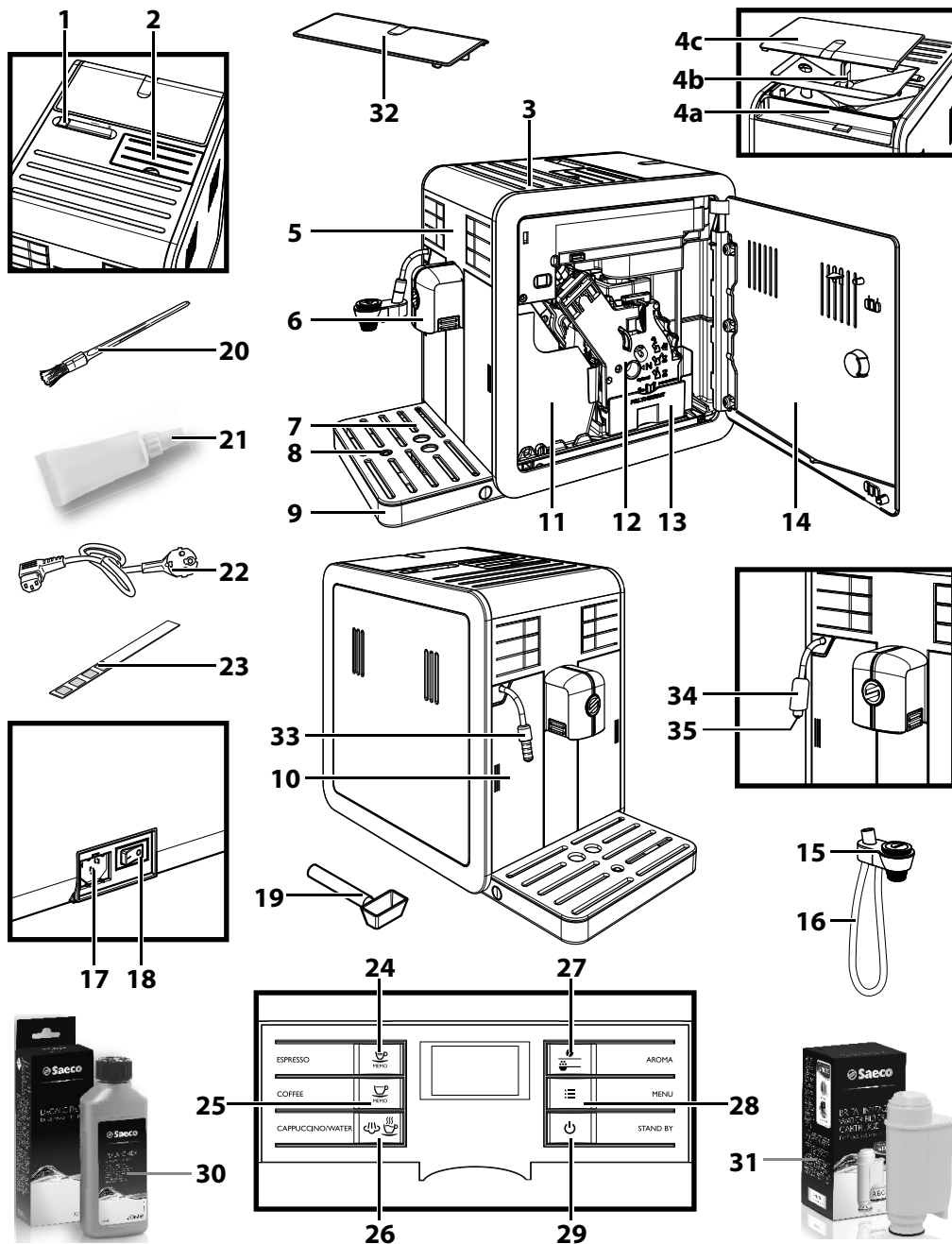

---

**General Description**

---

1. Coffee bean hopper locking/removal selector switch
2. Pre-ground coffee compartment
3. Cup stacking surface
- 4a. Coffee bean hopper
- 4b. Coffee bean hopper tray
- 4c. Coffee bean hopper lid
5. Control panel
6. Coffee dispensing spout
7. Cup holder grill
8. Full drip tray indicator
9. Drip tray
10. Water tank
11. Coffee grounds drawer
12. Brew group
13. Coffee residues drawer
14. Service door
15. Automatic Milk Frother
16. Suction tube for Automatic Milk Frother
17. Power cord socket
18. Power button
19. Coffee grinder adjustment key + Pre-ground coffee measuring scoop
20. Cleaning brush (optional)
21. Grease for brew group (optional)
22. Power cord
23. Water hardness test strip
24. Espresso brew button
25. Coffee brew button
26. Cappuccino / hot water button
27. "Aroma" - Pre-ground coffee button
28. "MENU" button
29. ON/OFF button
30. Descaling solution (to be purchased separately)
31. Filter (INTENZA+) (to be purchased separately)
32. Protection lid (optional)
33. Steam/hot water wand + rubber fitting for Automatic Milk Frother
34. Chrome cover (only for specific models)
35. Rubber fitting

## PREPARING FOR USE

### Machine Packaging

The original packaging has been designed and constructed to protect the machine during transport. We recommend keeping the packaging material for possible future transport.

### Machine Installation

**1** Remove the drip tray with grill from the packaging.

**2** Remove the machine from the packaging.

**3** For best use, it is recommended to:

- Choose a safe, level surface, where there will be no danger of overturning the appliance or being injured;
- Choose a location that is sufficiently well-lit, clean and near an easily reachable socket.
- Allow for a minimum distance from the sides of the machine as shown in the figure.

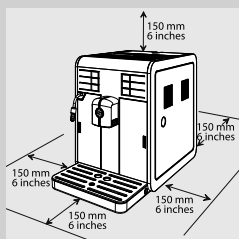

**4** Insert the drip tray with grill into the machine. Make sure it is fully inserted.

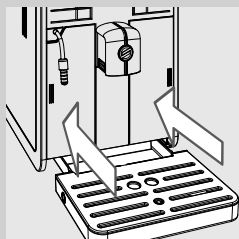

#### Note:

The drip tray collects the water that comes out of the coffee dispensing spout during each rinse/self-cleaning cycle, as well as any coffee that might be spilled during beverage brewing. Empty and wash the drip tray daily and each time the full drip tray indicator is raised.



#### Caution:

**NEVER** remove the drip tray when the machine has just been turned on. Wait a couple of minutes for the machine to carry out a rinse/self-cleaning cycle.

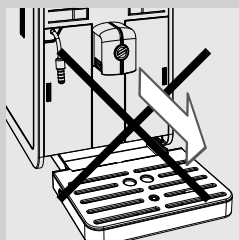

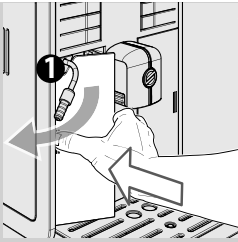

**5** Press gently on the side of the water tank door to release the handgrip.

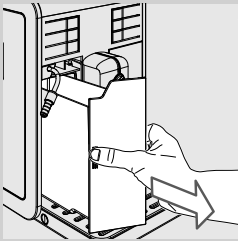

**6** Remove the water tank by pulling it by the handgrip.

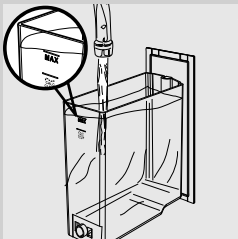

**7** Rinse the water tank with fresh water.

**8** Fill the water tank with fresh water up to the MAX level and reinsert it into the machine. Make sure it is fully inserted.



**Caution:**

**Never fill the water tank with warm, hot, sparkling water or any other liquid, as this may cause damage to the water tank and the machine.**



**Note:**

When the water tank is full, it must be transported as shown in the figure.

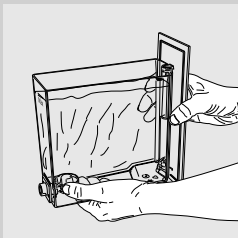

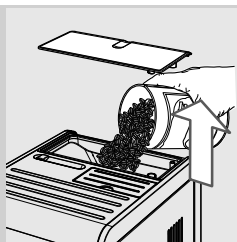

**9** Remove the coffee bean hopper lid. Slowly pour in the coffee beans.



**Note:**

The coffee bean hopper contains a tray that vibrates during grinding and conveys the beans into the coffee grinder.



**Caution:**

**Only coffee beans must be put into the coffee bean hopper. If ground coffee, instant coffee, caramelized coffee, raw coffee beans or any other substance is put in the coffee bean hopper, it may damage the machine.**

**10** Put the lid back on the coffee bean hopper.

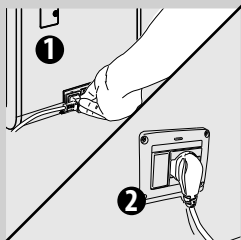

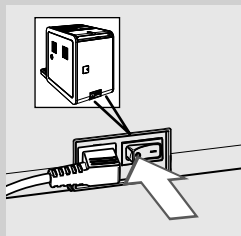

**11** Insert the plug into the socket located on the back of the machine.

**12** Insert the plug at the other end of the power cord into a wall socket with suitable power voltage.

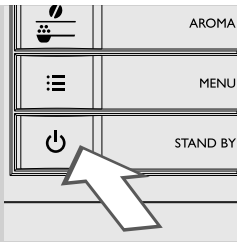

**13** Switch the power button to "I". The red light next to the "I" button flashes.



**14** To turn on the machine, simply press the “” button.

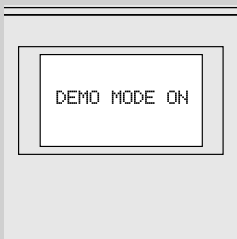

**Note:**

By keeping the button pressed for more than 8 seconds, the machine enters the demo mode. To exit the demo, turn the machine off and on again using the power button.

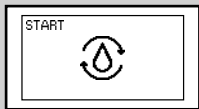

**15** The control panel indicates that the circuit must be primed.

**USING THE MACHINE FOR THE FIRST TIME**

When using the machine for the first time, the following activities need to happen:

- 1) You need to prime the circuit.
- 2) The machine will perform an automatic rinse/self-cleaning cycle.
- 3) You need to perform a manual rinse cycle.

**Circuit Priming**

During this process, fresh water flows through the internal circuit of the machine and the machine warms up. This takes a few minutes.

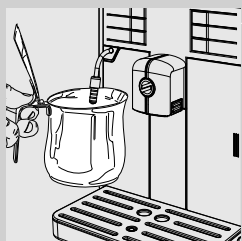

- 1** Place an empty container under the steam wand.

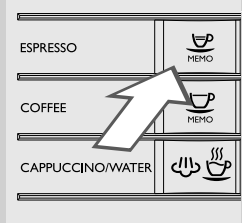

- 2** Press the "☕" button to start the cycle. The machine starts the automatic priming of the circuit by dispensing some water through the steam wand.



Yellow

- 3** The bar under the icon shows the operation progress. When the process has been completed, the machine stops dispensing automatically.

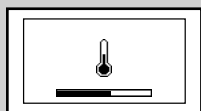

Yellow

- 4** The control panel now shows the machine warm-up icon.



### Automatic Rinse/Self-Cleaning Cycle

When warm-up has been completed, the machine automatically performs a rinse/self-cleaning cycle of the internal circuits with fresh water. This takes less than a minute.

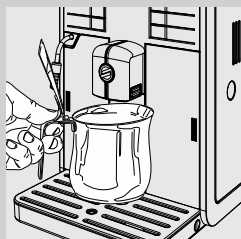

- 1 Place a container under the coffee dispensing spout to catch the small amount of water which will be dispensed.



Yellow

- 2 The machine shows this display. Wait for the cycle to finish automatically.



**Note:**

You can stop dispensing by pressing the "☺" button.

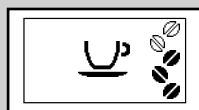

Green

- 3 When the operations described above have been completed, the machine shows this display. You can now perform the manual rinse cycle.

### Manual Rinse Cycle

During this process you activate the coffee brewing cycle and fresh water flows through the water circuit. This takes a few minutes.

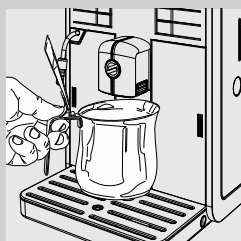

- 1 Place a container under the coffee dispensing spout.

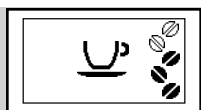

Green

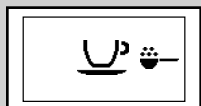

Green

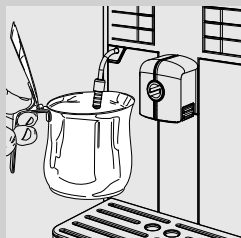

Green

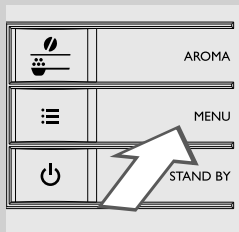

**2** Check that the machine shows this display.

**3** Select the pre-ground coffee brewing function by pressing the "☕" button. The machine shows this display.

**Note:**

Do not add any pre-ground coffee into the compartment.

**4** Press the "☕" button. The machine starts dispensing water.

**5** When dispensing has finished, empty the container. Repeat the operations from step 1 to step 4 twice, then continue with step 6.

**6** Place a container under the steam wand.

**7** Press the "☕" button. The machine shows this display.

**8** Press the "☕" **MENU** button to start dispensing hot water.

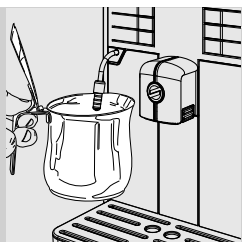

- 9** After dispensing water, remove and empty the container.

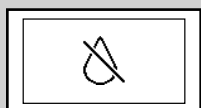

Red

- 10** Repeat steps 7 to 9 until the water tank is empty and the no water warning sign appears.



**Note:**  
Press the "MEMO" button to stop the manual rinse cycle.

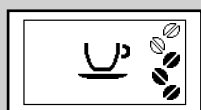
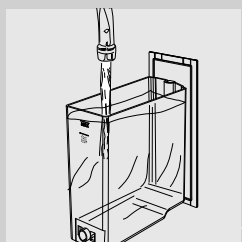

Green

- 11** At the end of this operation, fill the water tank again up to the MAX level. The machine is now ready to brew coffee. This icon will be displayed.



**Note:**  
The automatic rinse/self-cleaning cycle starts when the machine has been in stand-by mode, or turned off, for more than 15 minutes. When you have not used the machine for 2 or more weeks, you will also need to perform a manual rinse cycle. At the end of the cycle, you can brew a coffee.

### Measuring and Programming Water Hardness

Water hardness measuring is very important in order to define the descaling frequency and to install the "INTENZA+" water filter (for more details on the water filter, see next chapter).

To measure the water hardness follow the steps below:

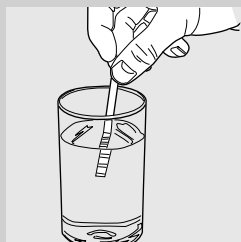

- 1** Immerse the water hardness test strip (supplied with the machine) in water for 1 second.



**Note:**

The test strip can only be used for one single measurement.

- 2** Wait for one minute.

- 3** Check how many squares have changed to red, then consult the table.



**Note:**

The numbers on the water hardness test strip correspond to the water hardness adjustment settings.

More precisely:

- 1 = 1 (very soft water)
- 2 = 2 (soft water)
- 3 = 3 (hard water)
- 4 = 4 (very hard water)

The letters correspond to the references that are located at the base of the "INTENZA+" water filter (see next chapter).

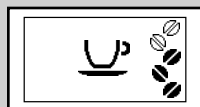
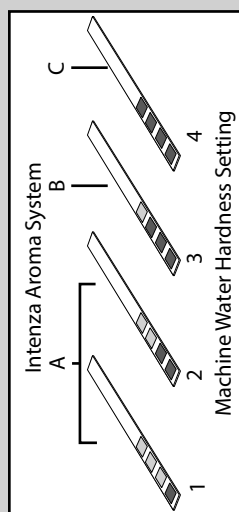

Green

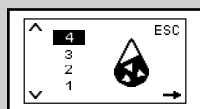

Yellow

- 4** Press the "MENU" button and scroll through the options by pressing the "MENU" button until this icon is displayed.



**Note:**

The machine is supplied with a standard water hardness setting, suitable for most types of water.

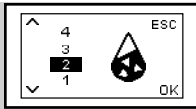

Yellow

**5** Press the button to increase the value and the button to decrease the value.

**6** Press the **MENU** button to confirm the setting.



Green

**7** Press the button to exit the programming menu. The machine is now ready for brewing.

### "INTENZA+" Water Filter Installation

We recommend that you install the "INTENZA+" water filter as this prevents limescale build-up in your machine and preserves a more intense aroma of your coffee.



The "INTENZA+" water filter can be purchased separately. For further details, please refer to the maintenance products page in this user manual. Water is a crucial part of every coffee, so it is very important to always have it professionally filtered. Using the "INTENZA+" water filter will prevent mineral deposits from building up and improve your water quality.

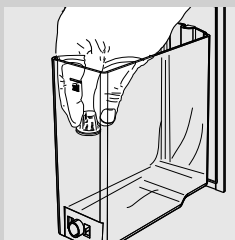

**1** Remove the small white filter from the water tank and store it in a dry place.



- 2** Remove the "INTENZA+" water filter from its packaging, immerse it vertically (with the opening positioned upwards) in cold water and gently press the sides so as to let the air bubbles out.

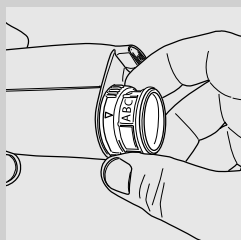

- 3** Set the "INTENZA+" water filter according to the measurements performed (see previous chapter) and indicated on the base of the filter:  
 A = soft water – equals 1 or 2 on the test strip  
 B = hard water (standard) – equals 3 on the test strip  
 C = very hard water – equals 4 on the test strip

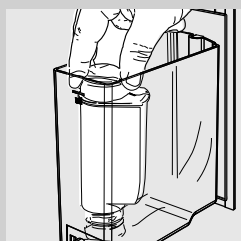

- 4** Put the "INTENZA +" water filter into the empty water tank. Press it down until it cannot move any further.
- 5** Fill the water tank with fresh water and put it into the machine.
- 6** Dispense all the water in the tank by using the hot water function (see the "Dispensing Hot Water" section).
- 7** Fill the water tank again.

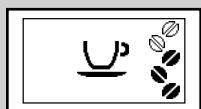

Green

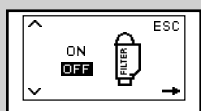

Yellow

- 8** Press the "MENU" button and scroll through the options by pressing the "MENU" button until this icon is displayed.

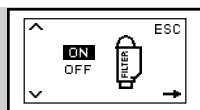

Yellow

- 9** Press the “” button to select “ON”, then press the “” button to confirm.

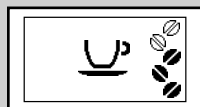

Green

- 10** To exit, press the “”. The machine is now ready for brewing.

The machine is now programmed to inform the user of the need to replace the “INTENZA+” water filter.

## Replacing the “INTENZA+” Water Filter

When the “INTENZA+” water filter needs to be replaced with a new one, this icon is displayed.

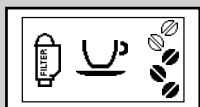

Yellow

- 1** Replace the “INTENZA+” water filter as described in the previous chapter.

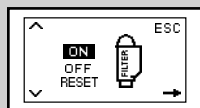

Yellow

- 2** Press the “” **MENU** button and scroll through the options by pressing the “” **MENU** button until this icon is displayed.



Yellow

- 3** Select the “RESET” option. Press the “” **MENU** button to confirm.

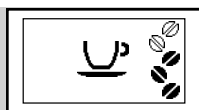

Green



Yellow

**4** To exit, press the “” button. The machine is now ready for brewing.

The machine is now programmed to manage a new filter.

**Note:**

If the “INTENZA+” water filter is already installed and you want to remove, but not replace it, select the “OFF” option instead.

If there is no “INTENZA+” water filter installed, insert the small white filter previously removed into the water tank.

## CHANGING COFFEE BEANS

The machine comes with a removable coffee bean hopper so you can easily switch from one type of coffee bean to another and enjoy a different coffee taste.

**Note:**

You can buy an additional coffee bean hopper as an accessory (CA6803). To preserve their taste, you can store coffee beans in the bean hopper in the refrigerator.

### Removing the Coffee Bean Hopper

To remove the coffee bean hopper follow the steps below:

**1** Move the selector switch to the “” position.

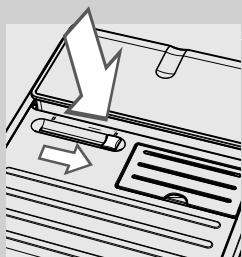
**Caution:**

**It may happen that the selector switch can not be shifted as it is blocked by coffee beans. In this case, move the selector switch back and forth until the coffee beans are released.**



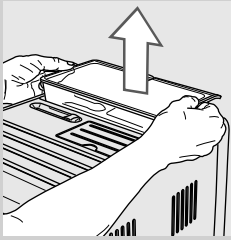

- 2** Lift the sides of the coffee bean hopper with both hands as shown in the figure.



**Caution:**

**Do not remove the coffee bean hopper in a different way to avoid spilling coffee beans.**

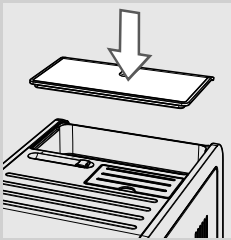

- 3** After removing it, put the protection lid (if any) on the machine to keep it dust-free.

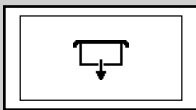

Red



**Note:**

If the machine is turned on without the coffee bean hopper being inserted, this icon will appear. You need to insert the coffee bean hopper first.

### Inserting the Coffee Bean Hopper

To insert the coffee bean hopper, follow the steps below:

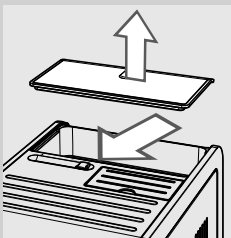

- 1** Remove the protection lid (if any) from the machine.

- 2** Move the selector switch to the "☐" position.

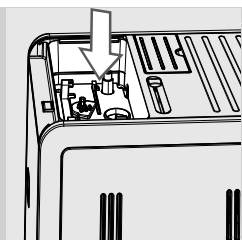

**3** Remove any beans from the coffee bean hopper compartment.

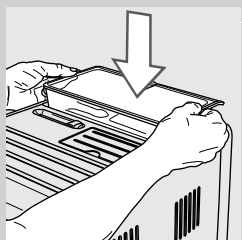

**4** Insert the coffee bean hopper into its compartment as shown in the figure.

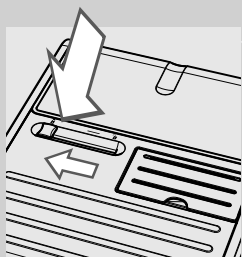

**5** Move the selector switch to the "I" position.



**Warning:**

**Please be aware that when you change coffee beans and switch to decaffeinated coffee, some caffeine traces might still be present even after performing an emptying cycle.**

## Selecting Coffee Beans

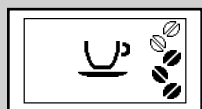

This function allows you to optimize grinding according to the selected type of coffee beans.



Green



Yellow

**1** Press the “ MENU” button and scroll through the options by pressing the “ MENU” button until this icon is displayed.

**2** Press the “” button or the “” button to select the type of coffee beans in the coffee bean hopper.

**3** Press the “ MENU” button to confirm the setting.

**4** To exit, press the “” button.

The machine is now programmed to optimise coffee bean grinding.

The display shows the selected type of coffee beans when the machine is ready for brewing.

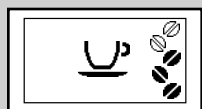

Green

- for “ARABICA” coffee beans;

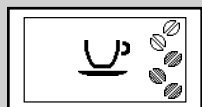

Green

- for “ROBUSTA” coffee beans;

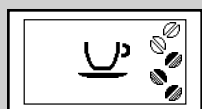

Green

- for “MIXED” coffee beans.

### Coffee Emptying Cycle

When you change coffee beans, it is recommended to empty the coffee outlet duct and grinder. In this way, you will be able to fully taste the aroma of the new coffee beans. For this, follow the steps below:

**1** Fill the coffee bean hopper with coffee beans.

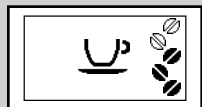

Green

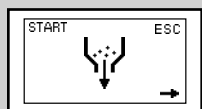

Yellow

**2** Press the "☰" **MENU** button and scroll through the options by pressing the "☰" **MENU** button until this icon is displayed.

**3** Press the "☺" **MEMO** button.

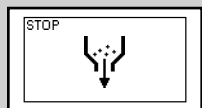

Yellow

**4** The machine performs two grinding cycles without brewing coffee.



**Note:**

If you press the "☺" **MEMO** button between the first and second grinding cycle, you can stop the grinding cycle earlier.

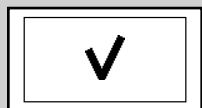

Green

**5** When the grinding cycles have been completed, the machine shows this icon.



**Note:**

If you have not emptied the coffee outlet duct and grinder, you need to brew at least two coffees before you can taste the new coffee beans.



**Warning:**

**Please be aware that when you change coffee beans and switch to decaffeinated coffee, some caffeine traces might still be present even after performing an emptying cycle.**

## ADJUSTMENTS

The machine allows for certain adjustments so that you can brew the best tasting coffee possible.

### Saeco Adapting System

Coffee is a natural product and its characteristics may change according to its origin, blend and roast. The machine is equipped with a self-adjusting system that allows the use of all types of coffee beans available on the market, except for raw, caramelized and flavoured coffee beans. The machine automatically adjusts itself after brewing several cups of coffee to optimize coffee extraction.

### Adjusting the Ceramic Coffee Grinder

Ceramic coffee grinders always guarantee an accurate and perfect grinding and a specific coarseness for every coffee speciality. This provides full aroma preservation, delivering a truly Italian taste in every cup.



#### **Warning:**

**The ceramic coffee grinder contains moving parts that may be dangerous. Do not insert fingers or other objects. Only adjust the ceramic coffee grinder using the grinder adjustment key.**

You can adjust the ceramic grinders to set the coffee grinding to your personal taste.

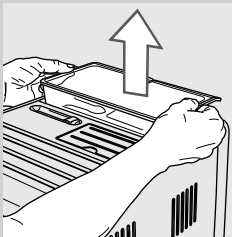

- 1** Remove the coffee bean hopper as shown in the "Removing the Coffee Bean Hopper" section.

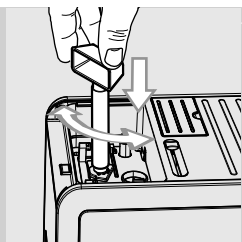

- 2** Press and turn the grinder adjustment knob inside the coffee bean hopper one notch at a time. Use the special coffee grinder adjustment key supplied. You will taste the difference after brewing 2-3 cups of coffee.



**Warning:**

**Do not turn the coffee grinder more than one notch at a time to prevent damage.**

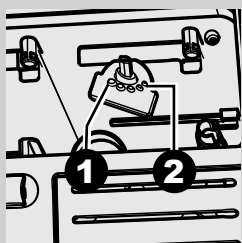

- 3** The reference marks inside the coffee bean hopper indicate the grind setting. There are 5 different grind settings to choose from, from position 1 (●) for coarse grind - lighter taste to position 2 (●) for fine grind - stronger taste. If coffee is watery or is brewed slowly, change the coffee grinder settings.

### Adjusting the Aroma (Coffee Strength)

Choose your favourite coffee blend and adjust the amount of coffee to be ground according to your personal taste. You can also select the pre-ground coffee function.

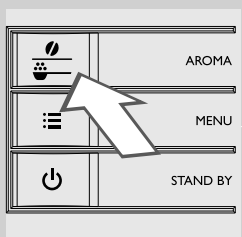

**Note:**

Selection must be made prior to selecting coffee.

You can choose from 5 options by pressing the "☕" button. Each time the "☕" button is pressed, the aroma changes by one degree, according to the selected amount:

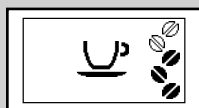

Green

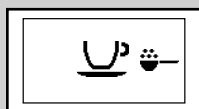

Green

- ☕☕☕☕☕ = extra mild aroma
- ☕☕☕☕☕ = mild aroma
- ☕☕☕☕☕ = medium aroma
- ☕☕☕☕☕ = strong aroma
- ☕☕☕☕☕ = extra strong aroma
- ☕☕☕☕☕ = pre-ground coffee

### Adjusting the Coffee Dispensing Spout

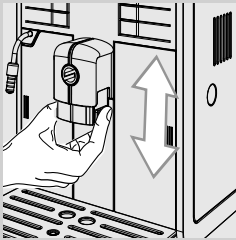

The height of the coffee dispensing spout can be adjusted to better fit the dimensions of the cups that you wish to use.

Move the coffee dispensing spout up or down with your fingers to adjust its height as shown in the figure.

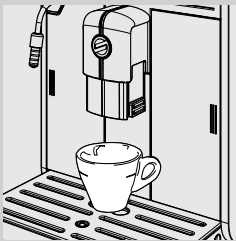

The recommended positions are:  
For the use of small cups.

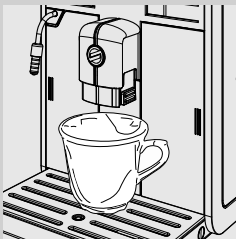

For the use of large cups.

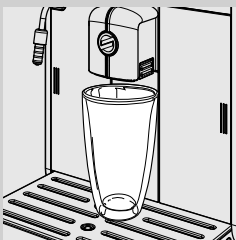

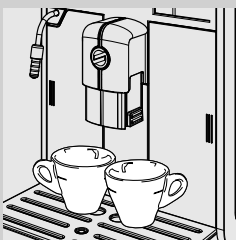

For the use of glasses for the Latte Macchiato.



Two cups can be placed under the coffee dispensing spout to brew two coffees at the same time.

### Adjusting the Coffee Length

The machine allows you to adjust the amount of brewed coffee according to your taste and/or the size of your cups.

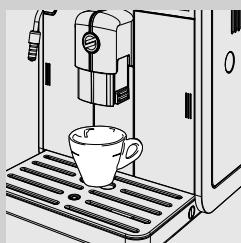

Each time the “” or “” button is pressed, the machine brews a pre-set amount of coffee. Each button may be individually programmed for a specific brew setting.



- 1 Place a cup under the coffee dispensing spout.



Green

- 2 Keep the “” button pressed until the “MEMO” icon appears on the display to program an espresso, or do the same with the “” button to program a coffee. Then release the button. The machine is in programming mode and starts brewing the selected product.



Green

- 3 Press the “” button as soon as the desired amount of espresso or coffee is reached.

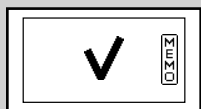

Green

The previously selected “” or “” button is now programmed; each time it is pressed, the machine will brew the same amount of espresso or coffee that was just programmed.



## BREWING ESPRESSO AND COFFEE

Before brewing coffee, make sure that there are no warnings shown on the control panel, and that the water tank and coffee bean hopper are filled.

### Brewing Espresso and Coffee Using Coffee Beans

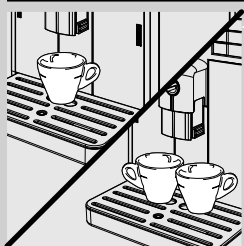

- 1 Place 1 or 2 cups under the coffee dispensing spout.

- 2 To brew an espresso or a coffee, press the "☕" button to select the desired aroma.

- 3 Press the "☕ MEMO" button for an espresso or the "☕ MEMO" button for a coffee.



Green

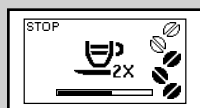

Green

- 4 To brew 2 cups of espresso or coffee, press the desired button twice consecutively. This icon will be displayed.



#### Note:

In this operating mode, the machine automatically grinds and doses the correct amount of coffee. Brewing two cups of espresso or coffee requires two grinding and brewing cycles, automatically carried out by the machine.

- 5 After the prebrewing cycle, coffee begins to pour out of the coffee dispensing spout.
- 6 Coffee brewing stops automatically when the set level is reached. However, it is possible to stop coffee brewing early by pressing the "☕ MEMO" button.

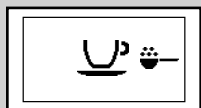



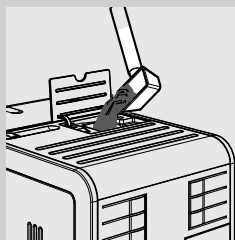

Green



### Brewing Espresso and Coffee Using Pre-Ground Coffee

This function allows you to use pre-ground and decaffeinated coffee.

With the pre-ground coffee function you can only brew one coffee at a time.

- 1 Press the “” button to select the pre-ground coffee function.
- 2 Lift the pre-ground coffee compartment lid and add one level measuring scoop of pre-ground coffee.  
Use only the measuring scoop supplied with the machine. Then close the pre-ground coffee compartment lid.
-  **Warning:**  
**Add only pre-ground coffee to the pre-ground coffee compartment. Other substances and objects may cause severe damage to the machine. Such damage will not be covered by warranty.**
- 3 Press the “” button for an espresso or the “” button for a coffee.  
The brewing cycle starts.
- 4 After the prebrewing cycle, coffee begins to pour out of the coffee dispensing spout.
- 5 Coffee brewing stops automatically when the set level is reached.  
However, it is possible to stop coffee brewing early by pressing the “” button.

After brewing, the machine returns to the main menu.

Repeat the steps described above to brew more cups of coffee using pre-ground coffee.



#### Note:

If no pre-ground coffee is poured into the pre-ground coffee compartment, only water will be dispensed.

If the dose is excessive or 2 or more scoops of pre-ground coffee are added, the machine will not brew the product and any ground coffee will be discharged into the coffee grounds drawer.

## FROTHING MILK AND PREPARING A CAPPUCCINO

### Frothing Milk



#### Note:

Depending on the machine model, the Automatic Milk Frother is provided either with or without chrome cover.

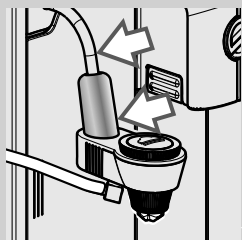

#### Warning:

**Danger of scalding! Dispensing may be preceded by small jets of hot water. When steam is used, the steam wand and the chrome cover (if any) may reach high temperatures. Never touch them with bare hands. The Automatic Milk Frother must be handled only as shown in the figure.**

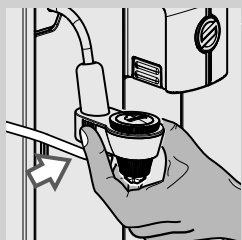



#### Note:

When preparing your cappuccino, use cold (~5°C / 41°F) milk with a protein content of at least 3% to ensure optimum results. Whole milk or skimmed milk may be used depending on individual taste.

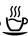

#### Note:

When you plan to froth milk right after turning on the machine or after brewing a coffee, any water still in the circuit may need to be dispensed first.

To do this, press the “” button and then the “” button to dispense steam for a few seconds. Thereafter press the “” button to stop dispensing and go to step 1.

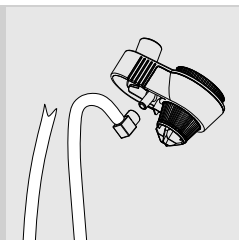

- 1** Insert the suction tube into the Automatic Milk Frother.

**For Automatic Milk Frother without chrome cover.**

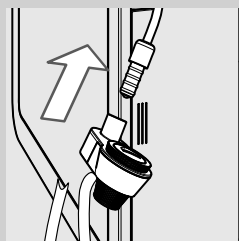

- 2** Insert the Automatic Milk Frother into the steam wand seat.

**For Automatic Milk Frother with chrome cover.**

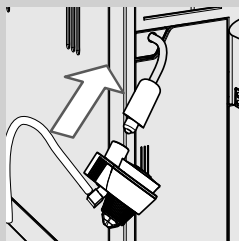

- 2** Insert the Automatic Milk Frother into the steam wand seat. Make sure that it is positioned correctly. If you cannot insert the Automatic Milk Frother, rotate the chrome cover. The Automatic Milk Frother is assembled correctly when the tooth fits into the slot.

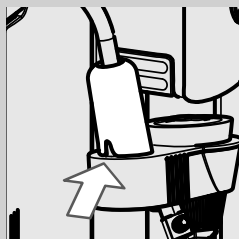

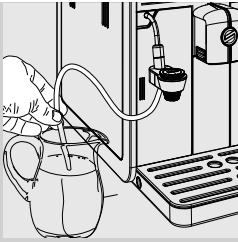

**3** Insert the suction tube into the milk container.



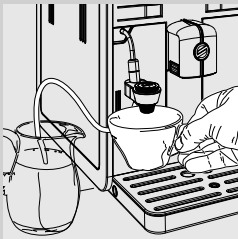

**Caution:**

**For hygienic reasons, make sure that the outer surface of the suction tube is clean.**

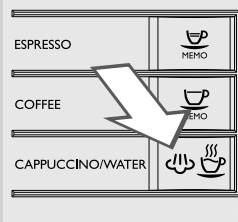

**4** Place a cup under the Automatic Milk Frother.



**5** Press the “” button. The machine shows this display.

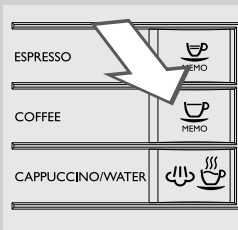

**6** Press the “” button to start frothing milk.

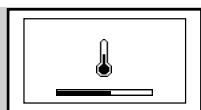

Yellow

- 7** This icon is displayed during the preheating time required by the machine.



Green

- 8** When this icon is displayed, the machine starts dispensing frothed milk directly into the cup.

- 9** Press the “” button to stop dispensing.

**Note:**

It will take a few seconds before the machine stops dispensing steam completely.



- 10** After use, store the suction tube as shown in the figure.

**Caution:**

**After frothing milk, a small quantity of hot water must be dispensed into a container. See the “Daily Cleaning of the Automatic Milk Frother” chapter for detailed cleaning instructions.**

**Note:**

It is possible to brew an espresso or dispense hot water straight after frothing milk.

---

**Brewing a Cappuccino**

To prepare a cappuccino, place a cup of frothed milk under the coffee dispensing spout and brew an espresso.

## DISPENSING HOT WATER



### Warning:

**Danger of scalding! Dispensing may be preceded by small jets of hot water. The steam wand and the chrome cover (if any) may reach high temperatures.**

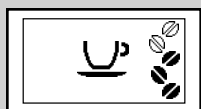

Green

Before dispensing hot water, make sure that the machine is ready to use and the water tank is filled.

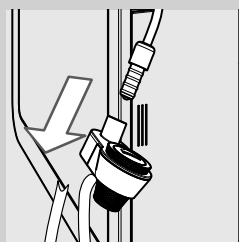

**1** Remove the Automatic Milk Frother from the steam wand.



**2** Place a container under the steam wand.



**3** Press the "☺☺☺" button. The machine shows this display.



Green

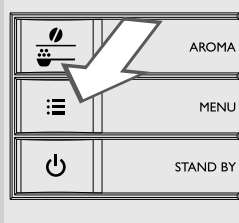

**4** Press the  **MENU** button to start dispensing hot water.

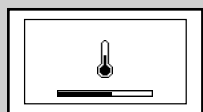

Yellow

**5** This icon is displayed during the preheating time required by the machine.



Green

**6** Dispense the desired amount of hot water. To stop dispensing hot water, press the  button.



## CLEANING AND MAINTENANCE

### Daily Cleaning of the Machine



#### Caution:

**Timely cleaning and maintenance of your machine is very important as it prolongs the life of your machine. The machine is continuously exposed to humidity, coffee and limescale!**

**The activities you need to perform and their frequency are described in detail in this chapter. Not doing this will ultimately make your machine stop working properly. This repair is NOT covered by warranty!**



#### Note:

- Use a soft, dampened cloth to clean the machine.
- Only the cup holder grill can be washed in the dishwasher. Any other components must be washed with lukewarm water.
- Do not immerse the machine in water.
- Do not use alcohol, solvents, and/or abrasive objects to clean the machine.
- Do not dry the machine and/or its components using a microwave and/or standard oven.

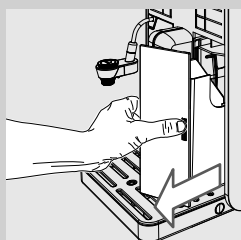
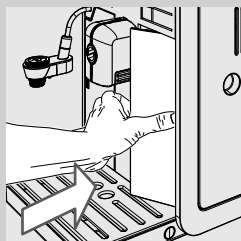

- 1** Empty and clean the coffee grounds drawer daily with the machine turned on.

- Press gently on the side of the coffee grounds drawer door to release the handgrip.
- Remove the coffee grounds drawer by pulling it by the handle.

Other maintenance operations can only be carried out when the machine is turned off and unplugged.

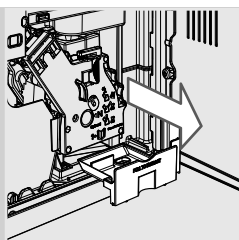

- 2** Empty and clean the coffee residues drawer located inside of the machine. Open the service door, remove the drawer and empty it.

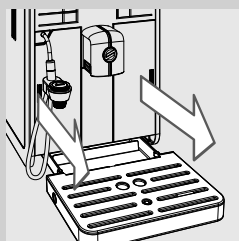

- 3** Empty and clean the drip tray.

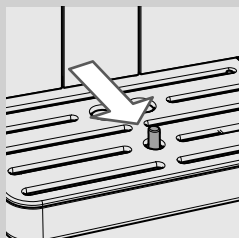

**Note:**

Empty and wash the drip tray also when the full drip tray indicator is raised.

### **Daily Cleaning of the Water Tank**

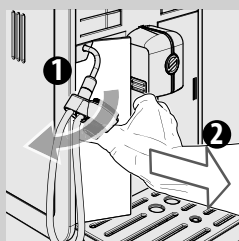

- 1** Remove the small white filter or the INTENZA+ water filter (if installed) from the water tank and wash it with fresh water.
- 2** Put the small white filter or the INTENZA+ water filter (if installed) back in its housing by gently pressing and turning it at the same time.
- 3** Fill the water tank with fresh water.

## Daily Cleaning of the Automatic Milk Frother

For hygienic reasons and to ensure a perfect frothed milk consistency, it is important that the Automatic Milk Frother be cleaned after each use.



**Warning:**

**Danger of scalding! Dispensing may be preceded by small jets of hot water.**

After frothing milk, you always need to:

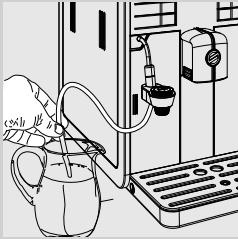

- 1** Insert the suction tube into a container filled with fresh water.

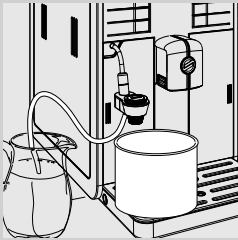

- 2** Place an empty container under the Automatic Milk Frother.



Green

- 3** Press the "☕" button. The machine shows this display.

- 4** Press the "MEMO" button to start dispensing steam.

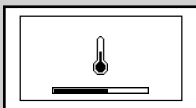

Yellow

- 5** This icon is displayed during the preheating time required by the machine.

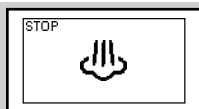

Green

**6** This icon will be displayed during the dispensing phase. Dispense water from the Automatic Milk Frother until clear water flows out. Press the “☺” button to stop dispensing.

**7** Clean the suction tube with a damp cloth.

### Weekly Cleaning of the Machine

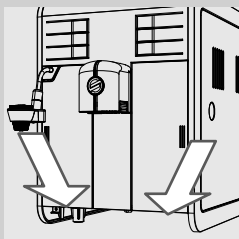

**1** Clean the seat of the drip tray.

### Weekly Cleaning of the Brew Group

The brew group should be cleaned every time the coffee bean hopper is filled or at least once a week.

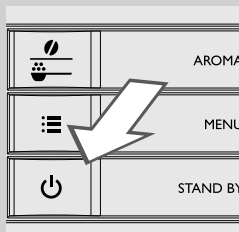

**1** Turn off the machine by pressing the “☺” button. Wait for the “☺” button to flash and unplug the power cord.

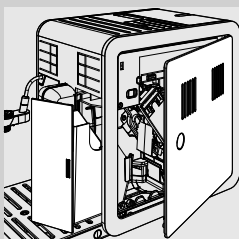

**2** Remove the coffee grounds drawer. Open the service door.

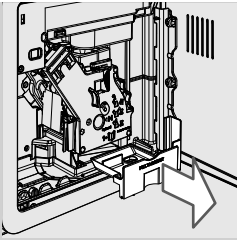

- 3** Remove and clean the coffee residues drawer.

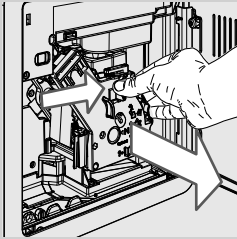

- 4** To remove the brew group, press the «PUSH» button and pull it by the handle.

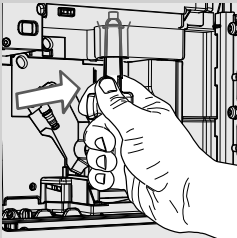

- 5** Thoroughly clean the coffee outlet duct with the special cleaning tool provided with the machine or with a spoon handle. Make sure that the cleaning tool is inserted as shown in the figure.

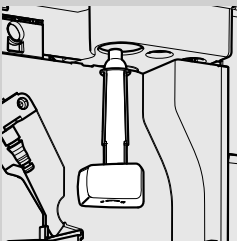

- 6** Thoroughly wash the brew group with lukewarm water and carefully clean the upper filter.

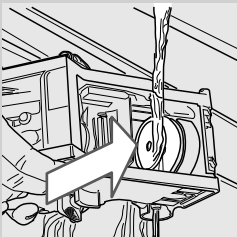

**!** **Caution:**  
Do not use detergent or soap to clean the brew group.

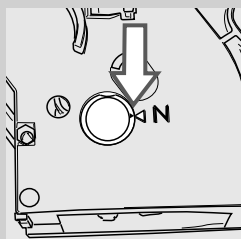

**7** Let the brew group air-dry thoroughly.

**8** Thoroughly clean the inside of the machine using a soft, dampened cloth.

**9** Make sure that the brew group is in the off position; the two reference marks must match. If they do not match, proceed as described in step (10).

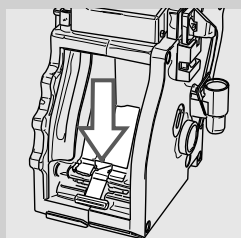

**10** Gently pull down the lever until it is in contact with the brew group base and the two reference marks on the side of the brew group match.

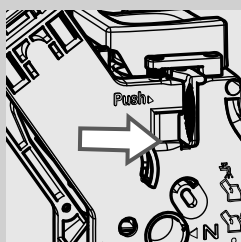

**11** Press the "PUSH" button firmly.

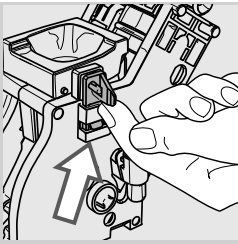

- 12** Make sure that the hook which locks the brew group is in the correct position. If it is still in the downward position, push it upward until it locks correctly into place.

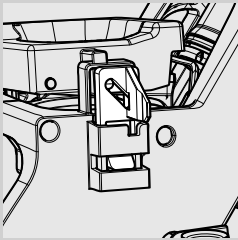

- 13** Insert the brew group back into its seat until it locks into place without pressing the "PUSH" button.

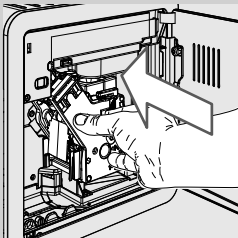

- 14** Insert the coffee residues drawer and close the service door.

- 15** Insert the coffee grounds drawer.

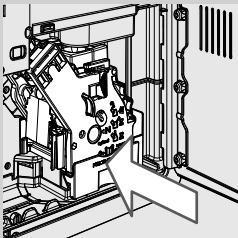

### Weekly Cleaning of the Coffee Bean Hopper, Tray and Coffee Compartment

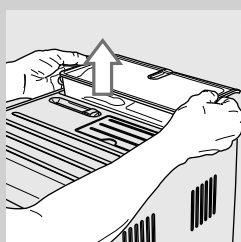

- 1** Remove the coffee bean hopper.

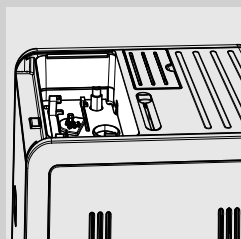

- 2** Clean the coffee bean hopper, tray and coffee compartment once a week with a cloth to remove any coffee residues and dust.

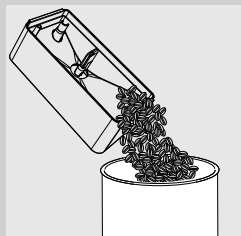

- 3** Empty any beans out of the coffee bean hopper.

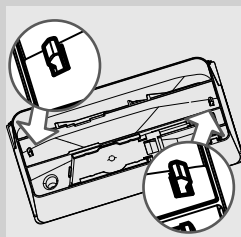

- 4** To remove the tray, press on the hooks on the bottom of the coffee bean hopper as shown in the figure above.

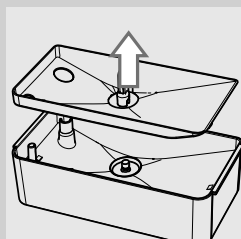

- 5** Remove the tray. Clean the tray and the coffee bean hopper with a cloth.



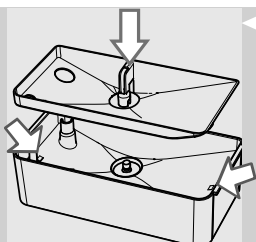

- 6** After cleaning, insert the tray back into the coffee bean hopper. Insert the tray hooks into their seats on the coffee bean hopper.

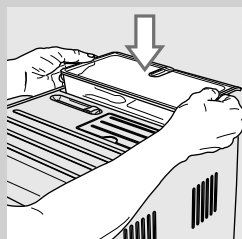

- 7** Insert the coffee bean hopper into the compartment.

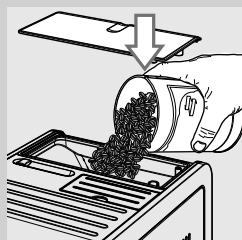

- 8** Slowly pour in the coffee beans. Place the lid.

### Monthly Lubrication of the Brew Group

Lubricate the brew group after approximately 500 cups of coffee or once a month.

You can purchase the Saeco grease to lubricate the brew group separately. For further details, please refer to the maintenance products page in this user manual.



#### Caution:

**Before lubricating the brew group, clean it with lukewarm water and let it dry, as described in the “Weekly Cleaning of the Brew Group” chapter.**

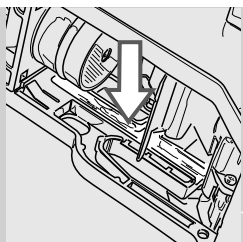

**1** Apply the grease evenly on both side guides.

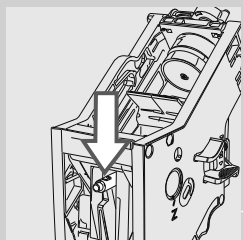
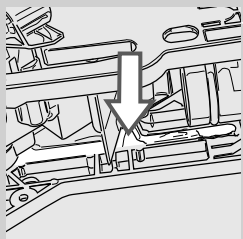

**2** Also lubricate the shaft.

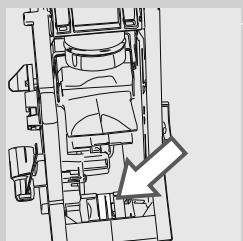

**3** Insert the brew group into its seat until it locks into place (see the "Weekly Cleaning of the Brew Group" chapter). Insert the coffee residues drawer.

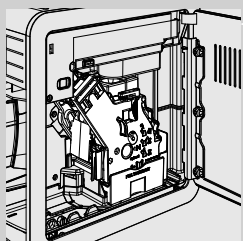

**4** Close the service door. Insert the coffee grounds drawer.

## Monthly Cleaning of the Automatic Milk Frother



Every month you need to perform a more thorough cleaning of the Automatic Milk Frother using the "Saeco Milk Circuit Cleaner". The "Saeco Milk Circuit Cleaner" can be purchased separately. For further details, please refer to the maintenance products page in this user manual.



### Warning:

**Danger of scalding! Dispensing may be preceded by small jets of hot water.**



**1** Make sure that the Automatic Milk Frother is correctly installed.

**2** Pour the Saeco Milk Circuit Cleaner into a container. Add ½ litre of lukewarm water and wait for the product to dissolve completely.

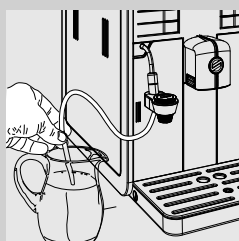

**3** Insert the suction tube into the container.

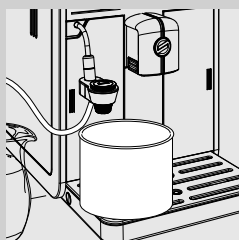

**4** Place a large container (1.5 l) under the Automatic Milk Frother.



Green

**5** Press the "☕" button. The machine shows this display.

**6** Press the "MEMO" button to dispense steam.

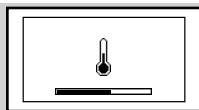

Yellow

- 7** This icon is displayed during the preheating time required by the machine.



Green

- 8** This icon will be displayed during dispensing. When the solution has been completely dispensed, press the "MEMO" button to stop dispensing.

**Warning:**

**Never drink the solution dispensed during this step.**



- 9** Rinse the container thoroughly and fill it with ½ litre of fresh water to be used for the rinse cycle.

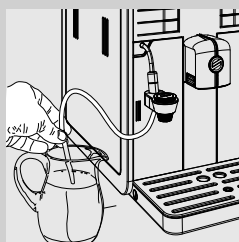

- 10** Insert the suction tube into the container.

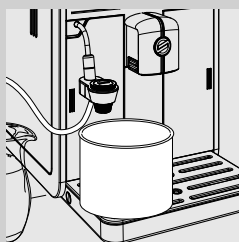

- 11** Empty the container and place it back under the Automatic Milk Frother.



Green

**12** Press the "☁☕" button. The machine shows this display.

**13** Press the "☕  
MEMO" button to dispense steam.

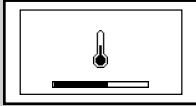

Yellow

**14** This icon is displayed during the preheating time required by the machine.



Green

**15** This icon will be displayed during dispensing. When the water has been completely dispensed, press the "☕  
MEMO" button to stop dispensing.

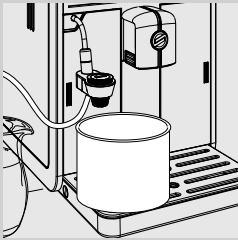

**16** Empty the container.



**Caution:**  
Let the steamwand cool down for a few minutes.

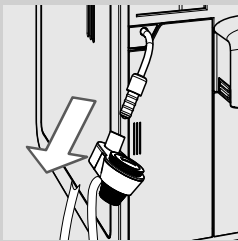

**17** Remove the Automatic Milk Frother from the machine.

**For Automatic Milk Frother without chrome cover.**

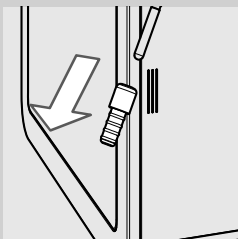

**18** Remove the rubber fitting from the steam wand.

**For Automatic Milk Frother with chrome cover.**

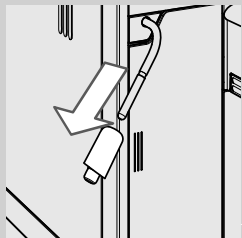

- 18** Remove the chrome cover with the rubber fitting. Remove the rubber fitting from the cover.

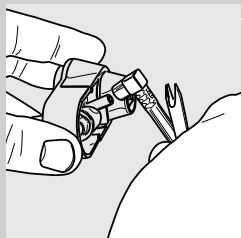
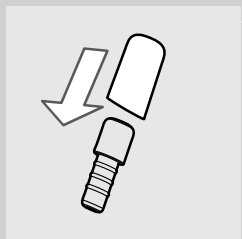

- 19** Remove the suction tube.

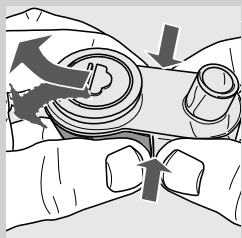

- 20** Press the sides and disassemble the Automatic Milk Frother as shown in the figure.

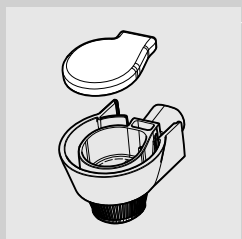

- 21** Remove the rubber lid as shown in the figure.

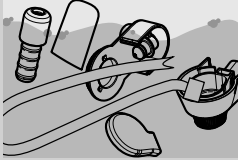

**22** Wash all the components with lukewarm water.

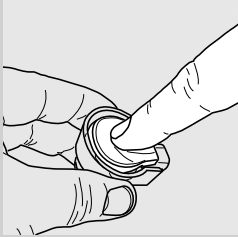

**23** Reassemble the lid making sure that you press it in the middle to have it correctly inserted.

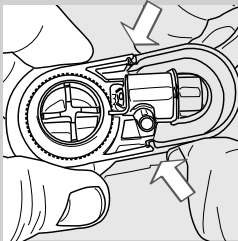

**24** Reassemble the Automatic Milk Frother making sure it is correctly inserted.

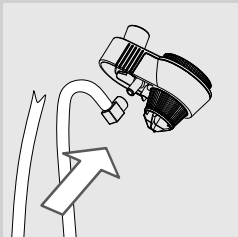

**25** Install the suction tube.

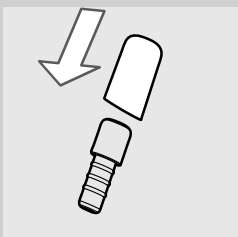

**26** Insert the rubber fitting into the chrome cover (only for Automatic Milk Frother with chrome cover).

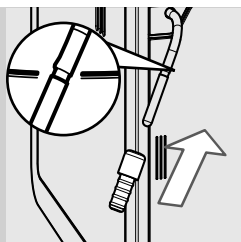

- 27** Insert the rubber fitting back and the chrome cover (if any) on the steam wand.

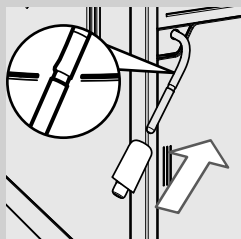

**Warning:**

**The tube and the chrome cover (if any) may be hot if they have recently been used!**

**Do not insert the rubber fitting beyond the position shown. In this case, the Automatic Milk Frother would not work correctly as it would not be able to draw up milk.**

**For Automatic Milk Frother without chrome cover.**

- 28** Fully insert the Automatic Milk Frother into the rubber fitting.

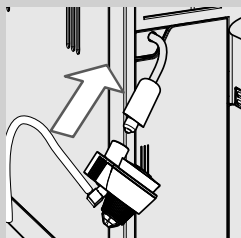
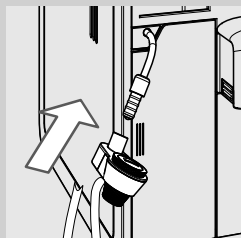

**For Automatic Milk Frother with chrome cover.**

- 28** Insert the Automatic Milk Frother. Make sure that it is positioned correctly. If you cannot insert it, rotate the chrome cover. The Automatic Milk Frother is assembled correctly when the tooth fits into the slot.

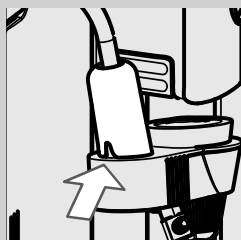



### Monthly Cleaning of the Brew Group with "Coffee Oil Remover"



Besides weekly cleaning, we recommend performing a cleaning cycle with "Coffee Oil Remover" after approximately 500 cups of coffee or once a month. This operation completes the maintenance process for the brew group.

You can purchase the "Coffee Oil Remover" separately. For further details, please refer to the maintenance products page in this user manual.



#### Caution:

**The "Coffee Oil Remover" tablets are to be used for cleaning only and do not have a descaling function. For descaling, use the Saeco descaling solution and follow the procedure described in the "Descaling" chapter.**

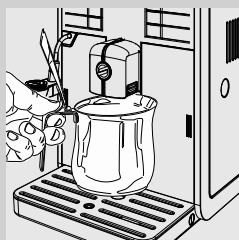

- 1 Place a container under the coffee dispensing spout.

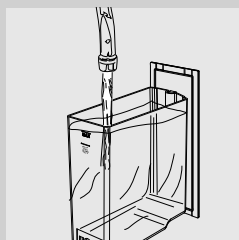

- 2 Make sure the water tank is filled with fresh water up to the "MAX" level.

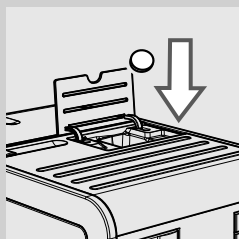

- 3 Put a "Coffee Oil Remover" tablet in the pre-ground coffee compartment.

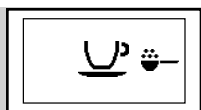

Green

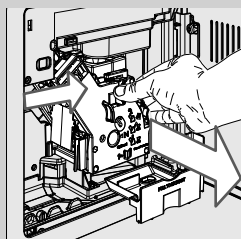
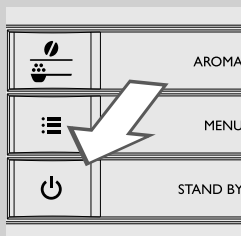
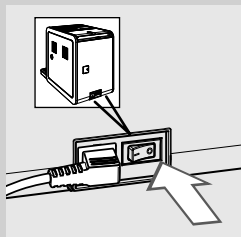

**4** Press the “☕” button one or more times to select the pre-ground coffee function. Do not add ground coffee.

**5** Press the “MEMO” button to start a coffee brewing cycle.

**6** Wait until the machine has dispensed half a cup of water.

**7** Switch the power button on the back of the machine to “0”.

**8** Let the solution take effect for about 15 minutes. Make sure you discard the dispensed water.

**9** Switch the power button on the back of the machine to “I”. To turn on the machine, press the “⏻” button. Wait until the end of the automatic rinse cycle.

**10** Remove the coffee grounds drawer and open the service door. Remove the coffee residues drawer and then the brew group.

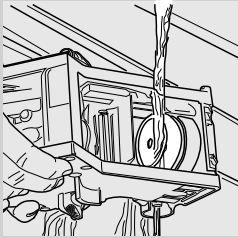

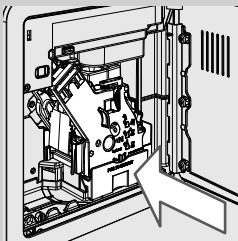

- 11** Wash the brew group thoroughly with fresh water.



- 12** After rinsing the brew group, insert it back into its seat until it locks into place (see the “Weekly Cleaning of the Brew Group” chapter). Insert the coffee residues drawer and the coffee grounds drawer. Close the service door.



Green

- 13** Press the “” button to select the pre-ground coffee function. Do not add any coffee to the pre-ground coffee department.
- 14** Press the “” button to start a coffee brewing cycle.
- 15** Repeat steps 13 to 14 twice. Empty the container.
- 16** To clean the drip tray, place a “Coffee Oil Remover” tablet inside and fill it 2/3rds full with hot water. Let the cleaning solution take effect for about 30 minutes, then rinse thoroughly.

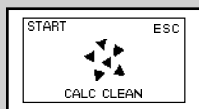
**DESCALING**

Yellow

When the "CALC CLEAN" icon is displayed, you need to descale the machine.

The descaling cycle takes approx. 30 minutes.

**Caution:**

**Not doing this will ultimately make your machine stop working properly. In this case, repair is NOT covered by warranty.**

**Warning:**

**Use the Saeco descaling solution only. Its formula has been designed to ensure better machine performance. The use of other products may damage the machine and leave residues in the water.**

The Saeco descaling solution can be purchased separately. For further details, please refer to the maintenance products page in this user manual.

**Warning:**

**Never drink the descaling solution or any products dispensed until the cycle has been carried out to the end. Never use vinegar as a descaling solution.**

**Note:**

Do not remove the brew group during the descaling process.

To perform the descaling cycle, follow the steps below.

Before descaling:

- 1** Empty the drip tray.

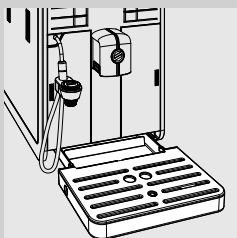



- 2** Remove the Automatic Milk Frother from the steam/hot water wand.

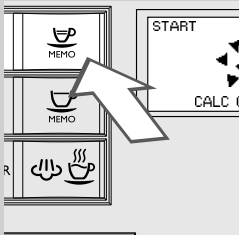
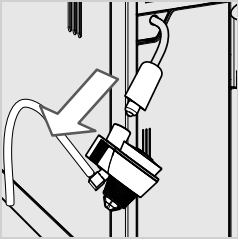

- 3** Press the "MEMO" button.



**Note:**

If you press the "MEMO" button by mistake, press the "CALC" button to quit.

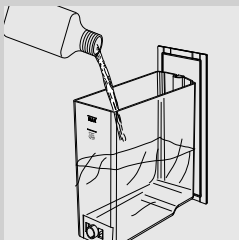

- 4** Remove the "INTENZA+" water filter (if any) from the water tank and replace it with the small white original one. Pour all the descaling solution into the water tank.

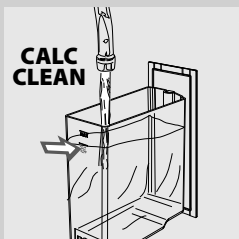

- 5** Fill the water tank with fresh water up to the CALC CLEAN level and put it back into the machine.

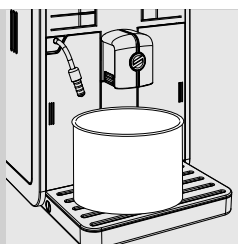

- 6** Place a large container (1.5 l) under both the steam/hot water wand and the coffee dispensing spout.

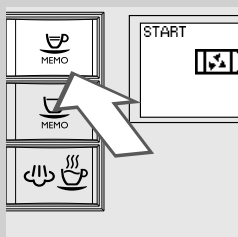

- 7** Press the “” button to start the descaling cycle.

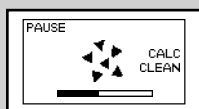

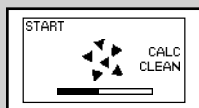

Yellow

- 8** The machine starts dispensing the descaling solution at regular intervals for about 20 minutes. The bar on the control panel shows the cycle progress.

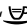

Yellow

**Note:**

The descaling cycle may be paused by pressing the “” button. To resume the cycle, press the “” button again. This allows you to empty the container or to leave the machine unattended for a short time.

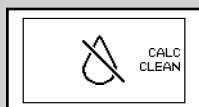

Red

- 9** When this icon is displayed, the water tank is empty.

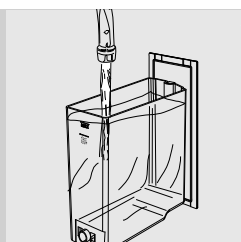

- 10** Rinse the water tank and fill it with fresh water up to the MAX level. Put it back into the machine.

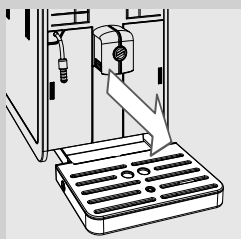

- 11** Empty the drip tray and place it back.

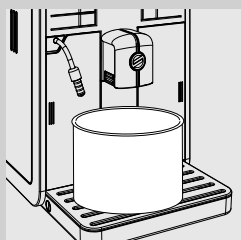

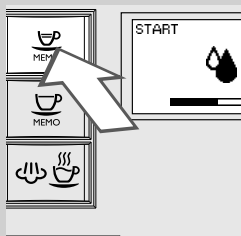

- 12** Empty the container and place it back.



- 13** Press the “” button to start the rinse cycle.



**Note:**

The rinse cycle may be paused by pressing the “” button. To resume the cycle, press the “” button again. This allows you to empty the container or to leave the machine unattended for a short time.

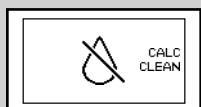

Red

- 14** When this icon is displayed, the water tank is empty.

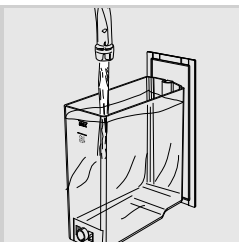

- 15** Rinse the water tank and fill it with fresh water up to the MAX level. Put it back into the machine. Repeat step 13.



Green

- 16** When the amount of water needed for the rinse cycle has been completely dispensed, this icon is displayed. Press the "0" button to quit the descaling cycle.

**Note:**

If you had not filled up the water tank to MAX level, the machine might require to refill the tank to complete the rinsing cycle. Refill the water tank and put it back into the machine. Repeat from step 13.

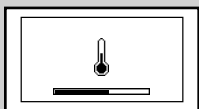

Yellow

- 17** The machine warms up and performs the automatic rinse cycle.

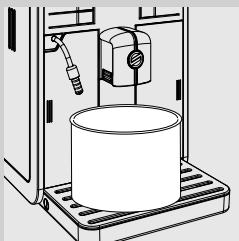

- 18** Empty the container.



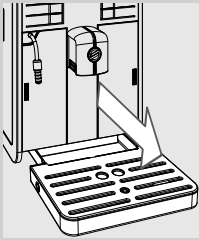

- 19** At the end of the rinse cycle, empty the drip tray and place it back.

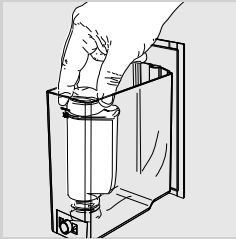

- 20** Remove the small white filter and place the "INTENZA+" water filter into the water tank if it was installed.

**For Automatic Milk Frother without chrome cover.**

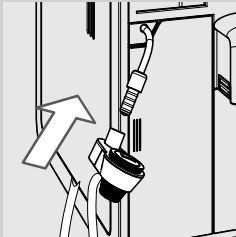

- 21** Fully insert the Automatic Milk Frother into the rubber fitting.

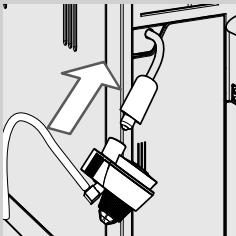

**For Automatic Milk Frother with chrome cover.**

- 21** Insert the Automatic Milk Frother. Make sure that it is positioned correctly. If you cannot insert the Automatic Milk Frother, rotate the chrome cover. The Automatic Milk Frother is assembled correctly when the tooth fits into the slot.

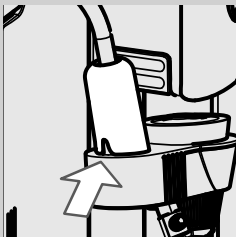

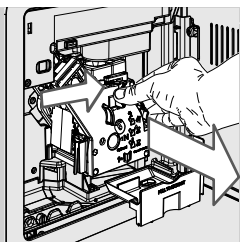

- 22** Clean the brew group. For more details, please see the “Weekly Cleaning of the Brew Group” chapter.



- 23** The machine is ready to brew coffee.

### ACCIDENTAL INTERRUPTION OF THE DESCALING CYCLE

Once you have started the descaling cycle, you must complete it till the very end without turning off the machine. If the descaling process is accidentally interrupted (power failure or accidental disconnection of the power cord), follow the steps below.

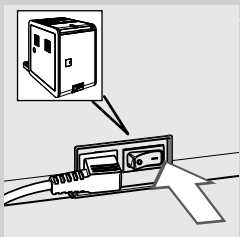

- 1** Make sure that the power button is on "I".

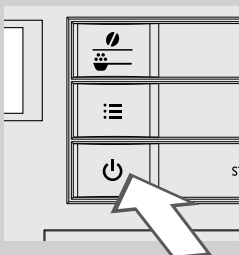

- 2** Press the “” button to turn on the machine.

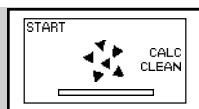

Yellow

- 3** If the cycle was interrupted during the descaling phase, it will be resumed from step 8 of the "Descaling" chapter. Press the "MEMO" button to restart the cycle.



Yellow

- 4** If the cycle was interrupted during the rinse phase, it will be resumed from step 13 of the "Descaling" chapter. Press the "MEMO" button to restart the cycle.

## PROGRAMMING

You can customise the machine's functions via the programming menu.

### The following settings can be adjusted



Yellow

#### Coffee Temperature

This function allows you to adjust the coffee brewing temperature.

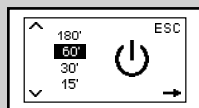

Yellow

#### Timer (stand-by)

This function allows you to adjust the time taken for the machine to go into stand-by mode after the last brewing.

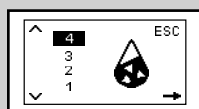

Yellow

#### Water Hardness

This function allows you to adjust the water hardness setting according to the area where you live.

- 1 = very soft water
- 2 = soft water
- 3 = hard water
- 4 = very hard water

For more details, please see the "Measuring and Programming Water Hardness" chapter.

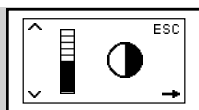

Yellow

**Contrast**

This function allows you to adjust the contrast of the display to better view the messages.

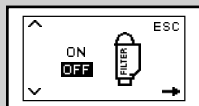

Yellow

**"INTENZA+" Water Filter**

This function allows you to manage the "INTENZA+" water filter. For more details, see the chapter related to filter handling.

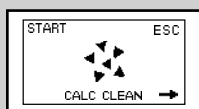

Yellow

**Descaling Cycle**

This function allows you to run the descaling cycle.



Yellow

**Coffee Bean Selection**

This function allows you to optimize grinding according to the selected type of coffee beans.

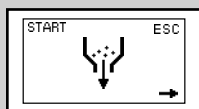

Yellow

**Coffee Outlet Duct Emptying Cycle**

This function allows you to empty the coffee outlet duct and grinder before changing coffee beans.



Yellow

**Factory Settings**

This function allows you to reset all factory values.

## How to Program the Machine

This example shows how to set the coffee temperature. Proceed in the same way to program the other functions. The programming menu can only be accessed when the machine is on and shows this display.



Green

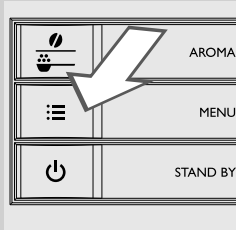

- 1 Press the "☰" button to access the menu.

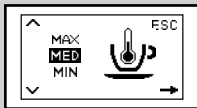

Yellow

- 2 The main screen will be displayed.

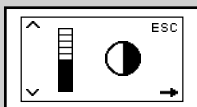
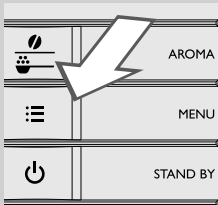

Yellow

- 3 Press the "☰" MENU button to scroll the options until the display contrast function is displayed.

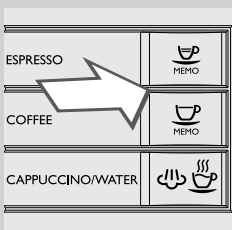

- 4 Press the "☺" and "☹" buttons to increase or decrease the value of the function.

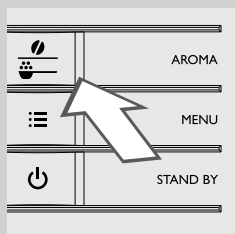
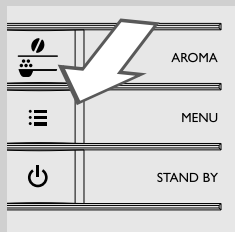
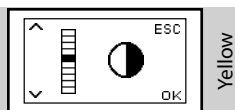

- 5** Once the value has been changed, the "OK" message appears. Press the "☰" **MENU** button to confirm the change.

- 6** Press the "☰" button to exit the programming menu.



**Note:**

The machine automatically exits the programming menu if no button is pressed for 3 minutes. The values that have been changed but not confirmed will not be saved.

## MEANING OF THE DISPLAY ICONS

This machine is equipped with a colour-coded system to make the user's understanding of the display signals easier.  
The icons are colour-coded according to the traffic light principle.

### Ready Signals (Green Colour)



The machine is ready to brew coffee using Arabica coffee beans.



The machine is ready to brew coffee using Robusta coffee beans.



The machine is ready to brew coffee using Mixed coffee beans.

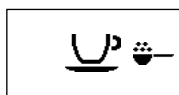

The machine is ready to brew pre-ground coffee.



Steam or hot water selection.



Hot water dispensing.



Steam dispensing.



The machine is brewing one cup of espresso.



The machine is brewing one cup of coffee.

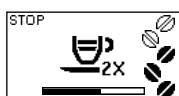

The machine is brewing two cups of espresso.

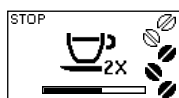
**Ready Signals (Green Colour)**

The machine is brewing two cups of coffee.

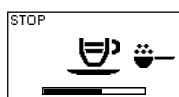

Espresso brewing using pre-ground coffee in progress.



Coffee brewing using pre-ground coffee in progress.

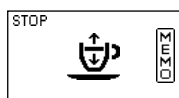

The machine is programming the amount of coffee to be brewed.

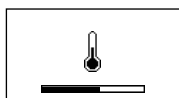

The machine is warming up to brew beverages or dispense hot water.



# **Warning Signals (Yellow Colour)**

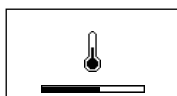

The machine is warming up.



The machine is performing a rinse cycle. Wait until the machine has completed the cycle.

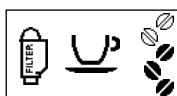

The machine needs the "INTENZA+" water filter to be replaced.



The brew group is being reset due to machine reset.

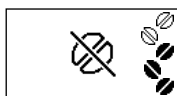

Fill the coffee bean hopper with coffee beans and restart the cycle.

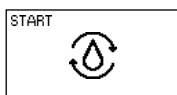

Prime the circuit.

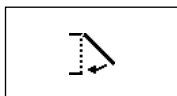

You need to descale the machine. Press the "MEMO" button to start the descaling process. Follow the steps described in the "Descaling" chapter of this manual. If you want to descale the machine later, press the "MEMO" button to continue using the machine.  
Please note that not descaling your machine will ultimately make it stop working properly. In this case, repair is NOT covered under your warranty.

**Warning Signals (Red Colour)**

Close the service door.

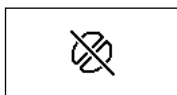

Fill the coffee bean hopper.



The brew group must be inserted into the machine.

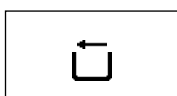

Insert the coffee grounds drawer.



Empty the coffee grounds drawer and the coffee residues drawer.

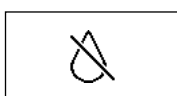

Fill the water tank.

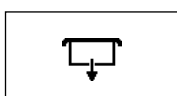

Insert the coffee bean hopper.

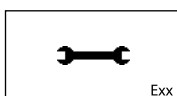

Exx

The machine is out of order. The error code is displayed in the right bottom corner. For error codes 1 -3 - 4 - 5, please refer to the "Troubleshooting" chapter. For any other error codes, follow the instructions below:  
Turn off the machine. Turn it back on after 30 seconds. Try this 2 or 3 times.  
If the machine does not start, contact the Philips SAECO hotline in your country and quote the error code shown on the display.  
Contact details can be found in the warranty booklet packed separately or at [www.saeco.com/support](http://www.saeco.com/support).

## TROUBLESHOOTING

This chapter summarizes the most common problems you could encounter with your machine.

If you are unable to solve the problem with the information below, visit **[www.saeco.com/support](http://www.saeco.com/support)** for a list of frequently asked questions or contact the Philips Saeco hotline in your country.

Contact details can be found in the warranty booklet packed separately or at **[www.saeco.com/support](http://www.saeco.com/support)**.

Machine actions	Causes	Solutions
Error Code 1 Coffee grinder blocked.	Coffee outlet duct clogged.	Thoroughly clean the coffee outlet duct as described in the "Weekly Cleaning of the Brew Group" chapter.
Error Code 3-4 Brew group blocked, cannot be pulled out.	The brew group is out of place.	Close the service door. Turn off and back on the machine. The brew group automatically returns to the initial position.
Error Code 5 Water circuit error.	Air in the water circuit.	Remove and put back the water tank a few times, making sure it is properly reinserted. Check that the water tank compartment is clean.  If the Intenza+ filter is installed, remove it. Turn off and back on the machine. Thereafter place the filter back.

Machine actions	Causes	Solutions
The machine does not turn on.	The machine is not connected to the electric network.	Connect the machine to the electric network.
	The power button is on position "0".	Check that the power button is set to "I".
The drip tray gets filled although no water is drained.	Water is sometimes drained automatically by the machine into the drip tray to manage the rinsing of the circuits and ensure optimum machine performance.	This is a normal behaviour of the machine.
The red  icon is always displayed on the machine.	The coffee grounds drawer has been emptied with the machine off.	The coffee grounds drawer must always be emptied with the machine on. Wait until the  icon is displayed before refitting the drawer.
Coffee is not hot enough.	The temperature is not correctly set.	Set the temperature as described in the "Programming" chapter.
	The cups are cold.	Preheat the cups with hot water.
No hot water or steam is dispensed.	The hole of the steam/hot water wand is clogged.	Clean the hole of the steam wand using a pin. <b>Make sure that the machine is off and has cooled down before performing this operation.</b>
Coffee does not have enough crema (see note*).	The blend is unsuitable, coffee is not freshly roasted or the grind is too coarse.	Change coffee blend or adjust grinding as explained in the "Adjusting the Ceramic Coffee Grinder" chapter.
The brew group cannot be removed.	The brew group is out of place.	Turn on the machine. Close the service door. The brew group automatically returns to the initial position.
	The coffee grounds drawer is inserted.	Remove the coffee grounds drawer before removing the brew group.
The brew group cannot be inserted.	The brew group is not in the off position.	Make sure that the brew group is in the off position, as described in the "Weekly Cleaning of the Brew Group" chapter.
	The gearmotor is not in the correct position.	Insert the drip tray and the coffee grounds drawer. Close the service door. Turn on the machine without inserting the brew group. The gearmotor moves back to the correct position. Turn off the machine and reinsert the brew group as described in the "Weekly Cleaning of the Brew Group" chapter.
There is a lot of ground coffee under the brew group.	Coffee is not suitable for automatic machines.	It may be necessary to change the type of coffee or the coffee grinder settings.

Machine actions	Causes	Solutions
The machine grinds the coffee beans but no coffee is brewed (see note).	The brew group is dirty.	Clean the brew group (see the "Weekly Cleaning of the Brew Group" chapter).
	This might occur when the machine is automatically adjusting the dose.	Brew some cups of coffee as described in the "Saeco Adapting System" chapter.
	The circuit is not primed.	Prime the circuit (see the "Using the Machine for the First Time" chapter).
	The coffee dispensing spout is dirty.	Clean the coffee dispensing spout.
Coffee is too weak (see note).	This might occur when the machine is automatically adjusting the dose.	Brew some cups of coffee as described in the "Saeco Adapting System" chapter.
	Coffee is too coarse.	Change coffee blend or adjust grinding as explained in the "Adjusting the Ceramic Coffee Grinder" chapter.
	The coffee bean hopper selector switch has been shifted.	Move the selector switch to the "1" position.
Coffee is brewed slowly (see note).	The coffee grind is too fine.	Change coffee blend or adjust grinding as explained in the "Adjusting the Ceramic Coffee Grinder" chapter.
	The circuit is not primed.	Prime the circuit (see the "Using the Machine for the First Time" chapter).
	The brew group is dirty.	Clean the brew group (see the "Weekly Cleaning of the Brew Group" chapter).
Coffee leaks out of the coffee dispensing spout.	The coffee dispensing spout is clogged.	Clean the coffee dispensing spout and its holes.
The selector switch is blocked.	Some coffee beans may have got stuck.	Move the selector switch back and forth until the coffee beans are released.
The coffee bean hopper cannot be inserted.	The blade under the coffee bean hopper has been shifted.	Slide the blade up to the end of the guide until the hole is covered.
	There might still be some coffee beans in the coffee compartment.	Remove coffee beans.
	The selector switch is not in the correct position.	Shift the selector switch to the open position.
Coffee does not taste like the new coffee beans.	The coffee outlet duct and grinder have not been emptied.	You need to brew at least two cups of coffee before you can taste the new coffee beans.
Milk does not froth.	The Automatic Milk Frother is inserted too deep. No milk is being suctioned.	Leave the Automatic Milk Frother to cool down. Move it slightly downwards. Reposition it in its correct seat.

Machine actions	Causes	Solutions
Frothed milk is too cold.	The cups are cold.	Preheat the cups with hot water.
The ☒ icon is displayed.	The coffee bean hopper selector switch has been shifted.	Move the selector switch to the "☒" position.
	The coffee bean hopper and tray are dirty.	Clean the coffee bean hopper and tray to remove any coffee residues (see the "Weekly Cleaning of the Coffee Bean Hopper, Tray and Coffee Compartment" chapter).
The machine is in demo mode.	The "☐" button was pressed and held for more than 8 seconds.	Turn the machine off and on again using the power button.

**Note:**

These problems can be considered normal if the coffee blend has been changed or if the machine has just been installed. In this case, wait until the machine performs a self-adjusting operation as described in the "Saeco Adapting System" section.

## ENERGY SAVING

### Stand-by

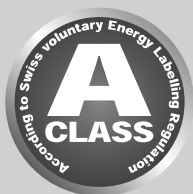

The Saeco fully automatic espresso coffee machine is designed for energy saving, as proven by the Class A energy label.

After 15 minutes of inactivity, the machine turns off automatically (unless a different stand-by time has been programmed). If a product has been brewed, the machine performs a rinse cycle.

In stand-by mode, the energy consumption is below 1Wh.

To turn on the machine, press the "☐" button (if the power button on the back of the machine is set to "I"). If the boiler is cold, the machine performs a rinse cycle.

## TECHNICAL SPECIFICATIONS

The manufacturer reserves the right to make changes to the technical specifications of the product.

Nominal Voltage - Power Rating - Power Supply	See data plate on the inside of the service door
Housing material	ABS - Thermoplastic
Size (w x h x d)	256 x 350 x 470 mm
Weight	8.5 kg
Power cord length	800 - 1200 mm
Control panel	Front panel
Cup size	142
Water tank	1.9 litres - Removable type
Coffee bean hopper capacity	300 g
Coffee grounds drawer capacity	14
Pump pressure	15 bar
Boiler	Stainless Steel
Safety devices	Thermal fuse

## WARRANTY AND SERVICE

### Warranty

For detailed information on your warranty and related conditions, please read the warranty booklet supplied separately.

### Service

We want to ensure that you remain satisfied with your machine. If you have not already done so, please register your purchase on **[www.saeco.com/welcome](http://www.saeco.com/welcome)**. This will allow us to stay in contact with you and send you cleaning and descaling reminders.

For service or support, please visit the Philips website at **[www.saeco.com/support](http://www.saeco.com/support)** or contact the Philips Saeco hotline in your country. Contact details can be found in the warranty booklet packed separately or at **[www.saeco.com/support](http://www.saeco.com/support)**.

**ORDERING MAINTENANCE PRODUCTS**

For cleaning and descaling, use Saeco maintenance products only. You can purchase the products at the Philips online shop at [www.shop.philips.com/service](http://www.shop.philips.com/service), from your local dealer or at authorised service centres.

If you have any difficulties obtaining maintenance products for your machine, please contact the Philips Saeco hotline in your country.

Contact details can be found in the warranty booklet packed separately or at [www.saeco.com/support](http://www.saeco.com/support).

Overview of maintenance products



- Descaling solution CA6700



- INTENZA+ Water Filter CA6702



- Grease HD5061





- Coffee Oil Remover CA6704



- Milk Circuit Cleaner: CA6705



- Maintenance Kit CA6706

## MACHINE ACCESSORIES

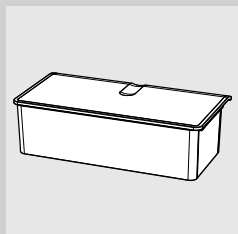

- Removable coffee bean hopper CA6803

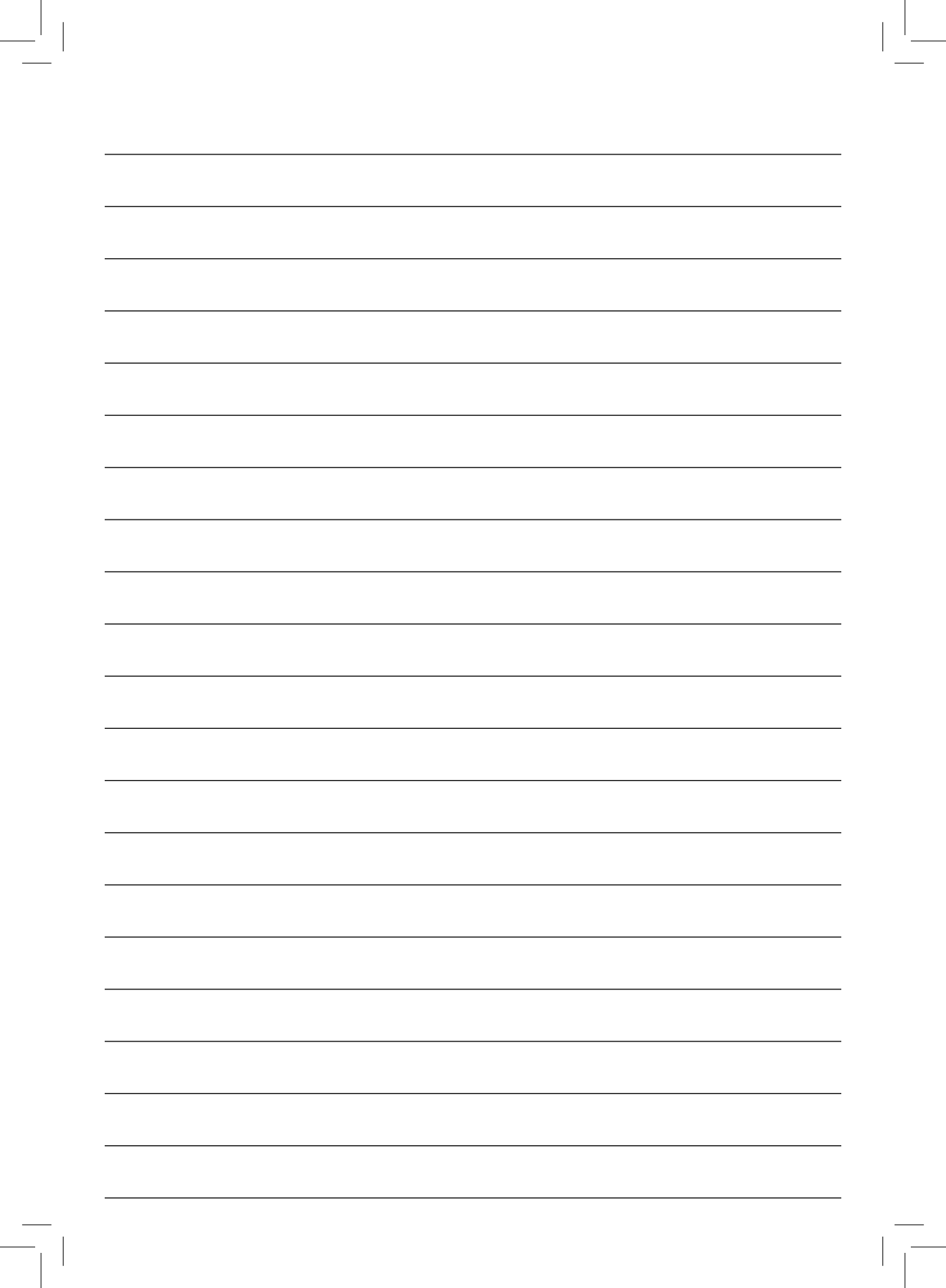

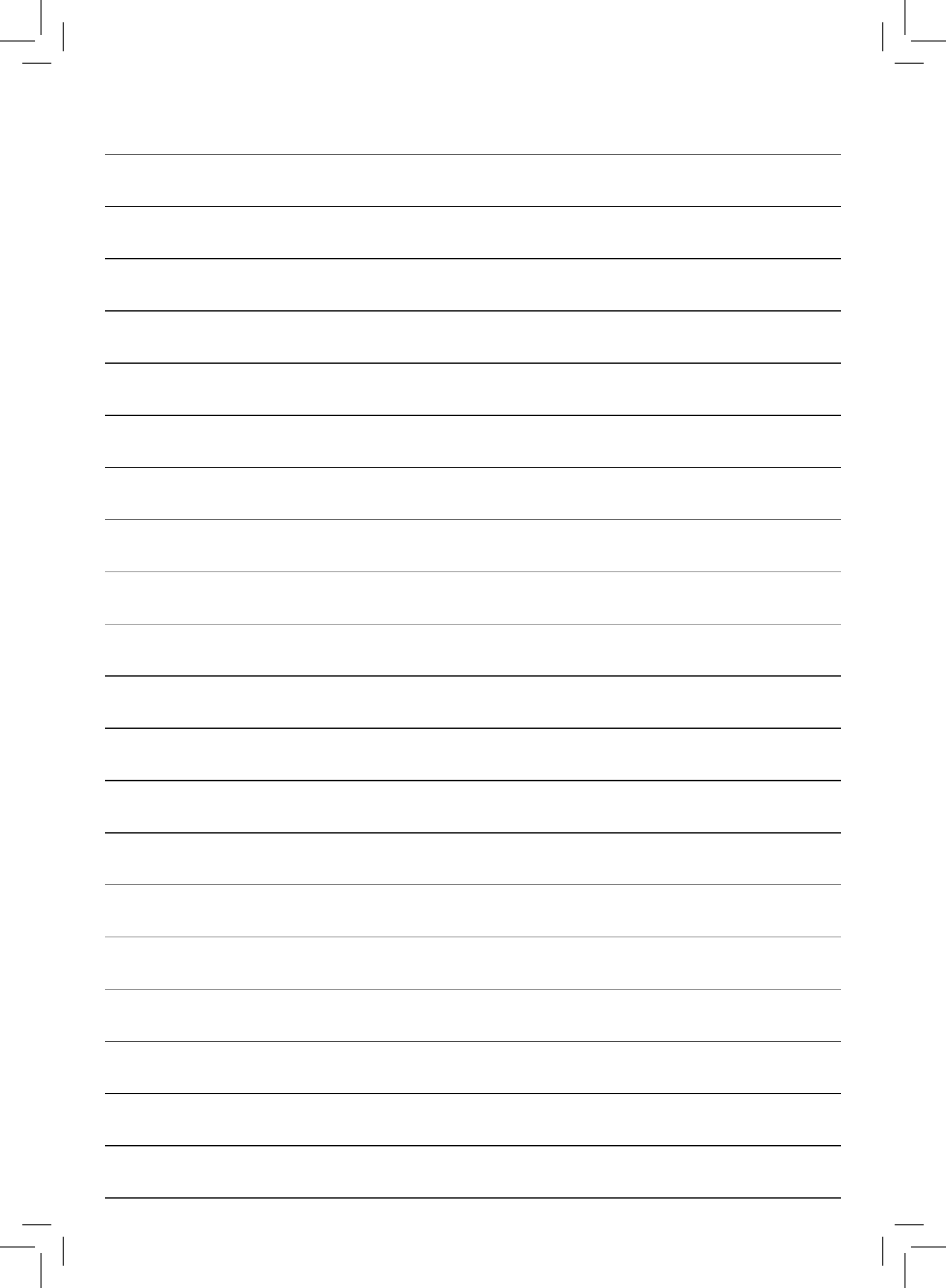



421946012191

The manufacturer reserves the right to make changes without prior notice.



[www.philips.com/saeco](http://www.philips.com/saeco)