

PHILIPS

DailyClean

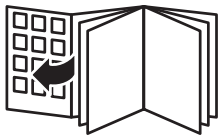

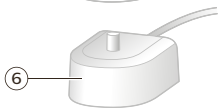

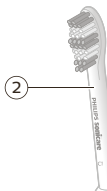

English 6
简体中文 20

Introduction

Congratulations on your purchase and welcome to Philips! To fully benefit from the support that Philips offers, register your product at www.philips.com/welcome.

Important safety information

Read this important information carefully before you use the appliance and save it for future reference.

Note: The accessories and features of different models vary. For example, some models come with a sanitizer or are equipped with Bluetooth.

DANGER

- Keep the charger and/or sanitizer away from water. Do not place or store the appliance where it can fall or be pulled into a tub or sink.
- Do not immerse the charger and/or sanitizer in water or any other liquid.
- After cleaning, make sure the charger and/or sanitizer is completely dry before you connect it to the wall socket.

WARNINGS

- This appliance can be used by children and persons with reduced physical, sensory or mental capabilities or lack of experience and knowledge if they have been given supervision or instruction concerning use of the appliance in a safe way and understand the hazards involved. Cleaning and user maintenance shall not be made by children without supervision.
- Children shall not play with the appliance.

- If the appliance is damaged in any way (brush head, toothbrush handle, charger and/or sanitizer), stop using it.
- The mains cord cannot be replaced. If the mains cord is damaged, discard the charger and/or sanitizer.
- Always replace the charger and/or sanitizer with one of the original type in order to avoid a hazard.
- To recharge the battery with the travel case, only use the detachable USB cable and wall adapter if provided with this appliance.
- This appliance contains no user-serviceable parts. If the appliance is damaged, contact the Consumer Care Center in your country (see 'Warranty and support').
- Keep the cord away from heated surfaces.
- Do not use the charger and/or sanitizer outdoors or near heated surfaces.

CAUTION

- Do not clean the brush head, handle, charger, charger cover or sanitizer in the dishwasher.
- If you have had oral or gum surgery in the previous 2 months, consult your dentist before you use this appliance.
- Consult your dentist if excessive bleeding occurs after using this appliance or if bleeding continues to occur after 1 week of use. Also consult your dentist if you experience discomfort or pain when you use this appliance.
- This Philips appliance complies with the safety standards for electromagnetic devices. If you have a pacemaker or other implanted device, contact your doctor or the appliance manufacturer of the implanted appliance prior to use.

- If you have medical concerns, consult your doctor before you use this appliance.
- This appliance has only been designed for cleaning teeth, gums and tongue. Do not use it for any other purpose. Stop using the appliance and contact your doctor if you experience any discomfort or pain.
- This appliance is a personal care device and is not intended for use on multiple patients in a dental practice or institution.
- Do not use other brush heads than the ones recommended by Philips Sonicare.
- Stop using a brush head with crushed or bent bristles. Replace the brush head every 3 months or sooner if signs of wear appear.
- If your toothpaste contains peroxide, baking soda or bicarbonate (common in whitening toothpastes), thoroughly clean the brush head with soap and water after each use. This prevents possible cracking of the plastic.
- Avoid direct contact with products that contain essential oils or coconut oil. Contact may result in bristle tufts dislodging.

Electromagnetic fields (EMF)

This Philips appliance complies with all applicable standards and regulations regarding exposure to electromagnetic fields.

Your Philips Sonicare toothbrush

- 1 Hygienic travel cap
- 2 Brush head
- 3 Handle
- 4 Power on/off button
- 5 Battery level indicator (specific types only)
- 6 Charger

Note: The content of the box may vary based on the model purchased.

Getting started

Attaching the brush head



- 1 Align the brush head so the bristles point in the same direction as the front of the handle.

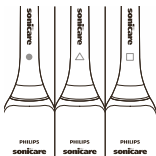

- 2 Firmly press the brush head down onto the metal shaft until it stops.

Note: Philips Sonicare brush heads are imprinted with icons to easily identify your brush head.

Charging your Philips Sonicare

- 1 Plug the charger into a live electrical outlet.
- 2 Place the handle on the charger.
 - The light of the battery level indicator flashes and the appliance beeps twice. This indicates that the toothbrush is charging.

Note: It can take up to 24 hours to fully charge the battery, but you can use the Philips Sonicare toothbrush before it is fully charged.

Using your Philips Sonicare toothbrush

Brushing instructions

- 1 Wet the bristles and apply a small amount of toothpaste.

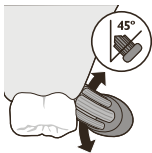

- Place the toothbrush bristles against the teeth at a slight angle (45 degrees), pressing firmly to make the bristles reach the gumline or slightly beneath the gumline.

Note: Keep the center of the brush in contact with the teeth at all times.

- Press the power on/off and mode button to turn on the Philips Sonicare.
- Gently keep the bristles placed on the teeth and in the gumline. Brush your teeth with small back and forth motion so the bristles reach between the teeth. Continue this motion throughout your brushing cycle.

Note: The bristles should slightly flare. Do not scrub.



- To clean the inside surfaces of the front teeth, tilt the brush handle semi-upright and make several vertical overlapping brushing strokes on each tooth.

Note: To make sure you brush evenly throughout the mouth, divide your mouth into 4 sections using the Quadpacer feature (see chapter 'Features').



- Begin brushing in section 1 (outside upper teeth) and brush for 30 seconds before you move to section 2 (inside upper teeth). Continue brushing in section 3 (outside lower teeth) and brush for 30 seconds before you move to section 4 (inside lower teeth).

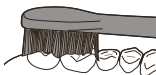

- After you have completed the brushing cycle, you can spend additional time brushing the chewing surfaces of your teeth and areas where staining occurs. You can also brush your tongue, with the toothbrush turned on or off, as you prefer.

Your Philips Sonicare toothbrush is safe to use on:

- Braces (brush heads wear out sooner when used on braces)
- Dental restorations (fillings, crowns, veneers)

Note: Ensure that braces or dental restorations are properly adhered and not compromised. If not, braces or dental restorations may be damaged when they come into contact with the brush head.

Note: When the Philips Sonicare toothbrush is used in clinical studies, the handle should be fully charged and the Easy-start feature deactivated.

Battery status (when handle is not on charger - specific types only)

This Philips Sonicare toothbrush is designed to provide at least 28 brushing sessions, each session lasting 2 minutes. The battery level indicator shows the battery status when you complete the 2-minute brushing session, or when you pause the Philips Sonicare toothbrush for 30 seconds while brushing by pressing the power on/off button.

Remaining brushing sessions	Battery status color	Light	Beeps
28-16	Green	Solid	-
15-5	Green	Flashing	-
4-2	Orange	Flashing	3 beeps
1	Orange	Flashing	2 sets of 5 beeps

Note: When the battery is completely empty, the Philips Sonicare toothbrush turns off. Place the Philips Sonicare toothbrush on the charger to charge it.

Note: To keep the battery fully charged at all times, you may keep your Philips Sonicare toothbrush on the charger when not in use.

Features

Intensities (specific types only)

Your power toothbrush gives you the option to choose between low and high intensity.

Note: When you use the toothbrush for the first time, the default setting is the low intensity.

- Press the power button once to turn on the toothbrush.
- Press a second time **within 2 seconds** to change the intensity.
- Press a third time **within 2 seconds** to pause.

After 2 seconds of brushing, pressing the power button again will also pause the toothbrush.

Smartimer

The Smartimer indicates that your brushing cycle is complete by automatically turning off the toothbrush at the end of the brushing cycle.

Dental professionals recommend brushing no less than 2 minutes twice a day.

Note: If you press the power on/off button after you started the brushing cycle, the toothbrush will pause. After a pause of 30 seconds, the Smartimer resets.

Easy-start

The Easy-start feature gently increases power over the first 14 brushings to help you get used to brushing with the Philips Sonicare toothbrush. This Philips Sonicare toothbrush comes with the Easy-start feature activated.

Activating or deactivating Easy-start

- 1 Put the handle on the plugged-in charger.
- 2 Press and hold the power on/off button while the handle remains on the charger.
- 3 Keep the power on/off button pressed until you hear a single short beep (after 3 seconds).
- 4 Release the power on/off button.
 - Triple tone of low-med-high means the Easy-start feature has been activated.

Specific types only: The battery status indicator light flashes green twice.

- Triple tone of high-med-low means the Easy-start feature has been deactivated.

Specific types only: The battery status indicator light flashes orange once.

Note: Each of the first 14 brushings must last at least 1 minute to move through the Easy-start ramp-up cycle properly.

Note: Use of the Easy-start feature beyond the initial ramp-up period is not recommended and reduces the effectiveness of the Philips Sonicare toothbrush in removing plaque.

Note: To achieve clinical efficacy, Easy-start needs to be deactivated.

Quadpacer



The Quadpacer is an interval timer that has a short beep and pause to remind you to brush the 4 sections of your mouth evenly and thoroughly. This Philips Sonicare toothbrush comes with the Quadpacer feature activated.

Charger confirmation

The handle beeps and vibrates briefly when it is placed on the charger base. This Philips Sonicare toothbrush comes with the charger confirmation feature activated.

Cleaning

You should clean your Philips Sonicare toothbrush regularly to remove toothpaste and other residue. Failure to clean your Philips Sonicare toothbrush may result in an unhygienic product and damage to it may occur.

Warning: Do not clean brush heads, the handle or the charger in the dishwasher.

Warning: Do not clean with boiling hot water.

Toothbrush handle



- 1 Remove the brush head and rinse the metal shaft area with warm water. Make sure you remove any residual toothpaste.

Caution: Do not push on the rubber seal on the metal shaft with sharp objects, as this may cause damage.

- 2 Wipe the entire surface of the handle with a damp cloth.

Note: Do not tap the handle on the sink to remove excess water.

Brush head

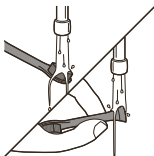

- 1 Rinse the brush head and bristles after each use.
- 2 Remove the brush head from the handle and rinse the brush head connection with warm water at least once a week. Rinse the travel cap as often as needed.

Charger

- 1 Unplug the charger before you clean it.
- 2 Wipe the surface of the charger with a damp cloth.

Storage

If you are not going to use the product for a long time, unplug it, clean it (see chapter 'Cleaning') and store it in a cool and dry place away from direct sunlight.

Replacement

Brush head

Replace Philips Sonicare brush heads every 3 months to achieve optimal results. Use only Philips Sonicare replacement brush heads.

Recycling

- Do not throw away the product with the normal household waste at the end of its life, but hand it in at an official collection point for recycling. By doing this, you help to preserve the environment.

- This product contains a built-in rechargeable battery which shall not be disposed of with normal household waste. Please take your product to an official collection point or a Philips service center to have a professional remove the rechargeable battery.
- Follow your country's rules for the separate collection of electrical and electronic products and rechargeable batteries. Correct disposal helps prevent negative consequences for the environment and human health.

Removing the rechargeable battery

Warning: Only remove the rechargeable battery when you discard the appliance. Make sure the battery is completely empty when you remove it.

Warning: Please note that this process is not reversible.

To remove the rechargeable battery, you need a towel or cloth, a hammer and a flat-head (standard) screwdriver. Observe basic safety precautions when you follow the procedure outlined below. Be sure to protect your eyes, hands, fingers, and the surface on which you work.

- 1 To deplete the rechargeable battery of any charge, remove the handle from the charger, turn on the Philips Sonicare toothbrush and let it run until it stops. Repeat this step until you can no longer turn on the Philips Sonicare toothbrush.



- 2** Remove and discard the brush head. Cover the entire handle with a towel or cloth.

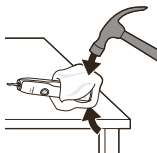

- 3** Hold the top of the handle with one hand and strike the handle housing 0.5 inch above the bottom end. Strike firmly with a hammer on all 4 sides to eject the end cap.

Note: You may have to hit on the end several times to break the internal snap connections.

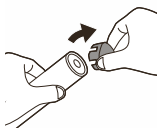

- 4** Remove the end cap from the toothbrush handle. If the end cap does not release easily from the housing, repeat step 3 until the end cap is released.

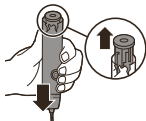

- 5** Holding the handle upside down, press the shaft down on a hard surface. If the internal components do not easily release from the housing, repeat step 3 until the internal components are released.

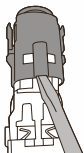

- 6** Remove the inner assembly from the housing by fully inserting a small flat-head screwdriver into the slot opposite the circuit board and pry until it comes apart.

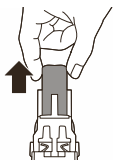

- 7 Grab the battery and pull it out of the internal assembly.

Caution: Be aware of the sharp edges of the battery tabs so as to avoid injury to your fingers.

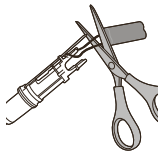

- 8 Cut the battery wires from the circuit board close to the battery.

Caution: Do not cut the two wires at the same time.

- 9 Cover the battery contacts with tape to prevent any electrical short from residual battery charge. The rechargeable battery can now be recycled and the rest of the product discarded appropriately.

Warranty and support

If you need information or support, please visit www.philips.com/support or read the international warranty leaflet.

Warranty restrictions

The terms of the international warranty do not cover the following:

- Brush heads.
- Damage caused by use of unauthorized replacement parts.
- Damage caused by misuse, abuse, neglect, alterations or unauthorized repair.
- Normal wear and tear, including chips, scratches, abrasions, discoloration or fading.

Troubleshooting

This chapter summarizes the most common problems you could encounter with the appliance.

If you are unable to solve the problem with the information below, visit www.philips.com/support for a list of frequently asked questions or contact the Consumer Care Center in your country.

Problem	Possible Cause	Solution
<p>I cannot fully attach the brush head. There is a gap between the brush head and handle.</p>		<p>This gap is normal and is needed for the brush head to vibrate appropriately.</p>
<p>My Philips Sonicare toothbrush vibration is less powerful than before.</p>	<p>The Easy-start function is activated, the intensity level has been lowered or the brush head needs to be replaced.</p>	<p>Turn off the Easy-start function and/or raise the intensity level. If this does not resolve the problem, replace the brush head. We recommend you to replace your Philips Sonicare brush head after 3 months of use (based on brushing twice a day for 2 minutes each session).</p>
<p>My Philips Sonicare toothbrush is missing parts.</p>	<p>The missing parts are not included with the model you purchased.</p>	<p>The accessories and the number of brush head attachments are dependent on the model number you have purchased. You can find the HX model number at the bottom of your handle to identify what comes with your handle.</p>

简介

感谢您的惠顾，很高兴您选择飞利浦！为了让您能充分享受飞利浦提供的支持，请在 www.philips.com/welcome 上注册您的产品。

重要安全信息

使用产品之前，请仔细阅读本重要信息，并妥善保管以供日后参考。

注意： 不同型号的附件和功能各不相同。例如，部分型号附带消毒器或配备蓝牙。

危险

- 确保充电器和/或消毒器远离水源。请勿将本产品放置或保存在可能掉落或推入浴缸或水槽的地方。
- 请勿将充电器和/或消毒器浸入水或任何其他液体中。
- 清洁后，务必确保充电器和/或消毒器完全干燥后，再将其连接至电源插座。

警告

- 本产品适合由儿童和肢体不健全、感觉或精神上有障碍或缺乏相关经验和知识的人士使用，但前提是有人对他们使用本产品进行监督或指导，以确保他们安全使用，并且让他们明白相关的危害。不要让儿童在无人监督的情况下对本产品进行清洁和保养。

- 切勿让儿童玩弄本产品。
- 如果产品受到任何损坏（牙刷头、牙刷柄、充电器和/或消毒器），请勿再使用。
- 不得更换电源线。如果电源线损坏，请丢弃充电器和/或消毒器。
- 应始终使用原装型号的充电器和/或消毒器进行更换，以免发生危险。
- 要使用旅行收纳盒为电池充电，请仅使用可拆卸式 USB 电缆和插墙式适配器（如本产品随附）。
- 本产品不包含任何用户可维修的零部件。如果本产品已损坏，请联系您所在国家/地区（请参见‘保修和支持’）的客户服务中心。
- 请将电源线远离高温表面。
- 请勿在户外或高温表面附近使用充电器和/或消毒器。

警告

- 请勿使用洗碗机清洁牙刷头、牙刷柄、充电器、充电器盖或消毒器。
- 如果您在前 2 个月中曾做过口腔或牙龈手术，请在使用本产品前先咨询您的牙医。
- 如果使用本产品后牙龈大量出血或在使用 1 周后仍会出血，请咨询您的牙医。如果使用本产品时感觉不适或疼痛，也请咨询您的牙医。

- 本飞利浦产品符合电磁装置的安全标准。有关任何涉及心脏起搏器或其他植入装置的问题，请在使用之前咨询医生或相关植入产品的产品制造商。
- 如果您有医学问题，请在使用本产品前咨询您的医生。
- 本产品设计仅用于清洁牙齿、牙龈和舌头。请勿将其用作任何其它用途。如果感觉任何不适或疼痛，请停止使用本产品并与医生联系。
- 本产品为私人用品，不可供牙医诊所或机构对多位患者使用。
- 切勿使用非飞利浦 Sonicare 声波震动牙刷推荐的其他牙刷头。
- 请停止使用变形或刷毛弯曲的牙刷头。请每 3 个月更换一次牙刷头，如果出现磨损迹象，应提前更换。
- 如果您所用的牙膏中含有过氧化物、碳酸氢钠或其它重碳酸盐（增白牙膏中的常见成份），则请务必在每次使用后用肥皂和水彻底清洗牙刷头。这可以预防可能出现的塑料破裂。
- 避免与含有精油或椰子油的产品直接接触。接触此类产品可能会导致刷毛脱落。

电磁场 (EMF)

本 Philips 产品符合所有有关暴露于电磁场的适用标准和法规。

您的飞利浦 Sonicare 声波震动牙刷

- 1 旅行用卫生保护盖
- 2 牙刷头
- 3 手柄
- 4 开/关按钮
- 5 电池电量指示灯（仅限特定型号）
- 6 充电器

注意：包装盒内物品可能会因所购买型号而异。

开始使用

安装牙刷头



- 1 对齐牙刷头，使刷毛方向与牙刷手柄正面的方向一致。

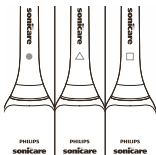

- 2 用力将牙刷头向下按到金属轴上，直到按不动为止。

注意：Philips Sonicare 刷头印有图标，便于识别刷头。

为您的飞利浦 Sonicare 声波震动牙刷充电

- 1 将充电器插入带电的电源插座。
- 2 将牙刷柄放在充电器上。
 - 电池电量指示灯闪烁，且产品发出两声蜂鸣音。这表示牙刷正在充电。

注意： 电池充满电需要 24 小时，但飞利浦 Sonicare 声波震动牙刷在未充满电时亦可使用。

使用您的飞利浦 Sonicare 声波震动牙刷

刷牙说明

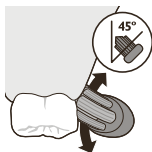

- 1 浸湿刷毛并挤上少量牙膏。
- 2 将牙刷的刷毛以小角度（45 度）放在牙齿上，用力按下以使刷毛接触牙龈或牙龈略下方。

注意： 始终将牙刷中间与牙齿接触。

- 3 按下电源开/关和模式按钮，打开飞利浦 Sonicare。
- 4 将刷毛轻轻放置于牙齿和牙龈上，来回小幅度缓慢移动，这样可以让刷毛能够刷到牙缝。在整个刷牙周期中连续这样移动即可。

注意： 刷毛应稍微呈喇叭形，请勿过度用力。



- 5 要清洁门牙内表面，请将牙刷柄呈半直立状倾斜，在每颗牙齿上反复垂直震动。

注意： 为确保牙刷能均匀清洁整个口腔，可使用 Quadpacer 30 秒时段计时器功能将口腔分为 4 个区域（参见“功能”一章）。



6 从第 1 个刷牙区域（上牙外侧）开始，刷 30 秒钟，然后移到第 2 个刷牙区域（上牙内侧）。继续刷第 3 个刷牙区域（下牙外侧），刷 30 秒钟，然后移到第 4 个刷牙区域（下牙内侧）。

7 在完成刷牙周期之后，您可以多花一些时间刷洗牙齿的咀嚼面以及污垢容易出现区域。还可以使用该牙刷清洁舌头，这时可以根据自己的喜好打开或关闭牙刷电源。

您的 Philips Sonicare 声波震动牙刷可安全用于：

- 牙齿矫正器（在牙齿矫正器上使用时，牙刷头磨损较快）
- 修复牙体（补牙、齿冠、烤瓷牙）

注意： 确保牙齿矫正器或修复牙体正确固着并且未损坏。否则，当其与牙刷头接触时可能会损坏。

注意： 飞利浦 Sonicare 声波震动牙刷用于临床研究时，刷柄必须充满电且应禁用 EasyStart 功能。

电池状态（牙刷柄未置于充电器上时 - 仅限特定型号）

本飞利浦 Sonicare 声波震动牙刷可至少提供 28 次刷牙周期，每次持续 2 分钟。当您完成 2 分钟的刷牙周期，或者当您在刷牙时按下电源开/关按钮，飞利浦

Sonicare 声波震动牙刷暂停 30 秒时，电池电量指示器会显示电池状态。

剩余刷牙周期	电池状态颜色	灯光	蜂鸣音
28-16	绿色	常亮	-
15-5	绿色	闪烁	-
4-2	橙色	闪烁	3 声蜂鸣音
1	橙色	闪烁	2 组 5 声蜂鸣音

注意：电池电量完全耗尽时，飞利浦 Sonicare 声波震动牙刷会关闭。请将飞利浦 Sonicare 声波震动牙刷置于充电器上充电。

注意：为确保电池始终电量充沛，您可在不使用时将飞利浦 Sonicare 声波震动牙刷置于充电器上。

功能

强度（仅限于特定型号）

这款电动牙刷可供您自由选择低强度和高强度设置：

注意：首次使用牙刷时，默认设置为低强度。

- 按一下开关按钮打开 Sonicare 声波震动牙刷。

- 在 **2 秒内**再按一次开关按钮可改变强度。
- 在 **2 秒内**按第三次开关按钮可以暂停。刷牙 **2 秒后**，再次按电源按钮也将使牙刷暂停工作。

Smartimer 两分钟智能计时器

Smartimer 两分钟智能计时器在刷牙周期结束时会自动关闭牙刷，指示您的设定刷牙周期已完成。

牙科专家建议每天刷牙两次，每次不少于 2 分钟。

注意：如果在开始刷牙周期后按下电源开/关按钮，牙刷将暂停。暂停 30 秒后，Smartimer 两分钟智能计时器将重置。

Easy-start 刷牙动力增强功能

Easy-start 刷牙动力增强功能在最初 14 次刷牙时会缓慢增加动力，以帮助您适应使用飞利浦 Sonicare 声波震动牙刷刷牙。本型号的飞利浦 Sonicare 声波震动牙刷出厂时已激活 Easy-start 刷牙动力增强装置。

启用或禁用 **Easy-start** 刷牙动力增强功能

- 1 将牙刷柄放到已连接电源的充电器上。
- 2 在牙刷柄置于充电器的同时，按住电源开/关按钮。

- 3 按住电源开/关按钮，直到您听到一声短暂的蜂鸣音（在 3 秒之后）。
- 4 松开电源开/关按钮。
 - 低、中、高三声音调表示 Easy-start 刷牙动力增强功能已启用。
仅限于特定型号： 电池状态指示灯呈绿色闪烁两次。
 - 高、中、低三声音调表示 Easy-start 刷牙动力增强功能已禁用。
仅限于特定型号： 电池状态指示灯呈橙色闪烁一次。

注意：最初 14 次刷牙必须每次至少持续 1 分钟，以便正确度过 Easy-start 动力增强的循序渐进期。

注意：建议在初始动力递增阶段后，不使用 Easy-start 刷牙动力增强功能，以免减弱飞利浦 Sonicare 牙刷去除牙菌斑的效果。

注意：如需达到临床效果，应禁用 Easy-start 刷牙动力增强功能。

Quadpacer 30 秒时段计时器



Quadpacer 是会发出短暂嘟嘟声并暂停的时段计时器，提醒您均匀彻底地刷净口腔的四个区域。本款飞利浦 Sonicare 声波震动牙刷出厂时已启用 Quadpacer 30 秒时段计时器功能。

充电器确认

将牙刷柄放置在充电座时，牙刷柄会发出蜂鸣音并短促振动。本款飞利浦 Sonicare 声波震动牙刷出厂时已启用充电器确认功能。

清洁

您应当定期清洗您的 Philips Sonicare 声波震动牙刷以清除牙膏和其他残留物，否则可能会导致产品不洁净并可能损坏产品。

警告：请勿用洗碗机清洗刷头、刷柄或充电器。

警告：请勿使用滚烫的热水清洗。

牙刷柄



1 卸下牙刷头并用温水冲洗金属轴。确保清除所有残留牙膏。

警告：请勿使用尖锐物品按压金属轴上的橡胶密封圈，否则可能造成损坏。

2 使用湿布擦拭牙刷柄的整个表面。

注意：请勿在水槽上轻敲牙刷柄以去除多余的水分。

刷头

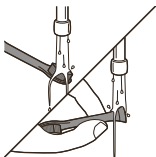

- 1 每次刷牙后冲洗牙刷头和刷毛。
- 2 从牙刷柄上卸下牙刷头，每周至少用温水冲洗一次牙刷头连接处。请根据需要经常冲洗旅行保护盖。

充电器

- 1 清洁产品前，请先将充电器电源拔掉。
- 2 使用湿布擦拭充电器的表面。

存放

如果长时间不使用产品，应拔下插头，清洁产品（请参阅“清洁”一章）并将其存放在远离阳光直射的阴凉干燥处。

更换 刷头

每 3 个月更换一次飞利浦 Sonicare 刷头，以获得理想洁牙效果。仅使用飞利浦 Sonicare 替换刷头。

回收

- 弃置本产品时，请不要将其与一般生活垃圾放在一起，应将其交给政府指定的回收中心。这样做将有利于环保。
- 此产品包含内置充电电池；请勿将充电电池与一般生活垃圾一起弃置。请您将产品送到官方收集中心或飞利浦服务中心，请专业人士移除充电电池。

- 遵循您的国家/地区有关分类回收电子电气产品和充电电池的规定。正确弃置产品有助于避免对环境和人类健康造成不良后果。

卸下充电电池

警告： 必须在丢弃产品前取出充电电池。在取出电池时请确保电池电量已耗尽并与电源断开连接。

警告： 请注意，此过程是不可逆的。

要拆下充电电池，您需要一块毛巾或布、一个锤子和一个平头（标准）螺丝刀。按照下面列出的步骤执行操作时，请遵循基本的安全措施。务必保护好您的眼睛、手、手指以及工作台面。

- 1 要耗尽充电电池的电量，可以从充电器上取下牙刷柄，打开 Philips Sonicare 声波震动牙刷并让其运行直到停止。重复这一步骤，直至 Philips Sonicare 声波震动牙刷无法再打开。
- 2 取下并丢弃牙刷头。用毛巾或布包住整个牙刷柄。



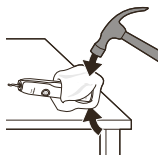

- 3 用一只手握住牙刷柄顶部，敲击底部以上 0.5 英寸处的牙刷柄外壳。用锤子在所有 4 个侧面用力敲打，使端盖弹出。

注意：可能要在底部敲打多次，才能将内部的扣合式连接分开。

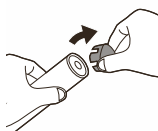

- 4 从牙刷柄上取下端盖。如果很难从外壳中取出端盖，请重复步骤 3，直至将其取出。

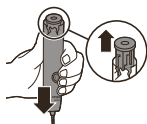

- 5 将牙刷柄倒置，然后将轴向下按到坚硬表面上。如果很难从外壳中取出内部组件，请重复步骤 3，直至将其取出。

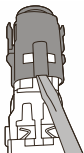

- 6 将小型平头螺丝刀完全插入与电路板相对的插槽，并加以撬动直至分离，即可将内部组件从外壳中取出。

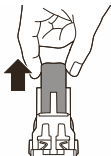

- 7 拿起电池，将其从内部组件中拉出。

警告：请注意电池卡舌的锋利边缘，以免伤到手指。

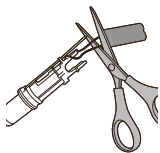

8 剪断电池电线，将其与电池附近的电路板分开。

警告：请勿同时剪断两根电线。

9 用胶带包住电池触点，以防止电池剩余电量导致短路。充电电池即可回收，产品的其它部件也要适当地弃置。

产品中有害物质的名称及含量						
部件名称	有害物质					
	铅 (Pb)	汞 (Hg)	镉 (Cd)	六价铬 (Cr (VI))	多溴联苯 (PBB)	多溴二苯醚 (PBDE)
电源适配器	○	○	○	○	X	X
本表格依据SJ/T 11364的规定编制。						
○: 表示该有害物质在该部件所有均质材料中的含量均在GB/T 26572规定的限量要求以下。						
X: 表示该有害物质至少在该部件的某一均质材料中的含量超出GB/T 26572规定的限量要求。						

- 该表格中所显示的“有害物质”在产品正常使用情况下不会对人身和环境产生任何伤害。
- 该表格中所显示的“有害物质”及其存在的部件向消费者和回收处理从业者提供相关物质的存在信息，有助于产品废弃时的妥善处理。

保修和支持

如需信息或支持，请访问
www.philips.com/support 或阅读保修卡。

保修限制

国际保修条款中不包括以下各项：

- 刷头。

- 因使用未授权的备件而造成的损坏。
- 由于误用、滥用、疏忽、改装或擅自修理造成的损坏。
- 正常磨损，包括裂口、擦痕、磨损、变色或褪色等。

故障种类和处理方法

本章归纳了使用本产品时最常见的一些问题。如果您无法根据以下信息解决问题，请访问 www.philips.com/support 查阅常见问题列表，或联系您所在国家/地区的客户服务中心。

问题	可能的原因	解决方法
我无法完全连接牙刷头。牙刷头与牙刷柄之间存在间隙。		此间隙是正常的，牙刷头需要此间隙进行适当地振动。
我的飞利浦 Sonicare 声波震动牙刷的振动没有以前那么强烈了。	Easy-start 刷牙动力增强功能被激活，强度等级降低，或牙刷头需要更换。	关闭 Easy-start 刷牙动力增强功能和/或提高强度等级。如果这种方法无法解决问题，请更换牙刷头。我们建议您在使用 3 个月（基于每天刷牙两次，每次持续 2 分钟）后更换飞利浦 Sonicare 声波震动牙刷刷头。

问题	可能的原因	解决方法
我的飞利浦 Sonicare 声波震动牙刷缺少部件。	您购买的型号不含这些部件。	附件和牙刷头附件的数量取决于您购买的型号。您可以在牙刷柄底部找到 HX 型号，以确定牙刷柄附带的部件。

www.philips.com/Sonicare

©2019 Koninklijke Philips N.V. (KPNV). All rights reserved. Philips and the Philips shield are trademarks of KPNV. Sonicare and the Sonicare logo are trademarks of Philips Oral Healthcare, LLC and/or KPNV.

©2019 Koninklijke Philips N.V. (KPNV). 保留所有权利。飞利浦及飞利浦盾牌标志是 KPNV 的商标。Sonicare 和 Sonicare 徽标是 Philips Oral Healthcare, LLC 和/或 KPNV 的商标。

©2019 Koninklijke Philips N.V. (KPNV)。版權所有。飛利浦及飛利浦盾牌標誌為 KPNV 的商標。Sonicare 及 Sonicare 標誌為飛利浦口腔保健公司和/或 KPNV 的商標。

4235.021.7477.1 (12/7/2019)



>75 % recycled paper
>75 % papier recyclé