

Sonicare EssentialClean

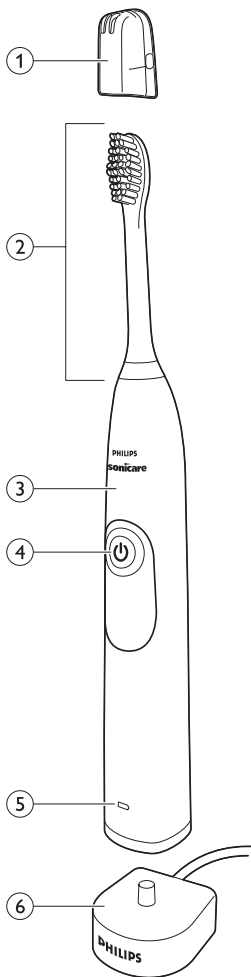

PHILIPS
sonicare



Introduction

Congratulations on your purchase and welcome to Philips! To fully benefit from the support that Philips offers, register your product at **www.philips.com/welcome**.

IMPORTANT SAFEGUARDS

READ ALL INSTRUCTIONS BEFORE USE

DANGERS

To reduce the risk of electrocution:

- 1 Always place and store the charger at a safe distance from water.
- 2 Do not reach for a charger that has fallen into water. Unplug immediately.
- 3 Never use a charger with a damaged cord or plug.

WARNINGS

To reduce the risk of burns, electrocution, fire or physical injury:

- 1 Do not use attachments other than those recommended by the manufacturer.
- 2 Never force the plug into an outlet; if the plug does not easily fit into the outlet, discontinue use.
- 3 Discontinue use if the product appears damaged in any way (brush head, handle or charger).
- 4 The mains cord cannot be replaced. If the mains cord is damaged, discard the charger.
- 5 Keep the cord away from heated surfaces.
- 6 Do not use the charger outdoors.

- 7 This product contains no user-serviceable parts. Refer to 'Warranty and support' if the product no longer works properly or needs repair.
- 8 Use this product only for its intended use as described in this document or as recommended by your dental professional.
- 9 This product is not intended for use by persons (including children) with reduced physical, sensory, or mental capabilities, or lack of experience and knowledge, unless they have been given supervision or instruction concerning use of the appliance by a person responsible for their safety.
- 10 Children should be supervised to ensure that they do not play with the product.
- 11 Sonicare is a personal care device and is not intended for use on multiple patients in a dental office or institution.

MEDICAL WARNINGS

- 1 Consult your dental professional before you use this product if you have had oral or gum surgery in the previous 2 months.
- 2 Contact your dental professional if excessive bleeding occurs after using this product or bleeding continues to occur after 1 week of use.
- 3 Discontinue use of this product and contact a physician/dentist if discomfort or pain is experienced.
- 4 This product complies with the safety standards for electromagnetic devices. If you have a pacemaker or other implanted device, contact your physician or the device manufacturer prior to use.
- 5 Consult your physician if you have other medical concerns.

Electromagnetic fields (EMF)

This Philips product complies with all applicable standards and regulations regarding exposure to electromagnetic fields.

SAVE THESE INSTRUCTIONS

Your Sonicare (Fig. 1)

- 1 Hygienic travel cap
- 2 Brush head with unique identifier
- 3 Handle
- 4 Power on/off & mode button
- 5 Battery level indicator
- 6 Charger

Getting started

Attaching the brush head

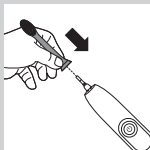

- 1 Align the brush head so the bristles face the front of the handle.
- 2 Firmly press the brush head down on the metal shaft until it stops.

Note: Sonicare brush heads come with easily identifiable icons to identify your brush head.

Charging your Sonicare

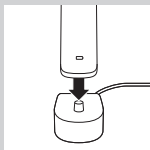

- 1** Plug the charger into a live electrical outlet.
- 2** Place the handle on the charger.

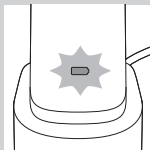

- The battery level indicator flashes to indicate that the toothbrush is charging.

Note: It can take up to 48 hours to fully charge the battery, but the Sonicare may be used before it is fully charged.

Using your Sonicare

Brushing instructions

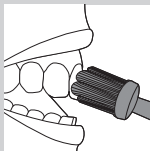

- 1** Wet the bristles and apply a small amount of toothpaste.
- 2** Place the toothbrush bristles against the teeth at a slight angle towards the gumline.
- 3** Press the power on/off & mode button to turn on the Sonicare.
- 4** Apply light pressure to maximize Sonicare's effectiveness and let the Sonicare toothbrush do the brushing for you. Do not scrub.
- 5** Gently move the brush head slowly across the teeth in a small back and forth motion so the longer bristles reach between the teeth. Continue this motion throughout the brushing cycle.

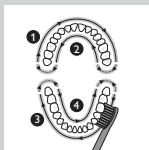

Note: This model is equipped with the Quadpacer feature. This feature prompts you to brush all 4 quadrants of the mouth (see chapter 'Features').

- 6** Begin brushing in section 1 (outside top teeth) and brush for 30 seconds before moving to section 2 (inside top teeth). Continue brushing in section 3 (outside bottom teeth) and brush for 30 seconds before moving to section 4 (inside bottom teeth).

Note: After you have completed the brushing cycle, you can spend additional time brushing the chewing surfaces of your teeth and areas where staining occurs. You may also brush your tongue, with the toothbrush turned on or off, as you prefer.

Your Sonicare is safe to use on:

- Braces (brush heads may wear out more quickly when used on braces)
- Dental restorations (fillings, crowns, veneers, implants)

Brushing modes (Select models)

Clean mode

Mode for superior teeth cleaning.

Massage mode

Mode for gentle gum stimulation.

- 1** Press the power on/off & mode button to turn on your Sonicare. Sonicare starts in the Clean mode the first time you use it.
- 2** If you want to change to the Massage mode, press the power on/off button again within 3 seconds of turning it on to switch to the Massage mode.

Note: To turn off your Sonicare after brushing, press the on/off button again. If you brush for the entire two minute cycle, the brush will automatically turn off.

Note: The toothbrush will remain in the last mode used. If you last used the Massage mode, it will remain in the Massage mode when you turn on your brush again. If you want to use the Clean mode, you will need to press the on/off button a second time (within 3 seconds) after turning it on.

Note: When Sonicare is used in clinical studies, the default 2-minute Clean mode must be selected. The handle should be fully charged and the Easy-start feature deactivated.

Battery status (when handle is not on charger)

- A yellow battery level indicator indicates a low charge.
- A green battery level indicator indicates a high charge.
- The battery level indicator turns off when the battery is in between a low and a high charge.

Note: When you hear 3 beeps and the battery level indicator flashes yellow, this means the battery charge is below 10% and the battery should be recharged.

Note: To keep the battery fully charged at all times, you may keep your Sonicare on the charger when not in use.

Features

Quadpacer

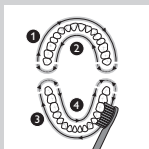

- The Quadpacer is an interval timer. It has a short beep and pause that remind you to switch to the next section of your mouth.

Smartimer

The Smartimer indicates that your brushing cycle is complete when it automatically turns off the toothbrush at the end of the brushing cycle. Dental professionals recommend brushing at least 2 minutes twice a day.

Note: If you press the power on/off & mode button after you started the brushing cycle, the toothbrush will pause. After a pause of 30 seconds, the Smartimer resets.

Easy-start

The Easy-start feature gently increases power over the first 14 brushings to ease into the Sonicare experience.

Note: This Sonicare model comes with the Easy-start feature deactivated.

To activate the Easy-start feature:

- 1** Attach your brush head to the handle.
- 2** Place the handle in the plugged-in charger.
- 3** Press and hold the power on/off & mode button for 2 seconds. Your Sonicare beeps twice and the battery level indicator flashes green to indicate that the Easy-start feature has been activated.

To deactivate Easy-start: Press and hold the power on/off & mode button for 2 seconds. You hear 1 beep and the battery level indicator flashes yellow to indicate that the Easy-start feature has been deactivated.

Note: Each of the first 14 brushings must be at least 1 minute in length to properly move through the Easy-start ramp-up cycle.

Note: Using the Easy-start feature beyond the initial ramp-up period is not recommended and reduces Sonicare's effectiveness in removing plaque.

Cleaning

DO NOT clean the brush head, handle or charger in dishwasher.

Toothbrush handle

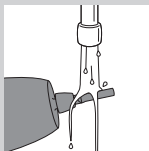

- 1** Remove the brush head and rinse the metal shaft area with warm water.

Do not push on the rubber seal around the metal shaft with sharp objects, as this may cause damage.

- 2** Use a damp cloth to wipe the entire surface of the handle.

Brush head

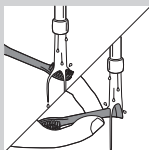

- 1** Rinse the brush head and bristles after each use.
- 2** Remove the brush head from the handle and rinse the brush head connection at least once a week with warm water.

Charger

- 1** Unplug the charger.
- 2** Use a damp cloth to wipe the surface of the charger.

Storage

If you are not going to use the product for an extended period of time, unplug it from the electrical outlet, clean it and store it in a cool and dry place away from direct sunlight.

Replacement

Brush head

- Replace Sonicare brush heads every 3 months to achieve optimal results.
- Use only genuine Philips Sonicare replacement brush heads that are suitable for this model.

Disposal



- This appliance contains a rechargeable battery which must be disposed of properly.
- Contact your local town or city officials for battery disposal information. You can also call 1-800-8-BATTERY or visit **www.rbrc.com** for battery drop-off locations.
- For assistance, visit our website **www.philips.com/support** or call 1-800-243-3050 toll free.

Removing the rechargeable battery

This process is not reversible.

Only remove the rechargeable battery when you discard the appliance. Make sure the battery is completely empty when you remove it.

To remove the rechargeable battery, you need a small standard screwdriver and tape. Observe basic safety precautions when you follow the procedure below.

- 1** To deplete the rechargeable battery of any charge, remove the handle from the charger, turn on the Sonicare and let it operate until it stops. Repeat this step until you can no longer turn on the Sonicare.

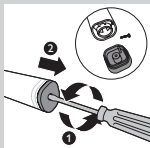

- 2** Insert a small standard screwdriver into the bottom of the handle and turn it counter-clockwise to remove the screw. Pull the end cap off of the handle.

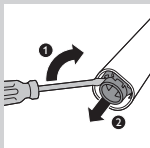

- 3** Insert the screwdriver between the handle and the internal frame. Tilt the screwdriver to loosen the handle.

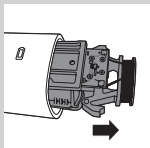

- 4** Remove the internal frame from the handle.

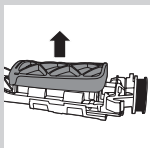

- 5** Remove the rubber bumpers that are on top and below the battery.

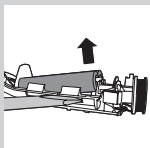

- 6** Insert the screwdriver between the battery and the frame. Tilt the screwdriver to pop the battery out of the frame.

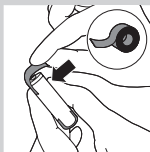

- 7** Place some tape over the ends of the battery to avoid any short-circuiting due to residual energy in the battery.

The rechargeable battery can now be recycled or disposed of and the rest of the product discarded appropriately.

Warranty and support

Philips warrants its products for two years after the date of purchase. Defects due to faulty materials and workmanship will be repaired or replaced at Philips' expense provided that convincing proof of purchase in the qualifying period is provided. Philips recommends use of genuine Sonicare brush heads for optimal performance. Use of other brush heads may damage your Sonicare toothbrush and limit your warranty protection.

Contact our Consumer Care Center at 1-800-682-7664 (North America), outside North America contact your local Philips Consumer Care Center.

Internet information: **www.sonicare.com** (North America) or **www.philips.com** (outside North America).

WARRANTY EXCLUSIONS

What is not covered under warranty:

- Brush heads.
- Damage caused by use of unauthorized replacement parts or unauthorized brush heads.
- Damage caused by misuse, abuse, neglect, alterations or unauthorized repair.
- Normal wear and tear, including chips, scratches, abrasions, discoloration or fading.

IMPLIED WARRANTIES

ANY IMPLIED WARRANTIES, INCLUDING IMPLIED WARRANTIES OF MERCHANTABILITY AND FITNESS FOR A PARTICULAR PURPOSE, SHALL BE LIMITED TO THE DURATION OF THE EXPRESS WARRANTIES SET FORTH ABOVE. IN SOME STATES LIMITATIONS ON DURATION OF IMPLIED WARRANTIES DO NOT APPLY.

LIMITATION OF REMEDIES

IN NO EVENT SHALL PHILIPS OR ANY OF ITS AFFILIATED OR SUBSIDIARY COMPANIES BE LIABLE FOR ANY SPECIAL, INCIDENTAL OR CONSEQUENTIAL DAMAGES BASED UPON BREACH OF WARRANTY, BREACH OF CONTRACT, NEGLIGENCE, TORT, OR ANY OTHER LEGAL THEORY. SUCH DAMAGES INCLUDE, WITHOUT LIMITATION, LOSS OF SAVINGS OR REVENUE; LOSS OF PROFIT; LOSS OF USE; THE CLAIMS OF THIRD PARTIES INCLUDING, WITHOUT LIMITATION, DENTISTS AND DENTAL HYGIENISTS; AND COST OF ANY SUBSTITUTE EQUIPMENT OR SERVICES. SOME STATES DO NOT ALLOW THE EXCLUSION OR LIMITATION OF INCIDENTAL OR CONSEQUENTIAL DAMAGES.



www.philips.com/Sonicare

©2016 Koninklijke Philips N.V. (KPNV). All rights reserved.

Philips and the Philips shield are trademarks of KPNV.

Sonicare and the Sonicare logo are trademarks
of Philips Oral Healthcare, LLC and/or KPNV.



100% recycled paper

4235.021.0618.2