

DiamondClean

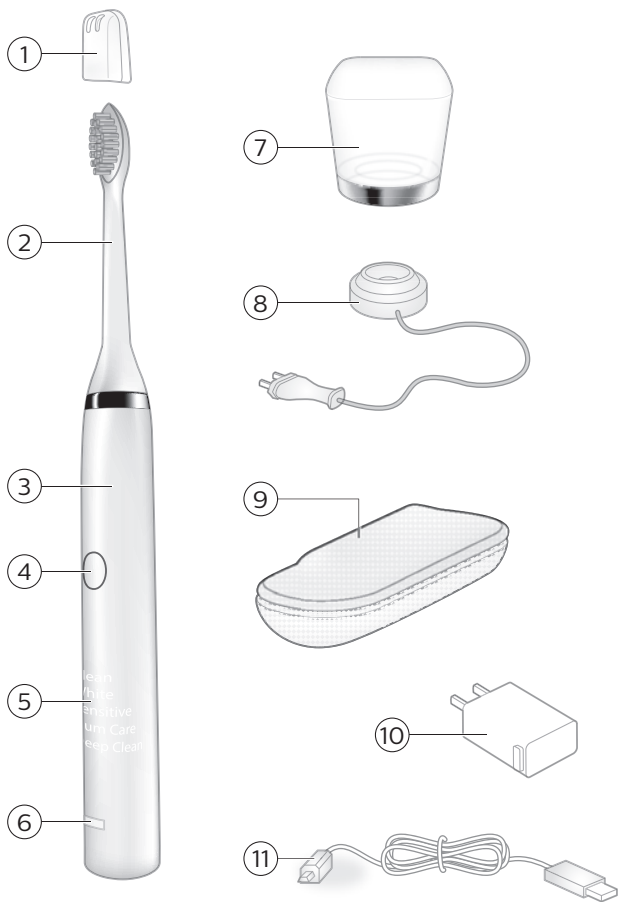

PHILIPS
sonicare





English 6

Introduction

Congratulations on your purchase and welcome to Philips! To fully benefit from the support that Philips offers, register your product at www.philips.com/welcome.

IMPORTANT SAFEGUARDS

Warning: READ ALL INSTRUCTIONS BEFORE USE

When using electrical products, especially when children are present, basic safety precautions should always be followed, including the following:

DANGERS

To reduce the risk of electrocution:

- 1 Always place and store the charger at a safe distance from water.
- 2 Do not reach for a charger that has fallen into water. Unplug immediately.
- 3 Never use a charger with a damaged cord or plug.

WARNINGS

To reduce the risk of burns, electrocution, fire or physical injury:

- 1 Do not use attachments other than those recommended by the manufacturer.

- 2 Do not plug the adapter into an outlet with a voltage other than specified on the bottom of the adapter. This product is designed to operate within a range of 100 to 240 volts. Voltage converters do not warrant voltage compatibility.
- 3 Never force the adapter into an outlet; if the adapter does not easily fit into the outlet, discontinue use.
- 4 Discontinue use if the product appears damaged in any way (brush head, handle, charger or adapter).
- 5 The mains cord cannot be replaced. If the mains cord is damaged, discard the charger.
- 6 Keep the cord away from heated surfaces.
- 7 Do not use the adapter outdoors.
- 8 This product contains no user-serviceable parts. Refer to 'Warranty and support' if the product no longer works properly or needs repair.
- 9 Use this product only for its intended use as described in this document or as recommended by your dental professional.
- 10 This product is not intended for use by persons (including children) with reduced physical, sensory, or mental capabilities, or lack of experience and knowledge, unless they have been given supervision or instruction concerning use of the appliance by a person responsible for their safety.
- 11 Children should be supervised to ensure that they do not play with the product.

- 12 Philips Sonicare is a personal care device and is not intended for use on multiple patients in a dental office or institution.
- 13 Use UL Listed computer, USB Hub or USB duplex receptacle when charging the toothbrush handle in the travel case.
- 14 When using a computer to recharge the toothbrush handle, the computer should be located away from sources of water (i.e. sink or tub) so as to avoid electrical shock.
- 15 In order to effectively charge your Philips Sonicare do not place your charger base on a magnetic metal surface.
- 16 The adapter is certified according to the relevant safety standard UL1310.
- 17 The adapter is not intended to be repaired by service personnel in case of failure or component defect (unit can be thrown away).
- 18 For connection to a supply not in the U.S.A., use an adapter of the proper configuration for the power outlet.

MEDICAL WARNINGS

- 1 Consult your dental professional before you use this product if you have had oral or gum surgery in the previous 2 months.
- 2 Contact your dental professional if excessive bleeding occurs after using this product or bleeding continues to occur after 1 week of use.
- 3 Discontinue use of this product and contact a physician/dentist if discomfort or pain is experienced.

- 4 This product complies with the safety standards for electromagnetic devices. If you have a pacemaker or other implanted device, contact your physician or the device manufacturer prior to use.
- 5 Consult your physician if you have other medical concerns.

Electromagnetic fields (EMF)

This Philips device complies with all applicable standards and regulations regarding exposure to electromagnetic fields.

SAVE THESE INSTRUCTIONS

Your Philips Sonicare (Fig. 1)

- 1 Hygienic travel cap
- 2 Brush head with unique identifier
- 3 Handle with ergonomic shape
- 4 Recessed power on/off button
- 5 Hidden brushing mode display
- 6 Charge indicator
- 7 Charging glass (select models)
- 8 Charging base
- 9 Charging travel case
- 10 USB wall adapter
- 11 USB cord

Note: The content of the box may vary based on the model purchased.

Getting started

Attaching the brush head

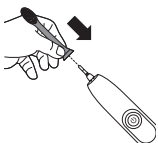

- 1 Align the brush head so the bristles point in the same direction as the front of the handle.
- 2 Firmly press the brush head down onto the metal shaft until it stops.

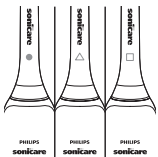

Note: Philips Sonicare brush heads are imprinted with icons to easily identify your brush head.

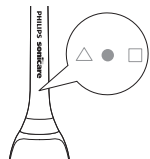

Note: It is normal to see a slight gap between the brush head and the handle.

Charging your Philips Sonicare

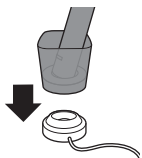

- 1 Plug the charger into an electrical outlet.
- 2 Place charging glass (select models) on top of the charging base and place handle in glass.
 - The charge indicator flashes green until fully charged.
 - Rapid yellow flashing indicates charge is extremely low (fewer than 3 uses left).

Note: It takes at least 24 hours to fully charge the battery.

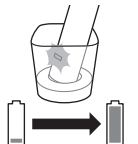

This charger is designed to properly charge only one handle at a time. This charger is not compatible with other models of Sonicare.

Using your Philips Sonicare

Brushing instructions

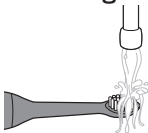

- 1 Wet the bristles.



- 2 Apply a small amount of toothpaste on the bristles.

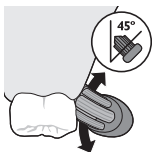

- 3 Place the toothbrush bristles against the teeth at a slight angle (45 degrees), pressing firmly to make the bristles reach the gumline or slightly beneath the gumline.

Note: Keep the center of the brush in contact with the teeth at all times.

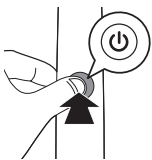

- 4 Press the power on/off and mode button to turn on your Philips Sonicare.



- 5 Gently keep the bristles placed on the teeth and in the gumline. Brush your teeth with small back and forth motion so the bristles reach between the teeth.

Note: The bristles should slightly flare. Do not scrub.



- To clean the inside surfaces of the front teeth, tilt the brush handle semi-upright and make several vertical overlapping brushing strokes on each tooth.



- Begin brushing in section 1 (outside top teeth) and brush for 30 seconds (45 seconds in Deep Clean mode) before moving to section 2 (inside top teeth). Continue brushing in section 3 (outside bottom teeth) and brush for 30 seconds (45 seconds in Deep Clean mode) before moving to section 4 (inside bottom teeth).

Note: To make sure you brush evenly throughout the mouth, divide your mouth into 4 sections using the Quadpacer feature (see chapter 'Features').

Note: After you have completed the brushing cycle, you can spend additional time brushing the chewing surfaces of your teeth and areas where staining occurs. You can also brush your tongue, with the toothbrush turned on or off, as you prefer.

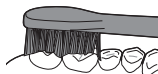

Your Philips Sonicare is safe to use on:

- Braces (brush heads wear out sooner when used on braces).
- Dental restorations (fillings, crowns, veneers).

Brushing modes

- To toggle through modes press the on/off button twice in less than 5 seconds.
- To turn off your Philips Sonicare press the on/off button again after 5 seconds.

Your Philips Sonicare comes with the Clean mode activated.

Note: When the Philips Sonicare is used in clinical studies, it must be used in the default 2-minute Clean mode or in the Deep Clean mode with Easy Start turned off.

Clean mode

The ultimate in plaque removal (default mode). Clean mode lasts for 2 minutes and includes four 30 second Quadpacer intervals.

White mode

2 minutes to remove surface stains and 30 seconds to brighten and polish your front teeth.

Sensitive mode

Extra gentle 2 minute mode for sensitive teeth and gums.

Gum Care mode

Complete whole mouth cleaning (2 minutes) plus gentle cleaning for problem areas and along the gumline (1 minute).

Deep Clean mode

Provides an invigorating 3 minutes of alternating cleaning and massaging to deliver an exceptionally clean experience.

Features

Quadpacer



The Quadpacer is an interval timer that has a short beep and pause to remind you to brush the 4 sections of your mouth. Depending on the brushing mode you have selected, the Quadpacer beeps at different intervals during the brushing cycle. The Quadpacer works in all 5 modes.

Smartimer

The Smartimer indicates that your brushing cycle is complete by automatically turning off the toothbrush at the end of the brushing cycle.

Dental professionals recommend brushing no less than 2 minutes twice a day.

Easy-start

The Easy-start feature gently increases the power over the first 14 brushings to help you get used to the brushing with the Philips Sonicare. The Easy-start feature only works in Clean and White modes. This Philips Sonicare model comes with the Easy-start feature activated.

Activating or deactivating the Easy-start feature

1 Place the handle in the plugged-in charger.

To activate Easy-start:

Press and hold the power on/off for 2 seconds. You hear 2 beeps to indicate that the Easy-start feature has been activated.

To deactivate Easy-start:

Press and hold the power on/off for 2 seconds. You hear 1 beep to indicate that the Easy-start feature has been deactivated.

Note: Using the Easy-start feature beyond the initial ramp-up period is not recommended and reduces Philips Sonicare effectiveness in removing plaque.

Note: Each of the first 14 brushings must be at least 1 minute in length to properly move through the Easy-start ramp-up cycle.

Traveling with your Philips Sonicare

Charging via wall outlet

- 1 Place the handle in the charging travel case.
- 2 Plug the USB cord into the wall adapter provided and plug into an electrical outlet.
 - The charge indicator flashes green until fully charged.

Charging via USB

- 1 Remove the USB cord from the travel plug and insert the USB plug into an USB port.
 - Only use Philips USB wall adapter and USB cable provided.

Use Only UL Listed devices as an alternate method of charging the toothbrush handle in the travel case (i.e. UL Listed Computer, USB Hub). The charger is not compatible with previous models of Philips Sonicare.

Cleaning

Note: Do not clean the brush head, handle, charging base or USB travel case in the dishwasher. The glass is dishwasher safe.

Toothbrush handle

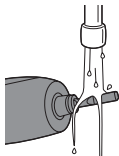

- 1 Remove the brush head and rinse the metal shaft area with warm water. Make sure you remove any residual toothpaste.

Note: Do not push on the rubber seal on the metal shaft with sharp objects, as this may cause damage.

- 2 Wipe the entire surface of the handle with a damp cloth.

Note: Do not use isopropyl rubbing alcohol, vinegar or bleach to clean handle as this may cause discoloration.

Brush head

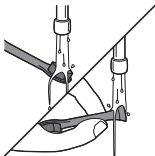

- 1 Rinse the brush head and bristles after each use.
- 2 Remove the brush head from the handle and rinse the brush head connection with warm water at least once a week.

Charging base

Use a damp cloth to wipe the surface of the charging base. Make sure you remove any toothpaste or other residue from the surfaces.

Storage

If you are not going to use your Philips Sonicare for an extended period of time, unplug the charger from the electrical outlet, clean it and store it in a cool and dry place away from direct sunlight.

Replacement

Brush head

Replace Philips Sonicare brush heads every 3 months to achieve optimal results. Use only Philips Sonicare replacement brush heads.

Disposal



This appliance contains a rechargeable battery which must be disposed of properly. Contact your local town or city officials for battery disposal information. You can also call 1-800-8-BATTERY or visit www.rbrc.com for battery drop-off locations. For assistance, visit our website www.philips.com/support or call 1-800-243-3050 toll free.

Removing the rechargeable battery

Warning: Only remove the rechargeable battery when you discard the appliance. Make sure the battery is completely empty when you remove it.

To remove the rechargeable battery, you need a towel or cloth, a hammer and a flat-head (standard) screwdriver. **Observe basic safety precautions when you follow the procedure outlined below. Be sure to protect your eyes, hands, fingers, and the surface on which you work.**

- 1 To deplete the rechargeable battery of any charge, remove the handle from the charger, turn on the Philips Sonicare and let it run until it stops. Repeat this step until you can no longer turn on the Philips Sonicare.
- 2 Remove and discard the brush head. Cover the entire handle with a towel or cloth.

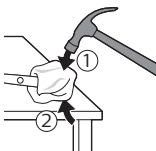

- 3 Hold the top of the handle with one hand and strike the handle housing 0.5 inch above the bottom end. Strike firmly with a hammer on all 4 sides to eject the end cap.

Note: You may have to hit on the end several times to break the internal snap connections.

- 4 Remove the end cap from the toothbrush handle. If the end cap does not release easily from the housing, repeat step 3 until the end cap is released.

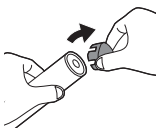

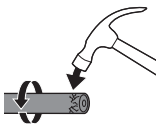

- 5 Holding the handle upside down, press the shaft down on a hard surface. If the internal components do not easily release from the housing, repeat step 3 until the internal components are released.

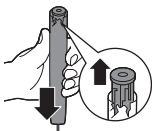

- 6 Remove the rubber battery cover.

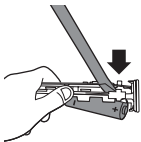

- 7 Wedge the screwdriver between the battery and the black frame at the bottom of the internal components. Then pry the screwdriver away from the battery to break the bottom of the black frame.

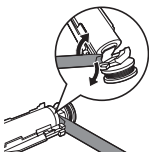

- 8 Insert the screwdriver between the bottom of the battery and the black frame to break the metal tab connecting the battery to the green printed circuit board. This will release the bottom end of the battery from the frame.

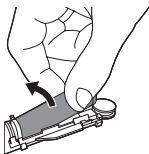

- 9 Grab the battery and pull it away from the internal components to break the second metal battery tab.

Caution: Be aware of the sharp edges of the battery tabs so as to avoid injury to your fingers.

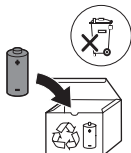

- 10 Cover the battery contacts with tape to prevent any electrical short from residual battery charge. The rechargeable battery can now be recycled and the rest of the product discarded appropriately.

Warranty and support

Philips warrants its products for two years after the date of purchase. Defects due to faulty materials and workmanship will be repaired or replaced at Philips' expense provided that convincing proof of purchase in the qualifying period is provided. Philips recommends use of genuine Sonicare brush heads for optimal performance. Use of other brush heads may damage your Sonicare toothbrush and limit your warranty protection.

Contact our Consumer Care Center at 1-800-682-7664 (North America), outside North America contact your local Philips Consumer Care Center. Internet information: **www.sonicare.com** (North America) or **www.philips.com/support** (outside North America).

WARRANTY EXCLUSIONS

What is not covered under warranty:

- Brush heads.
- Damage caused by use of unauthorized replacement parts or unauthorized brush heads.
- Damage caused by misuse, abuse, neglect, alterations or unauthorized repair.
- Normal wear and tear, including chips, scratches, abrasions, discoloration or fading.

IMPLIED WARRANTIES

ANY IMPLIED WARRANTIES, INCLUDING IMPLIED WARRANTIES OF MERCHANTABILITY AND FITNESS FOR A PARTICULAR PURPOSE, SHALL BE LIMITED TO THE DURATION OF THE EXPRESS WARRANTIES SET FORTH ABOVE. IN SOME STATES LIMITATIONS ON DURATION OF IMPLIED WARRANTIES DO NOT APPLY.

LIMITATION OF REMEDIES

IN NO EVENT SHALL PHILIPS OR ANY OF ITS AFFILIATED OR SUBSIDIARY COMPANIES BE LIABLE FOR ANY SPECIAL, INCIDENTAL OR CONSEQUENTIAL DAMAGES BASED UPON BREACH OF WARRANTY, BREACH OF CONTRACT, NEGLIGENCE, TORT, OR ANY OTHER LEGAL THEORY. SUCH DAMAGES INCLUDE, WITHOUT LIMITATION, LOSS OF SAVINGS OR REVENUE; LOSS OF PROFIT; LOSS OF USE; THE CLAIMS OF THIRD PARTIES INCLUDING, WITHOUT LIMITATION, DENTISTS AND DENTAL HYGIENISTS; AND COST OF ANY SUBSTITUTE EQUIPMENT OR SERVICES. SOME STATES DO NOT ALLOW THE EXCLUSION OR LIMITATION OF INCIDENTAL OR CONSEQUENTIAL DAMAGES.



www.philips.com/Sonicare

©2016 Koninklijke Philips N.V. (KPNV). All rights reserved.
Philips and the Philips shield are trademarks of KPNV.
Sonicare and the Sonicare logo are trademarks
of Philips Oral Healthcare, LLC and/or KPNV.



>75% recycled paper

4235.021.1516.1