

## GCX Mounting Assembly Installation Guide

### Channel for Dräger Apollo/Primus/Primus IE/Julian Accessory Track



The purpose of these instructions is to:

1. Describe attachment of the channels to the Dräger Accessory Track.

#### 7" Channel Installation

**Note:** Refer to pictures above for correct orientation of the channel(s)

1. Locate the top T-Nut/Shim and remove the 10-32 x 3/4" FHMS then loosen the 10-32 x 3/4" PHMS. Remove the T-Nut/Shim from the Channel, slide into the Accessory Track and position (lightly tighten the 10-32 x 3/4" PHMS to hold in place).
2. Locate the bottom T-Nut/Shim attached to the Channel and loosen the 10-32 x 3/4" FHMS and the 10-32 x 3/4" PHMS. Align the bottom T-Nut/Shim to slide into the Accessory Track and position (up to where the top T-Nut-Shim was placed in Step 1).
3. Loosen the 10-32 x 3/4" PHMS holding the top T-Nut/Shim in place and slide down to fit into the Channel. Replace and secure the 10-32 x 3/4" FHMS removed in Step 1. Secure all fasteners.

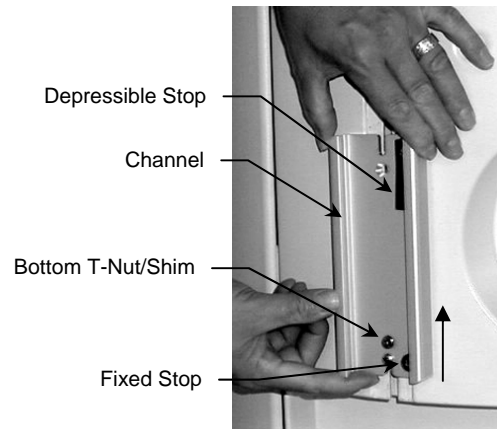
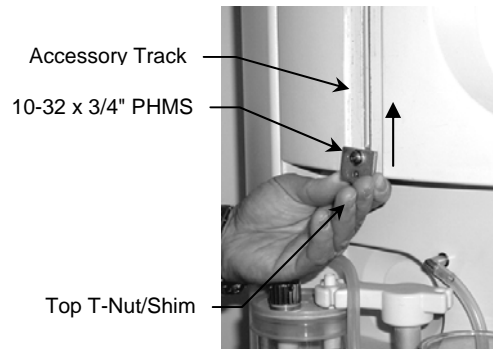

## 13" Channel Installation

**Note:** Refer to pictures at the beginning of this document for correct orientation of the channel(s)

1. Locate the top T-Nut/Shim and remove the 10-32 x 3/4" FHMS then loosen the 10-32 x 3/4" PHMS. Remove the T-Nut/Shim for the Channel, slide into the Accessory Track and position.

Locate the bottom T-Nut/Shim and remove the 10-32 x 3/4" FHMS then loosen the 10-32 x 3/4" PHMS. Remove from Channel to use in Step 3 below.

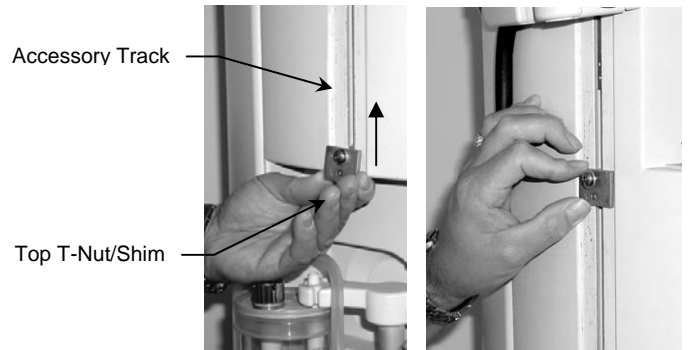

2. Position the Channel, slide the T-Nut/Shim into the slot at the top of the Channel. Replace the the 10-32 x 3/4" FHMS and secure both fasteners.

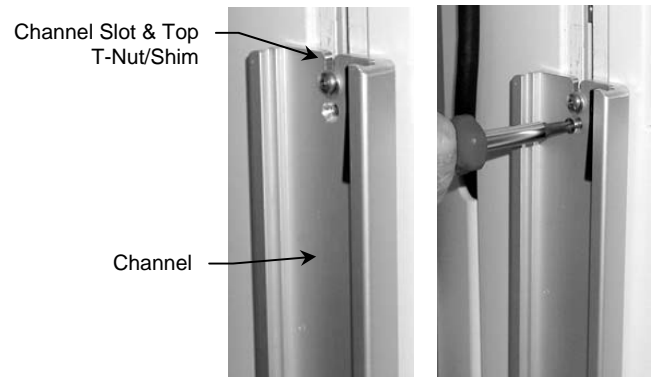

3. Slide bottom T-Nut/Shim removed in Step 1 into Accessory Track. Slide the T-Nut/Shim into the slot at the bottom of the Channel. Replace the the 10-32 x 3/4" FHMS and secure both fasteners.

